

# Assembly Instructions

**FUTON**  
C O M P A N Y

## Oak Linear Nest of Tables

ROPO no:

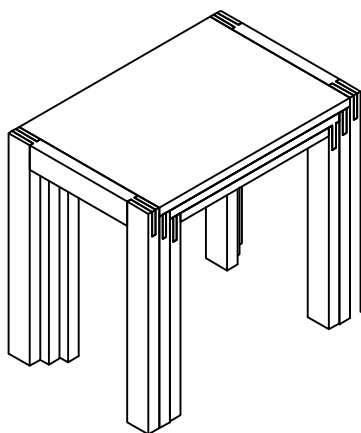

PLEASE READ THESE INSTRUCTIONS VERY CAREFULLY BEFORE YOU BEGIN, TO ENSURE THAT YOUR FUTON COMPANY PRODUCT WILL GIVE YOU MANY YEARS OF SATISFACTION

Thank you for buying a Futon Company product.

We are constantly striving to improve everything we do, but occasionally mistakes do occur. In the unlikely event that you find any part missing, please call your nearest Futon Company store and we will arrange for the despatch of an immediate replacement. Please keep all packaging until you have checked every part and assembly of your Futon Company product is complete.

Version number: 1    Product code: T3 LINEAR NEST OAK    Date: 05/01/25

*experts in small space living*



## Parts Checklist

Please count and check every component very carefully before you begin

### Large Table

- ① Left Leg x 1
- ② Right Leg x 1
- ③ Top x 1
- ④ Back Rail x 1

### Large Table

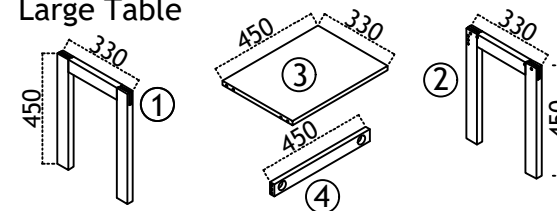

### Medium Table

- ⑤ Left Leg x 1
- ⑥ Right Leg x 1
- ⑦ Top x 1
- ⑧ Back Rail x 1

### Medium Table

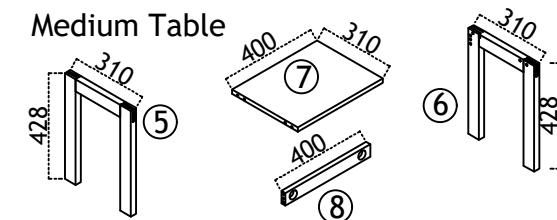

### Small Table

- ⑨ Left Leg x 1
- ⑩ Right Leg x 1
- ⑪ Top x 1
- ⑫ Back Rail x 1

### Small Table

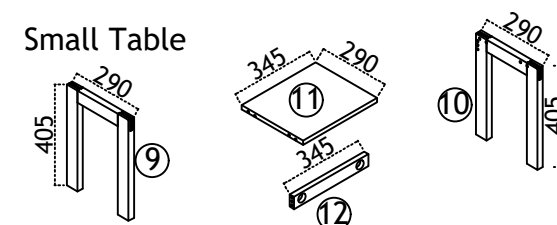

## Fittings Checklist

Please count and check every component very carefully before you begin



- ① Wooden Dowel x 24    ② Bolt x 18    ③ Nut x 18    ④ Pressure Plate x 18



- ⑤ Small Spanner x 1    ⑥ Felt Protector pad x12



## How To Assemble Your Table

Please follow these instructions carefully

To prevent scratching:  
Lay the parts face  
down on a clean, flat,  
soft surface.

Please repeat these steps for each table.

1.

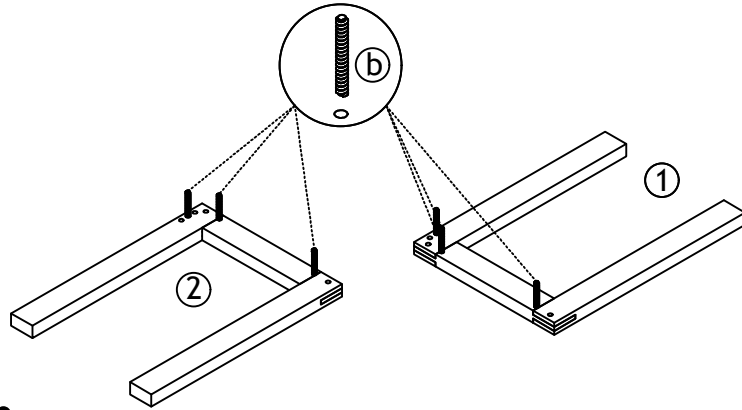

2.

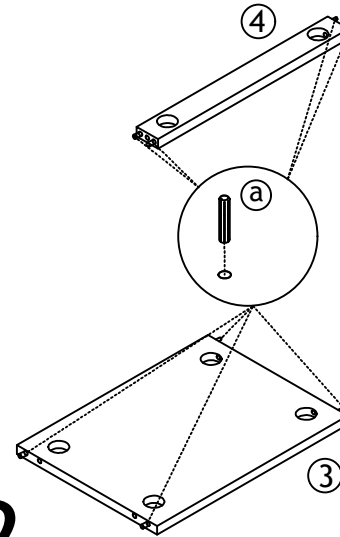

3.

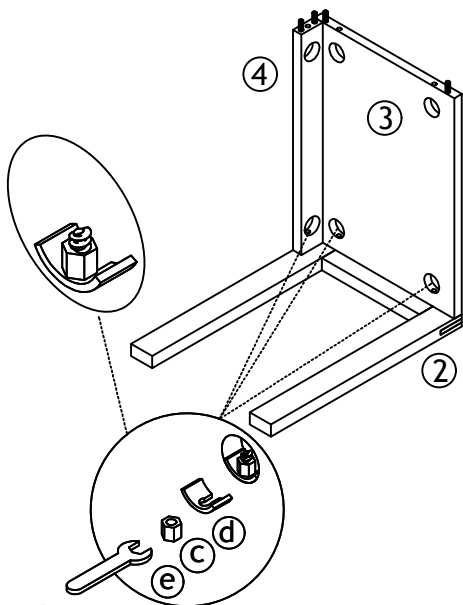

4.

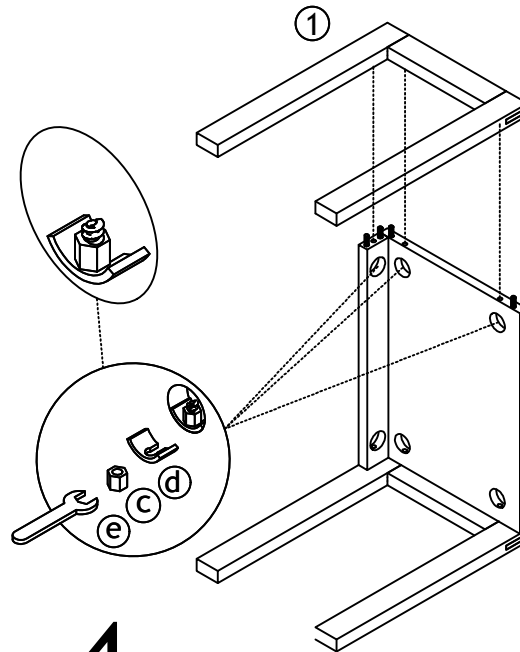

5.

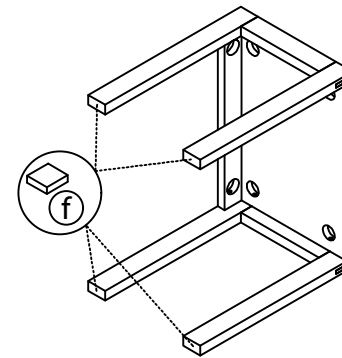

## How To Use

Please read carefully

### FINISH

Your Table is made from solid Oak.

### CARE

To clean your Table, wipe with a damp  
cloth followed by a dry cloth.

### IMPORTANT

To ensure maximum performance from this  
product, we advise that you check and tighten all  
bolts and screws on a regular basis to avoid damage  
and strain to parts.

### GUARANTEE

This instruction leaflet forms part of your  
guarantee. Please retain it. The ROPO number along  
with your invoice number will need to be quoted in  
all correspondence with Futon Company.  
Thank you for choosing Futon Company.

