

Assembly Instructions

FUTON
C O M P A N Y

Abbey Bedside Cabinet

ROPO no:

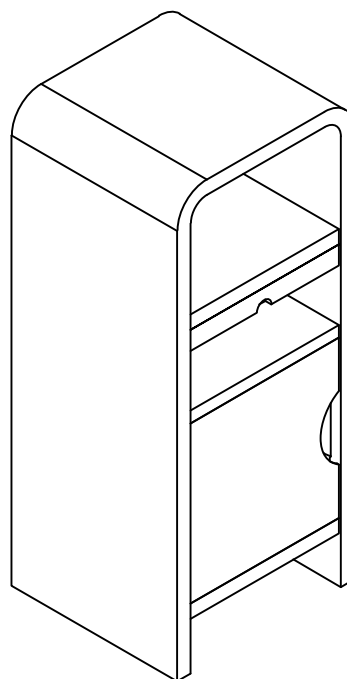
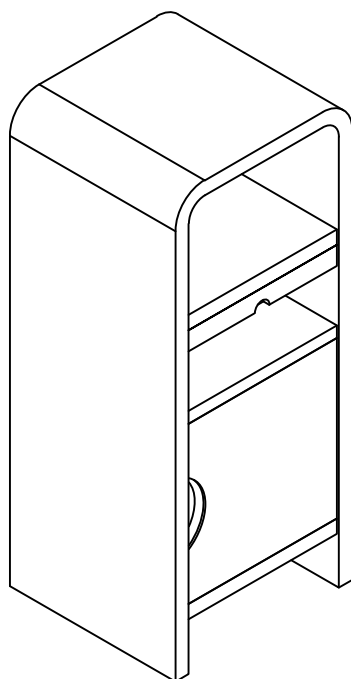

PLEASE READ THESE INSTRUCTIONS VERY CAREFULLY BEFORE YOU BEGIN, TO ENSURE THAT YOUR FUTON COMPANY PRODUCT WILL GIVE YOU MANY YEARS OF SATISFACTION

Thank you for buying Futon Company product

We are constantly striving to improve everything we do, but very occasionally mistakes do occur.

In the unlikely event that you find any part missing please call your nearest Futon Company store and we will arrange for the despatch of an immediate replacement.

Please keep all packaging until you have checked every part and assembly of your Futon Company product is complete.

Version number: 1

Product code: ST CAB ABBEY

Date: 05/01/25

experts in small space living



How To Assemble Your Cabinet

Please follow these instructions carefully

The door can be attached to either side.

1.

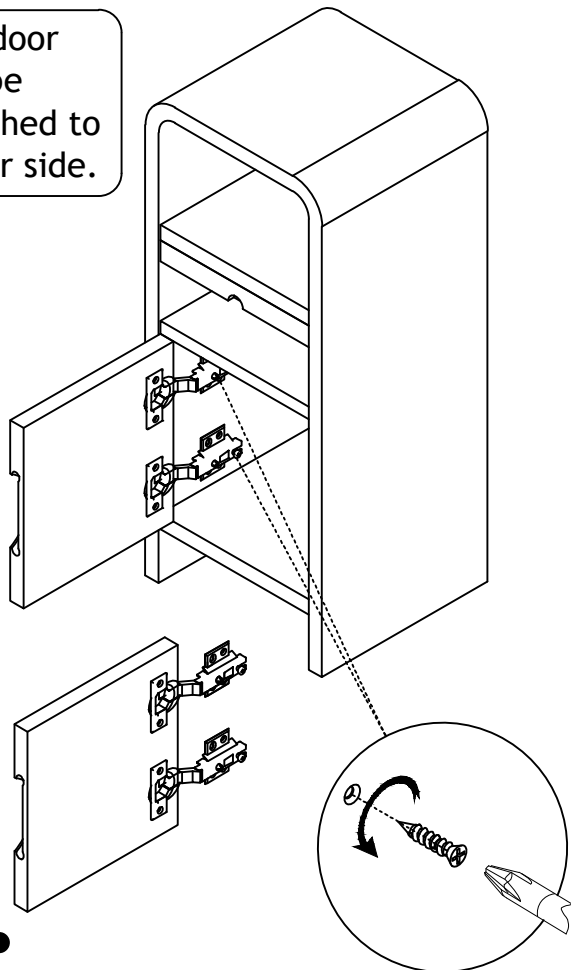

2.

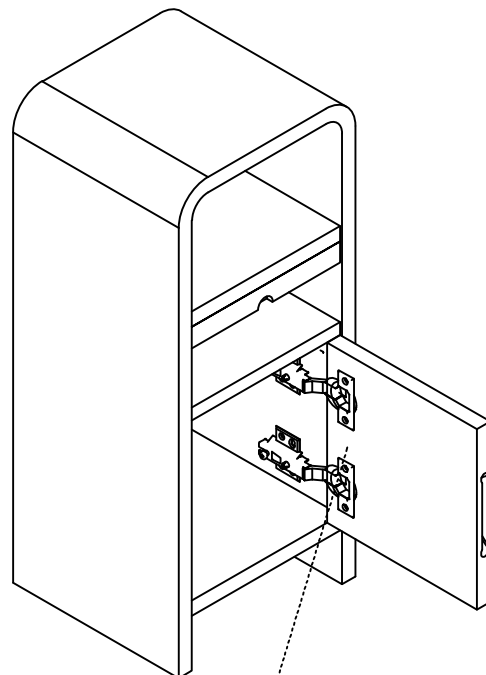

Fix these screws first when attaching doors to cabinet unit.

1.

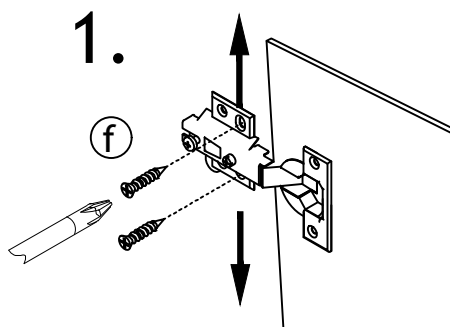

2.

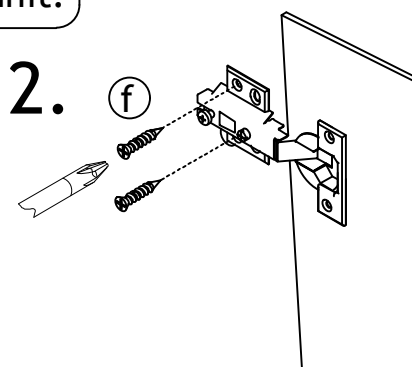

The door can be adjusted right or left by this screw.

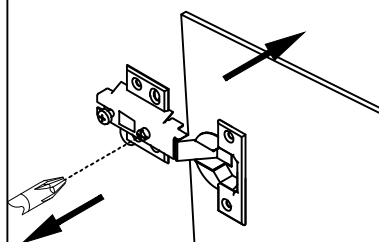

The door can be adjusted front or back by this screw.

