

Assembly Instructions

Suratto Shoe Tower

FUTON
C O M P A N Y

Experts in small space living

ST SURAT TOWER

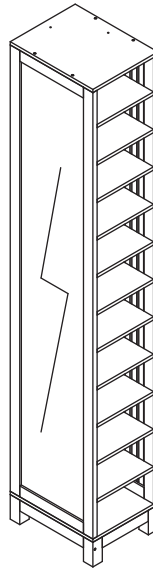

Parts Checklist

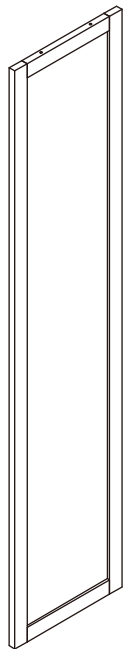

① x1

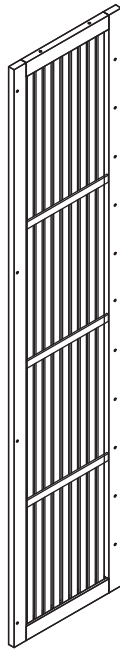

② x1

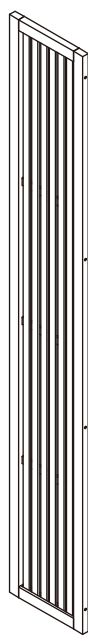

③ x1

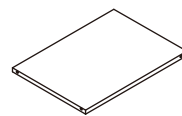

④ x1

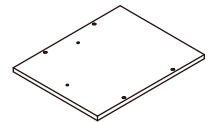

⑤ x1

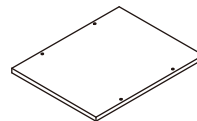

⑥ x1

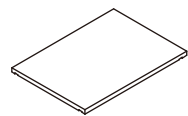

⑦ x10

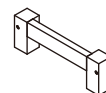

⑧ x2

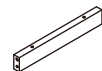

⑨ x2

Fittings Checklist

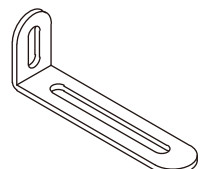
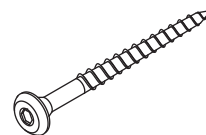
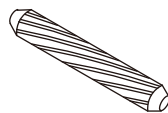
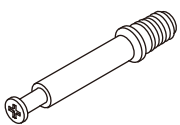

① Cam Screw x12 ② Cam Lock x 12 ③ Wooden dowel x4 ④ Screw x8 ⑤ Wall Bracket x 1

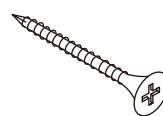
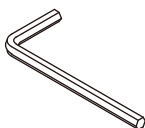

① Screw x1 ② Allen key x1 ③ Support Pin x 40 ④ Screw x1 ⑤ Wall Plug x1 ⑥ Screw x4



Cross head and flat head screwdrivers also required for assembly

To prevent scratching: Lay the parts face down on a clean, flat, soft surface.

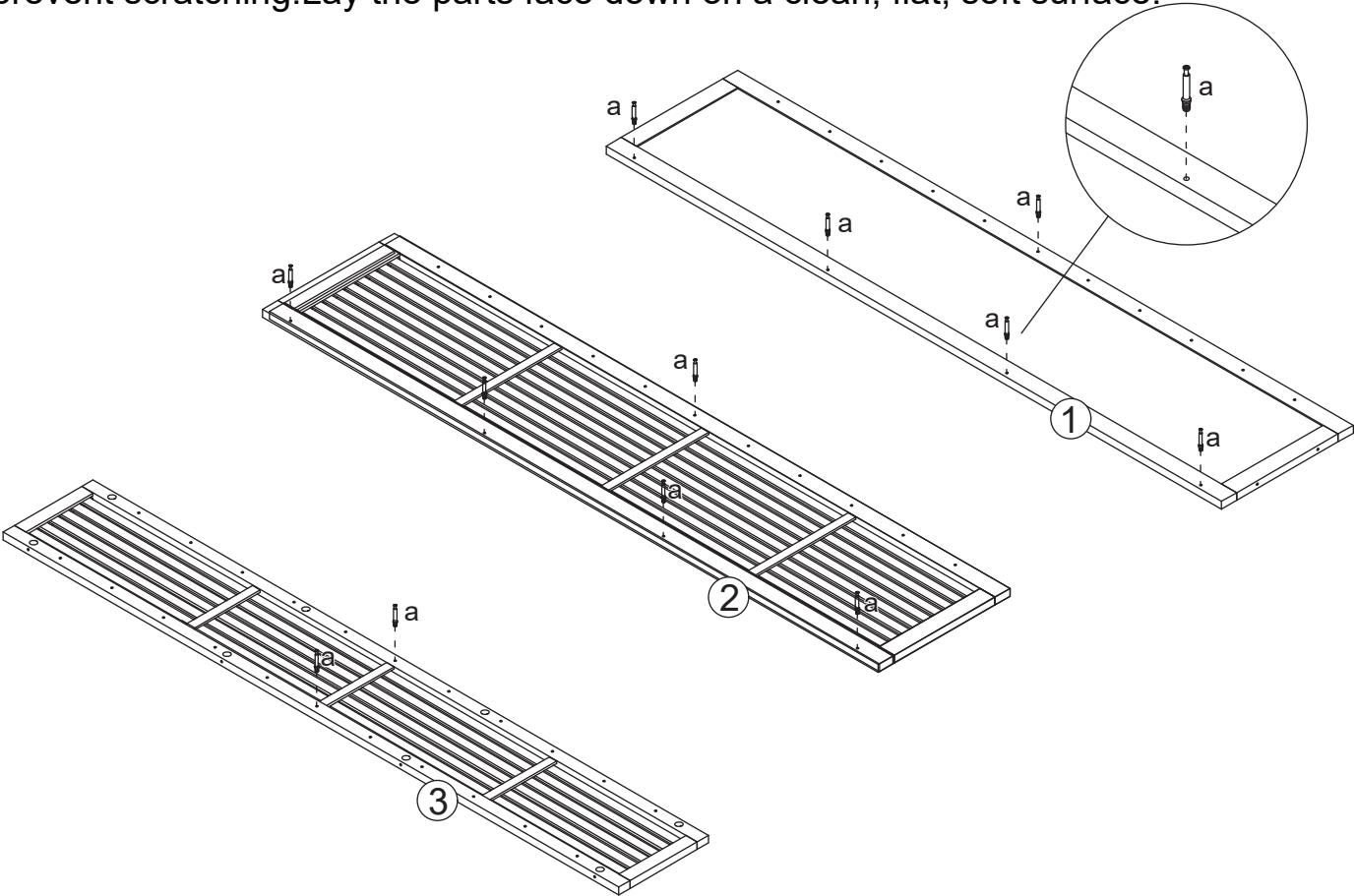

1.

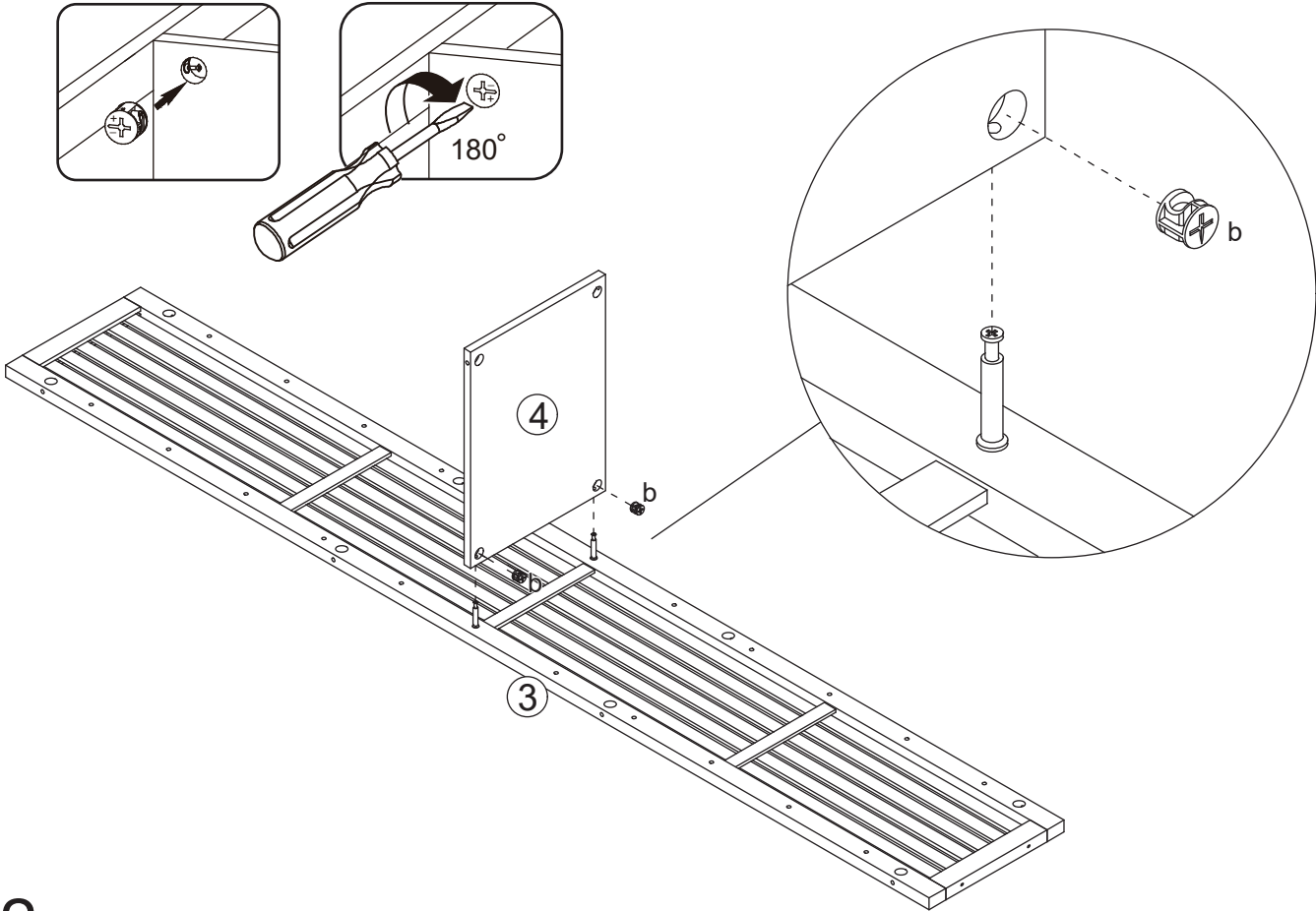

2.

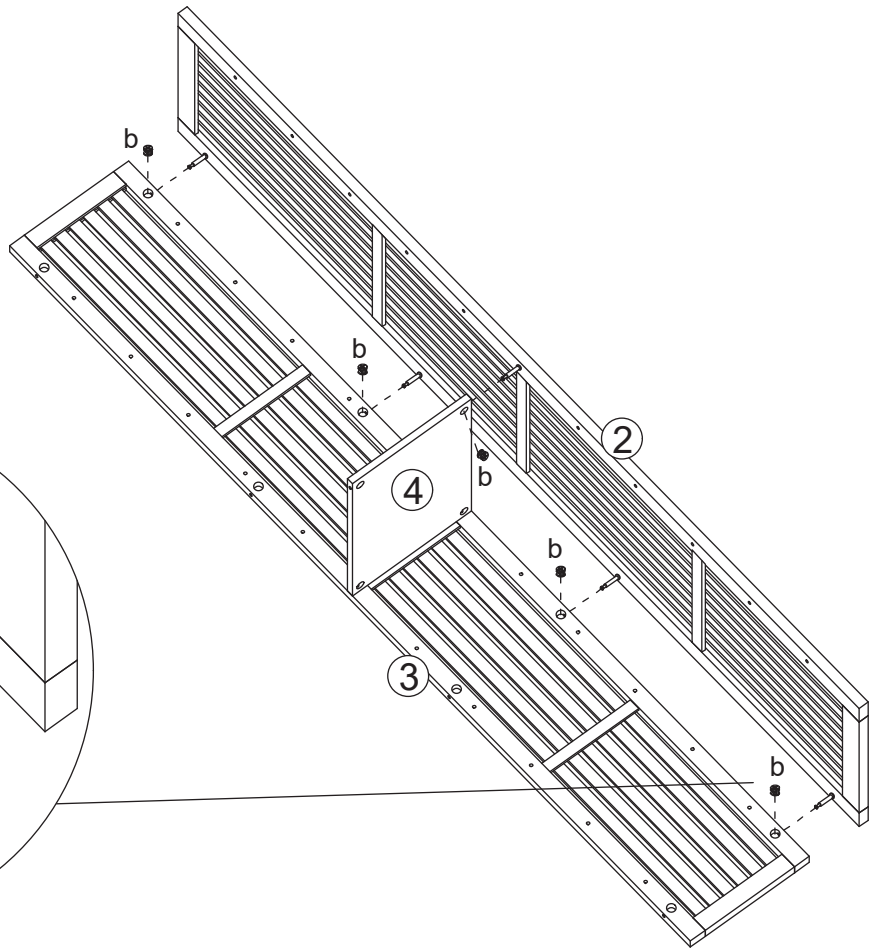
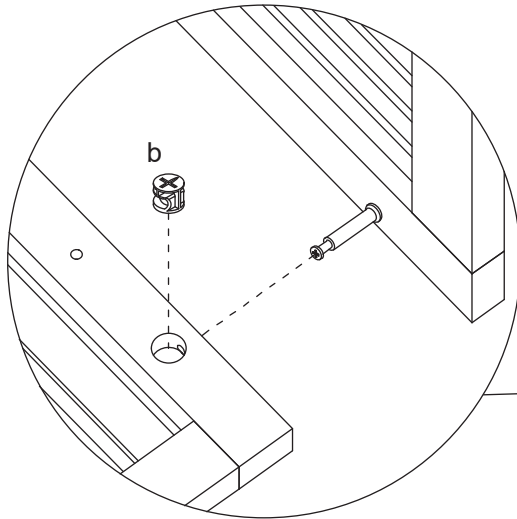
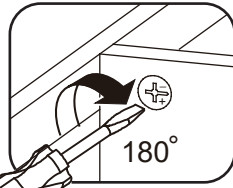
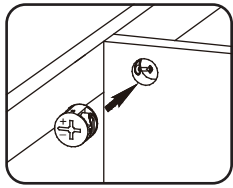

3.

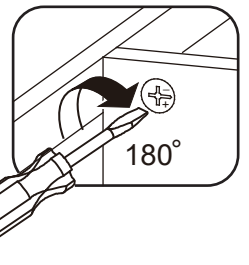
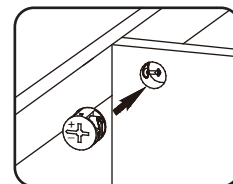
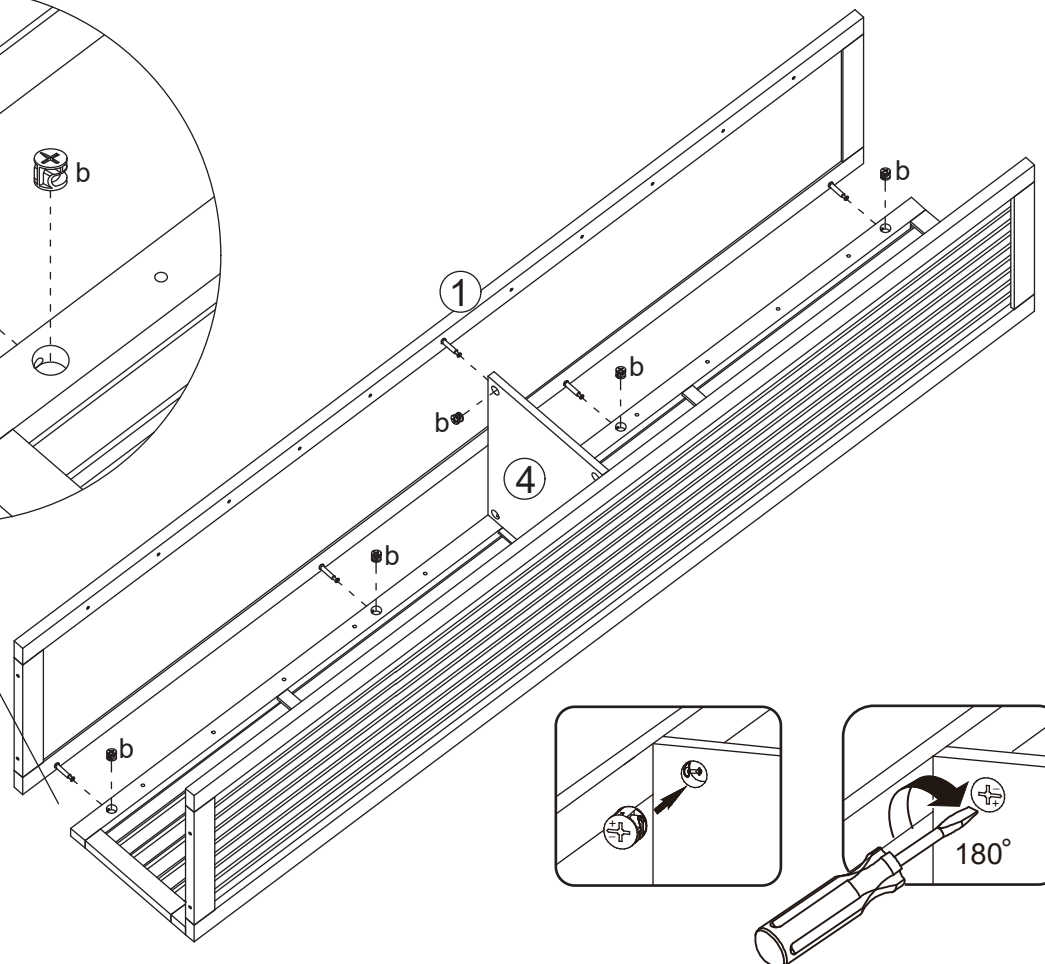
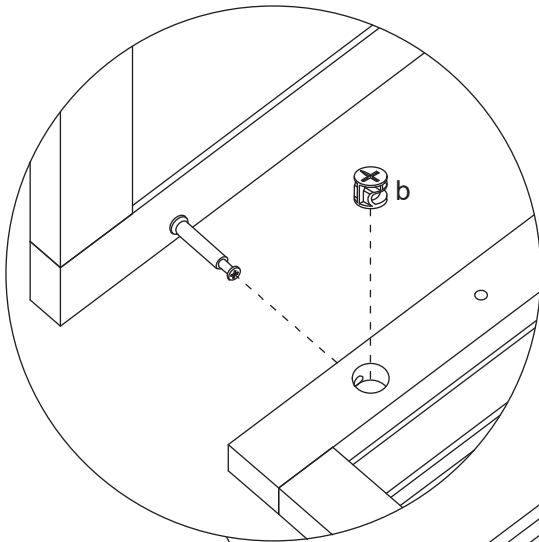

4.

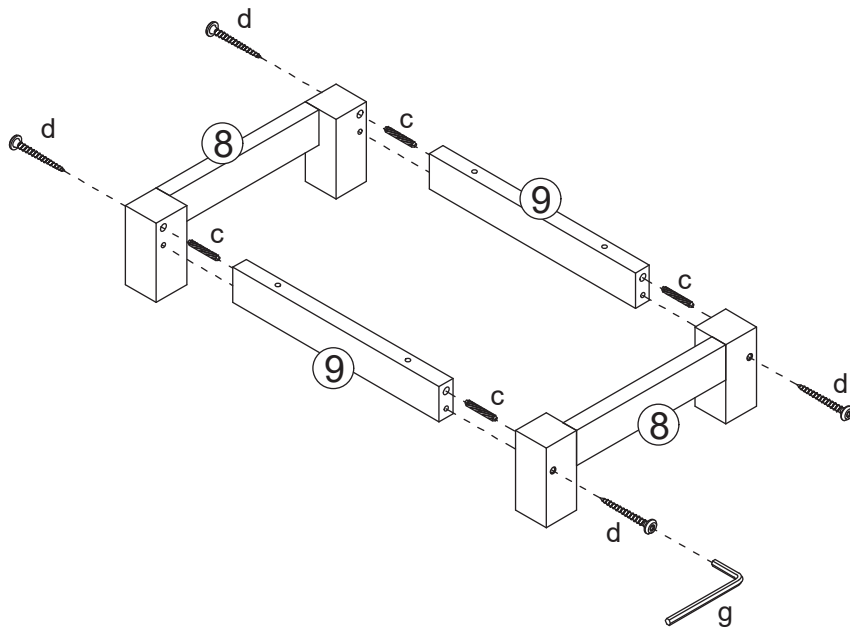

5.

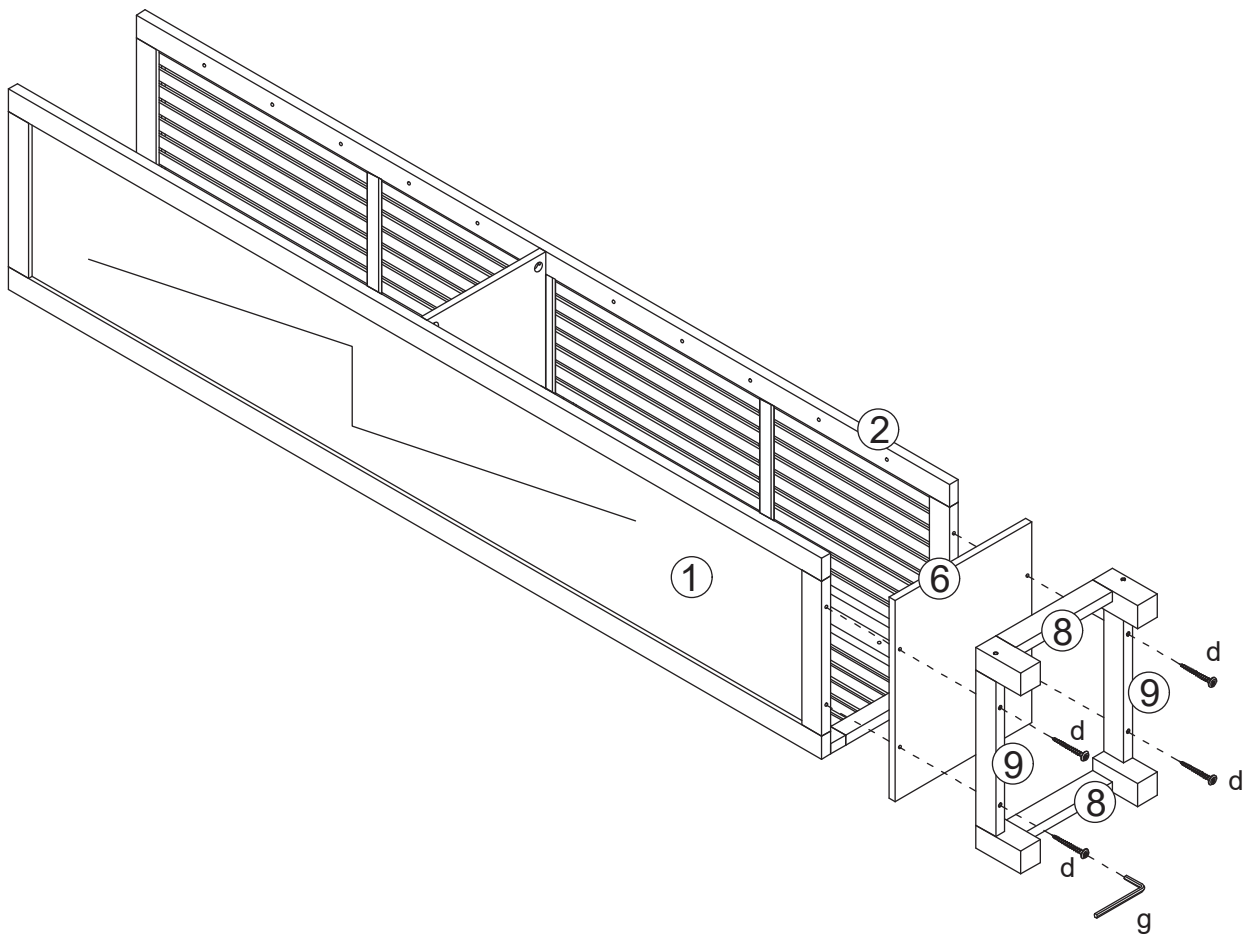

6.

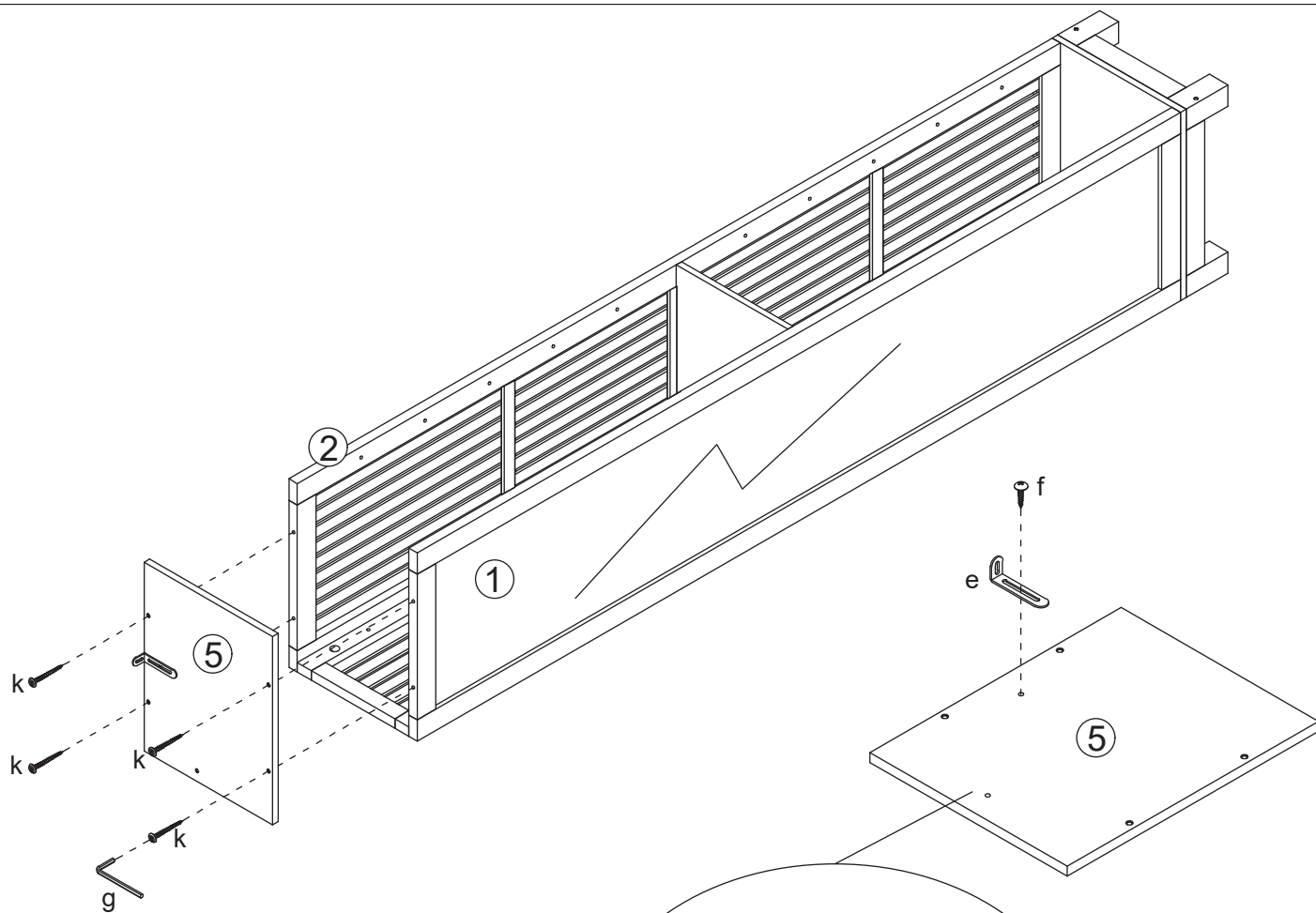

7.

Fitting E should be placed facing the wall your shoe tower will stand by.

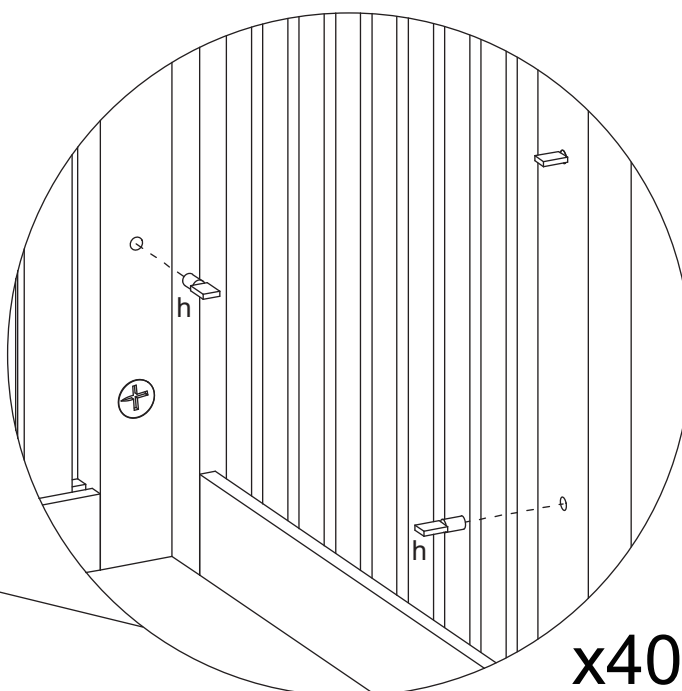

8.

x40

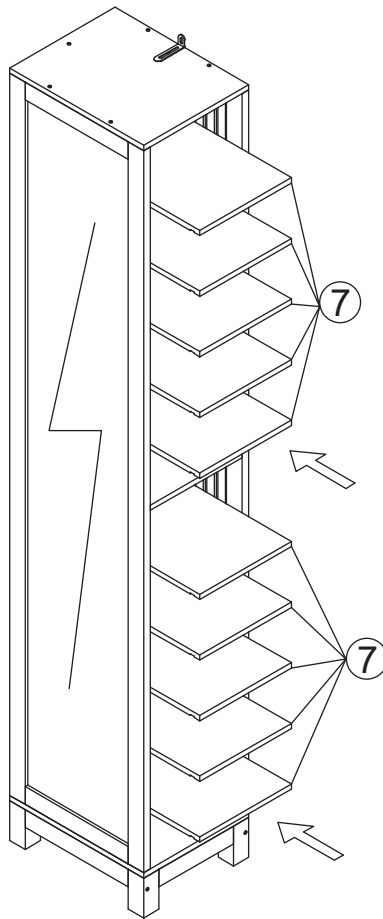

9.

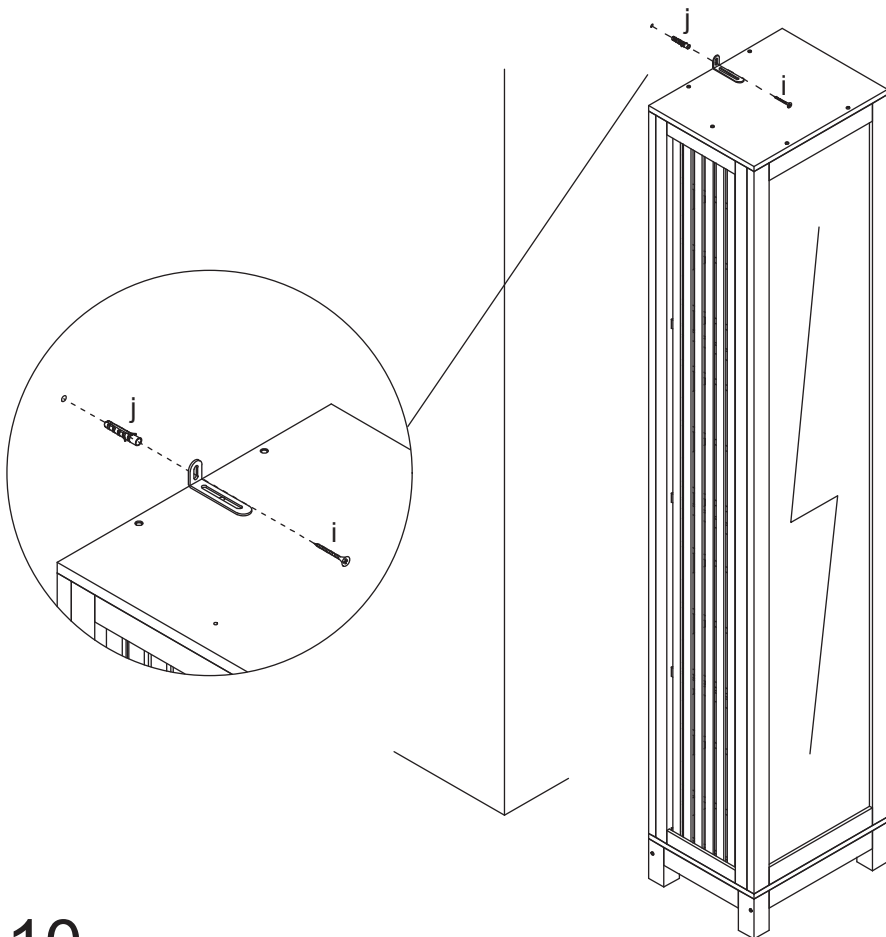

Follow this step to fix your Shoe Tower to the wall. Fixing to secure your Shoe Tower to the wall is standard fitting. For details on suitable fixing for your wall type seek advice from your local specialised hardware store.

For safety reasons, we advise you to fix this item to the wall. Never allow children to climb on furniture.

10.