

# ASSEMBLY INSTRUCTIONS

**FUTON**  
C O M P A N Y

ST BTH HALE TALL CAB

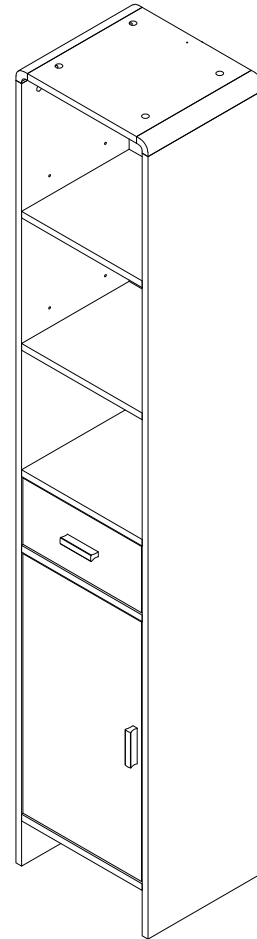
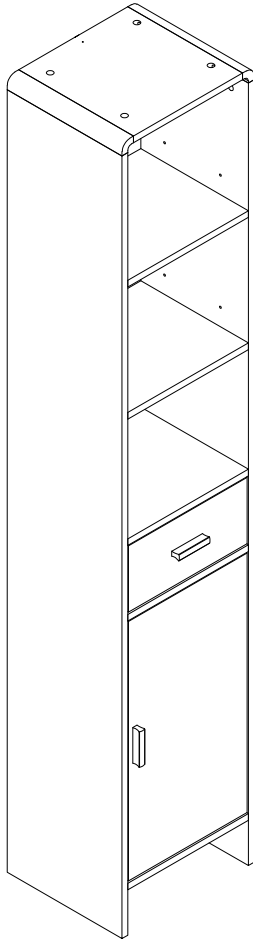

a. To assemble your cabinet with door opening RIGHT follow A instructions.

b. To assemble your cabinet with door opening LEFT follow B instructions.

Fittings Checklist

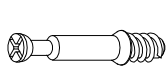

A x22



B x22



C x18

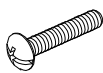

D x4



E x9

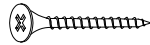

F x4

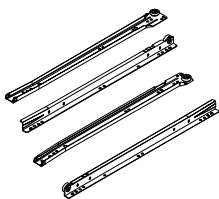

G x1

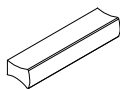

H x2

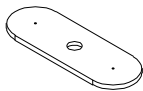

I x1

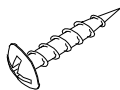

J x2



K x1



L x2



M x1

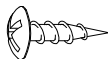

N x1



O x8



P x12

Parts Checklist

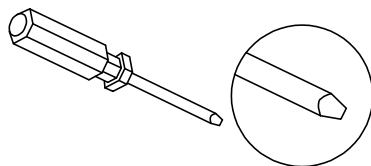
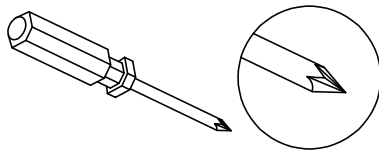
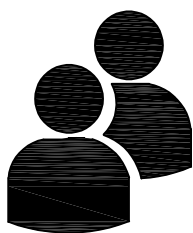
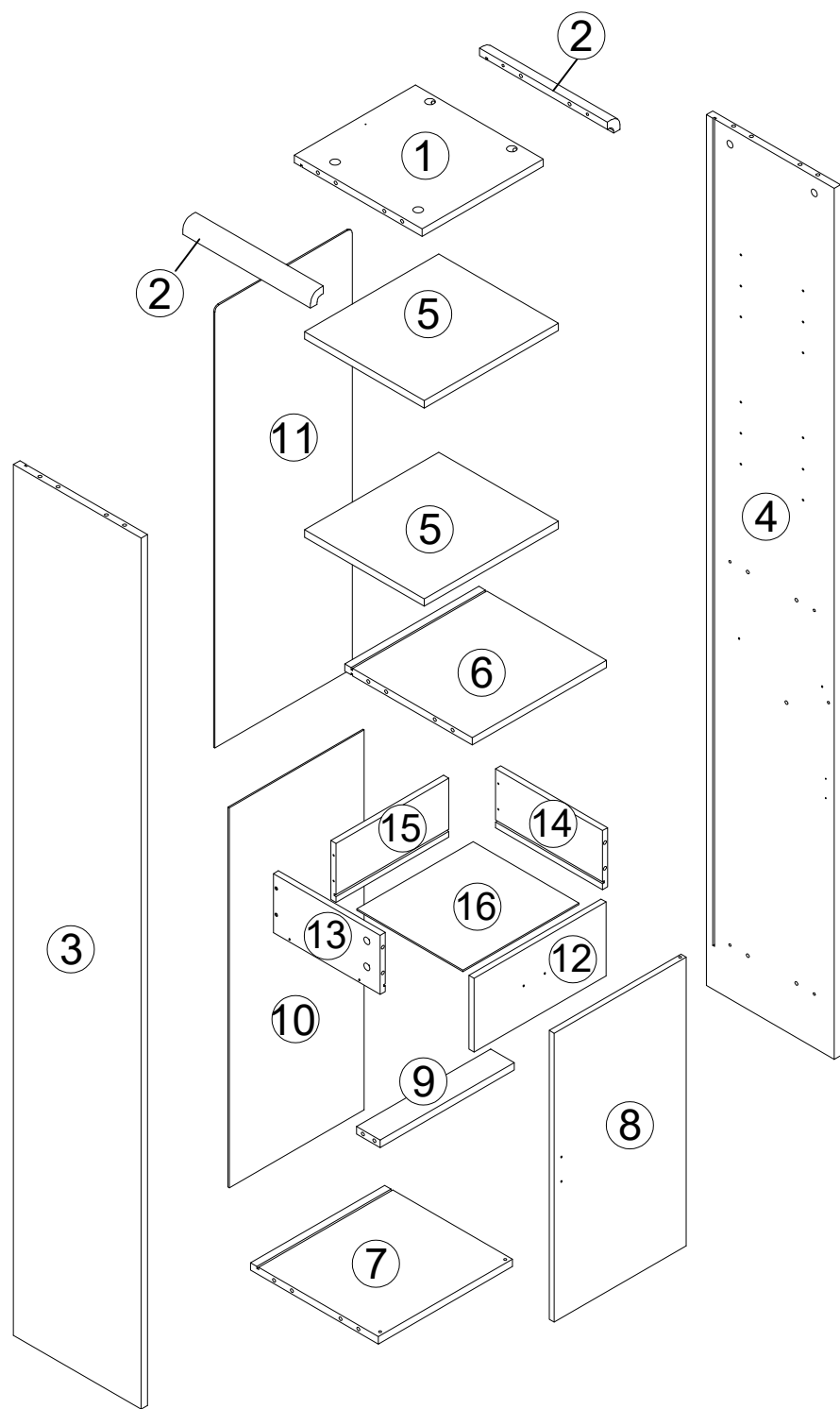

Allow 60 minutes to assemble this item

# 1a. door opening right

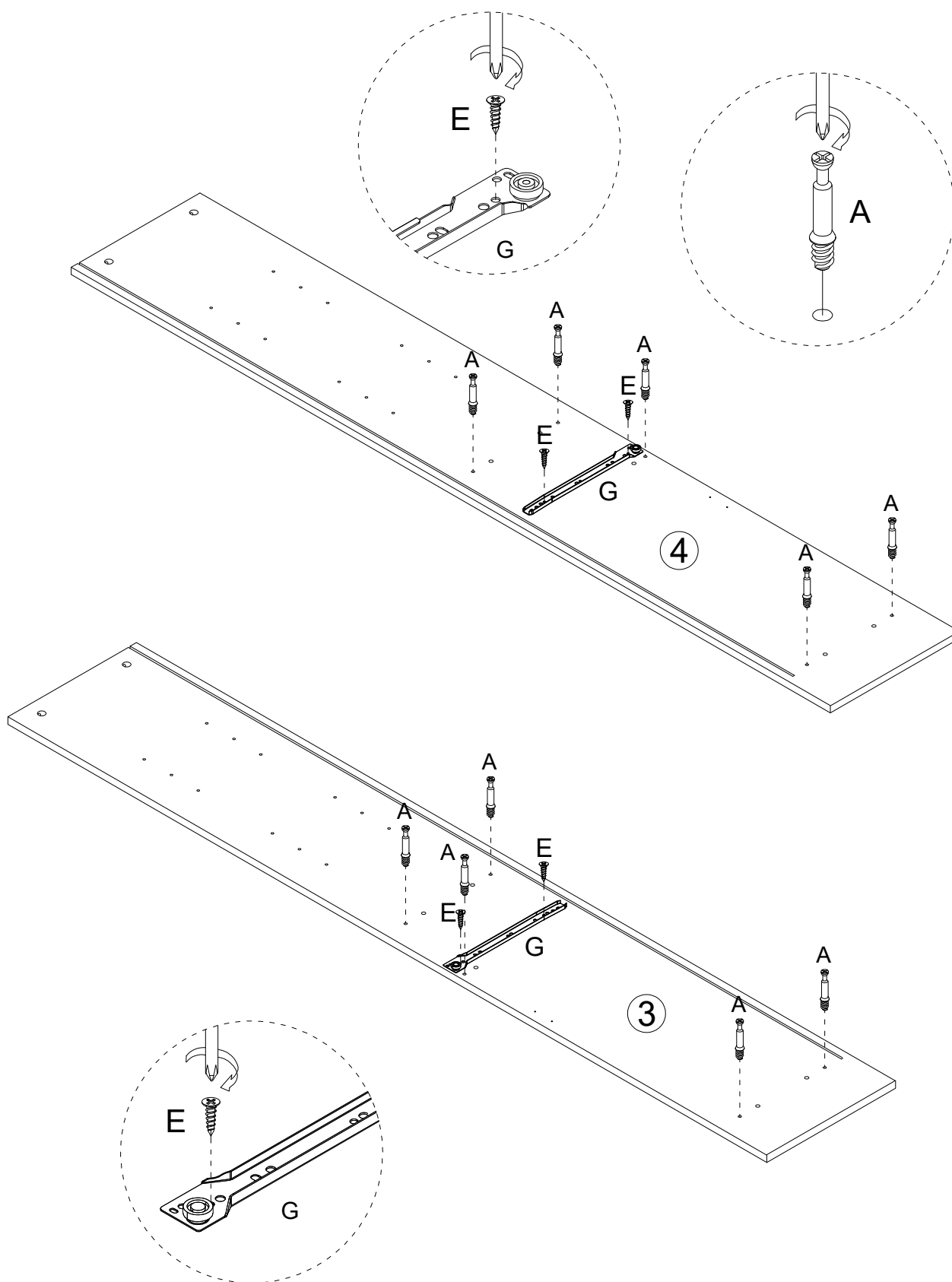

2a.

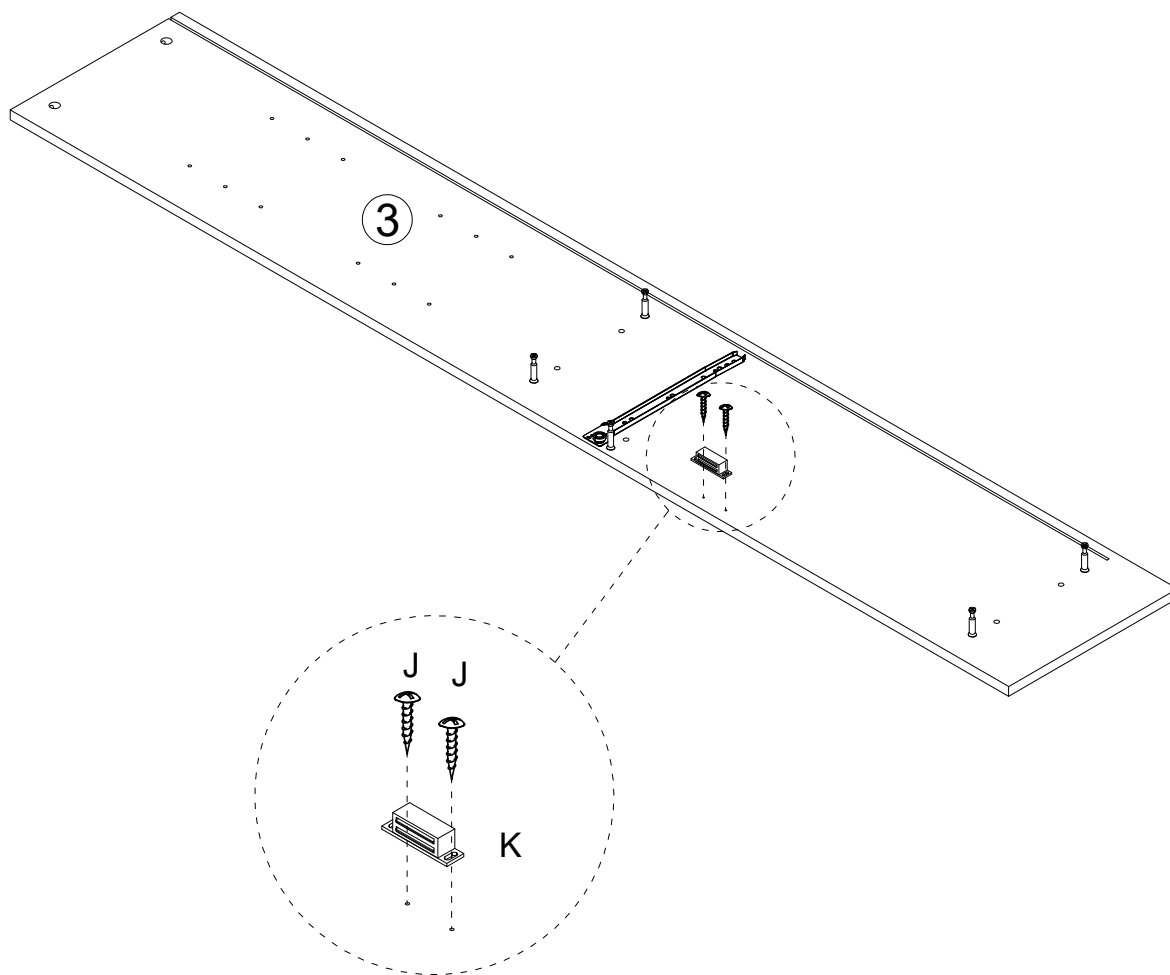

3a.

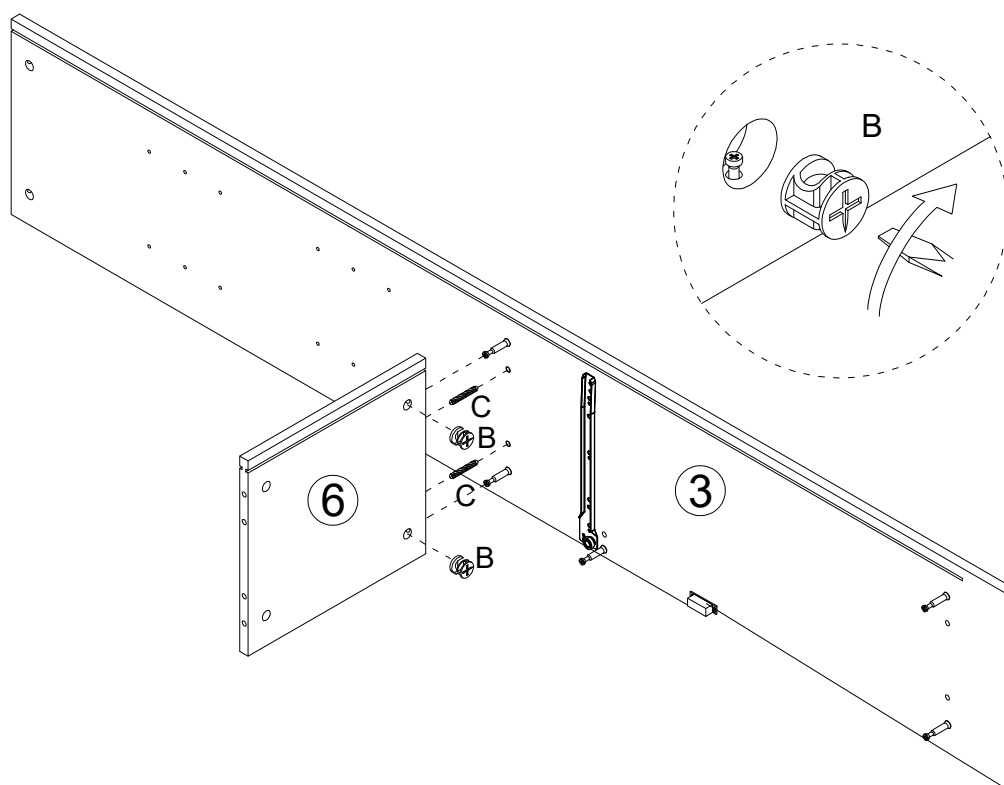

4a.

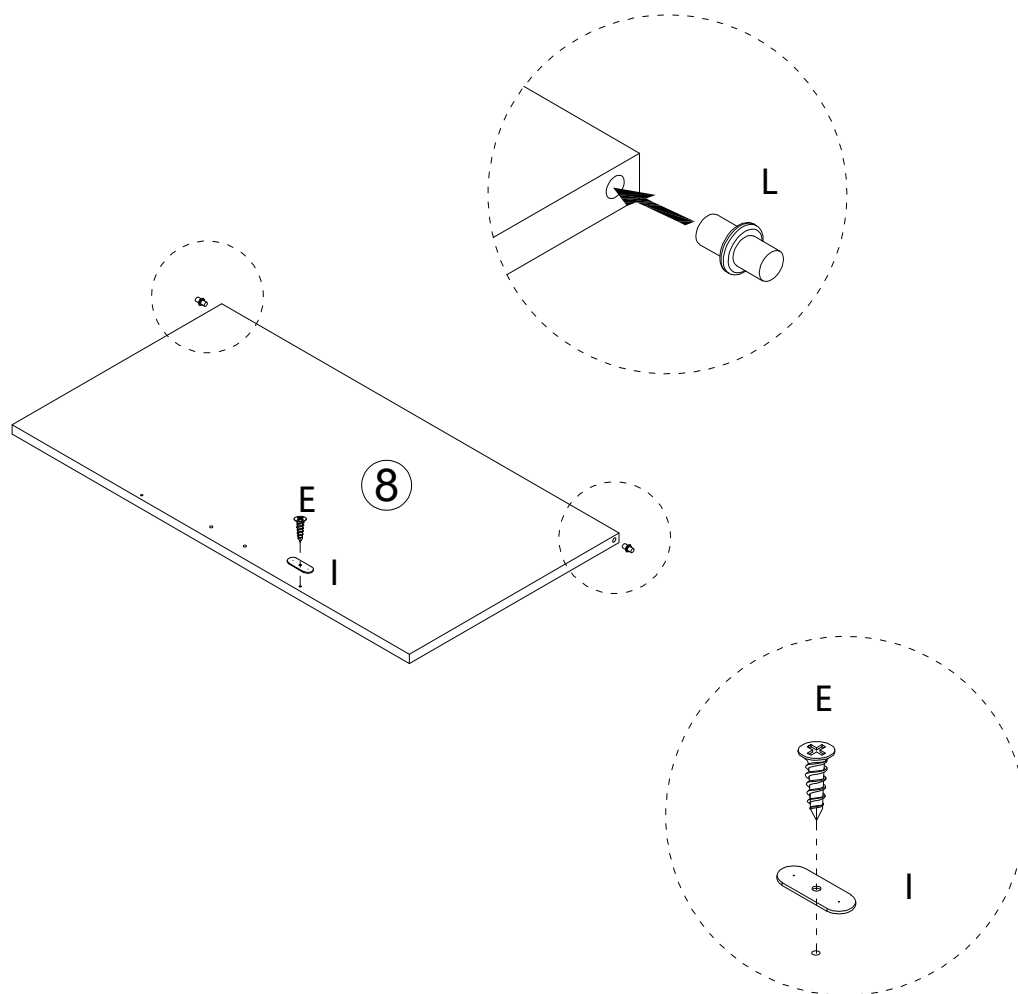

5a.

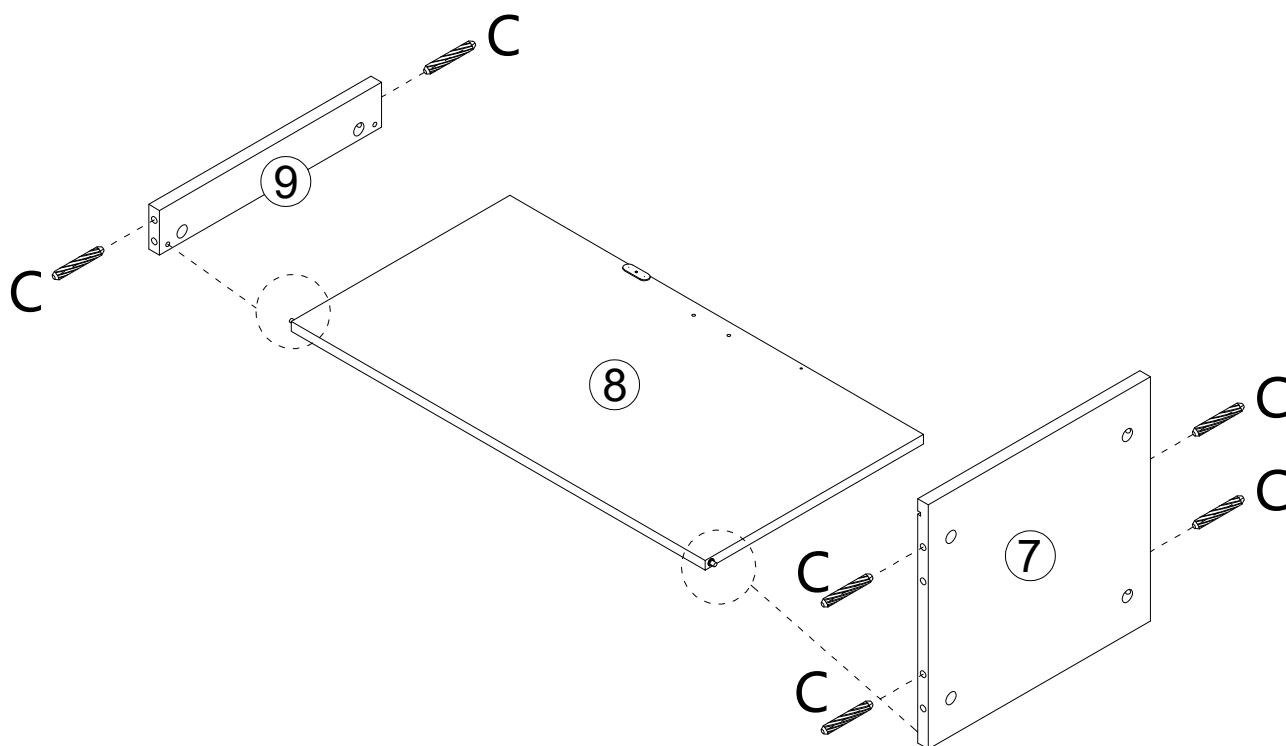

6a.

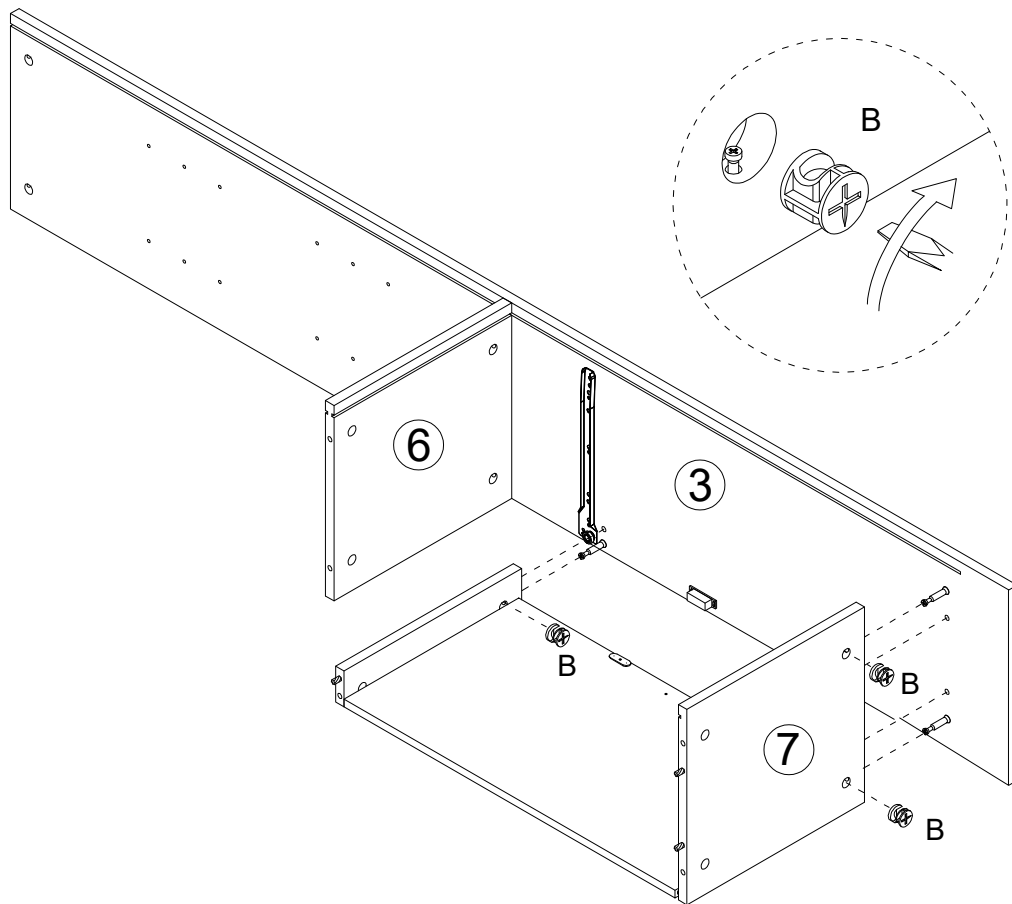

7a.

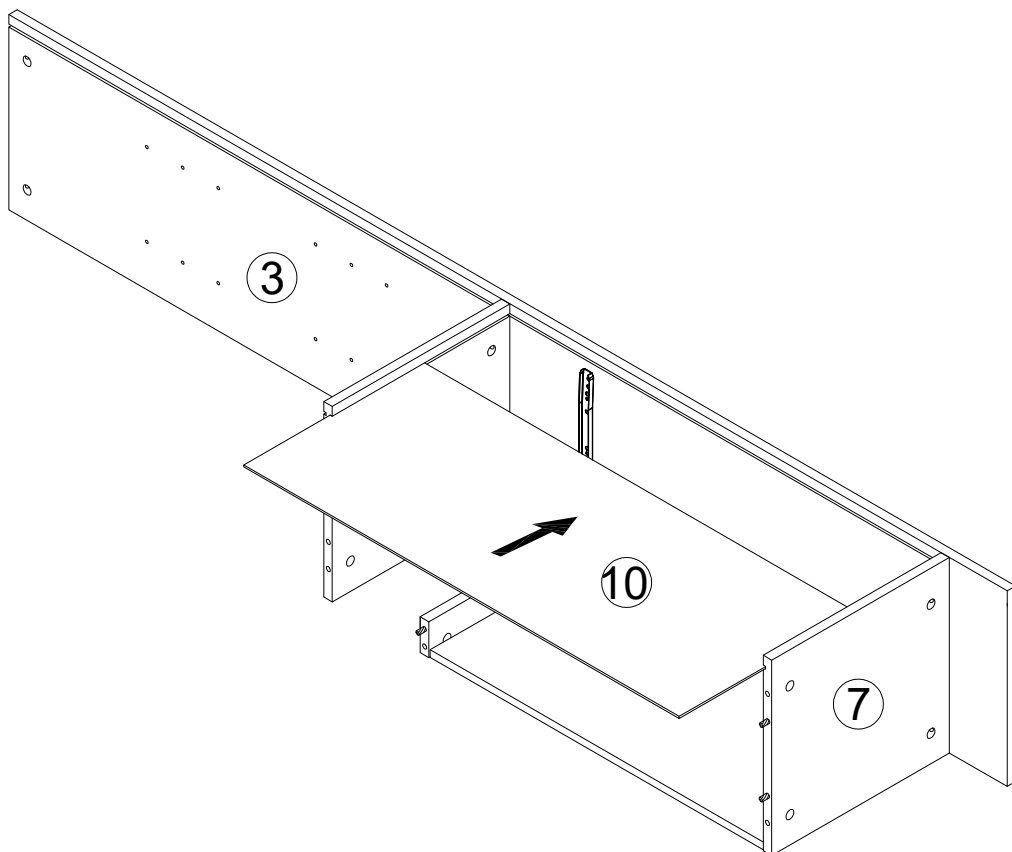

8a.

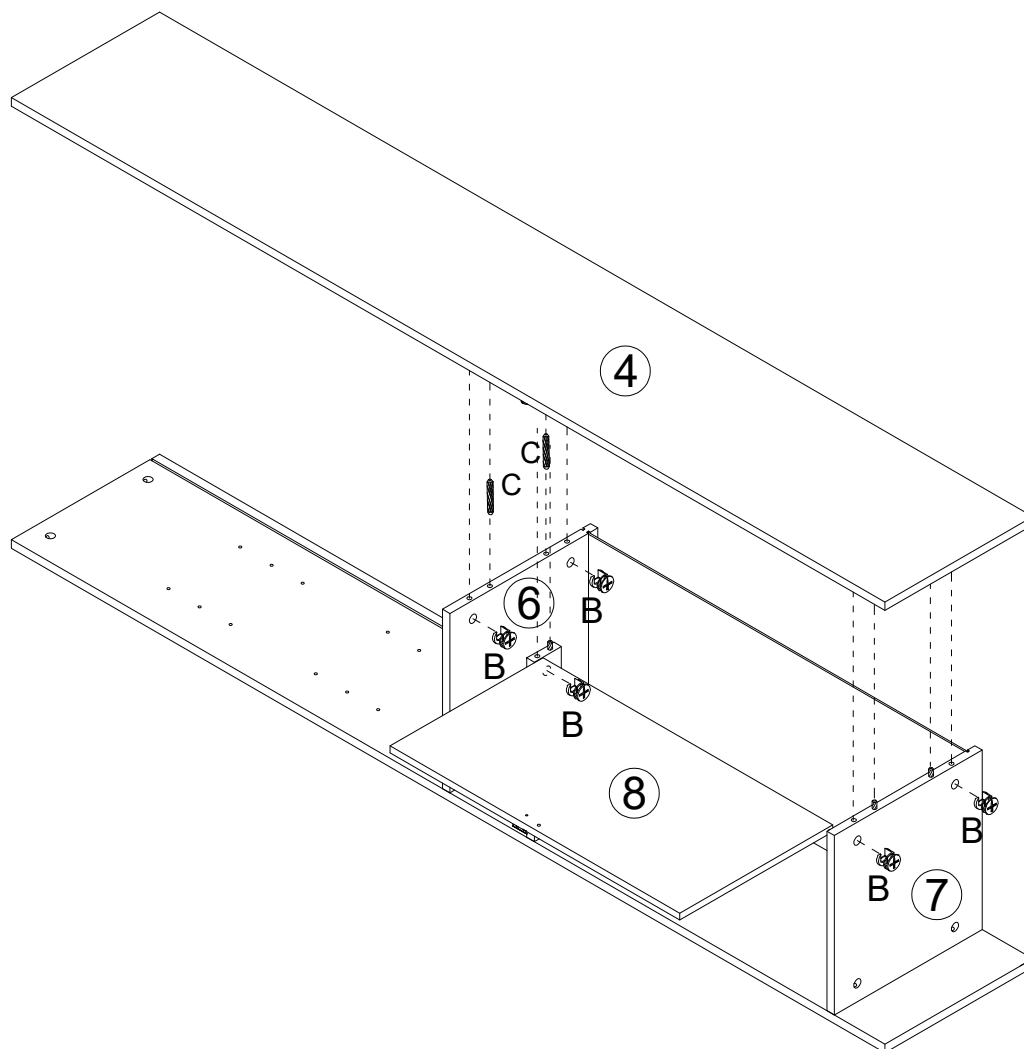

9a.

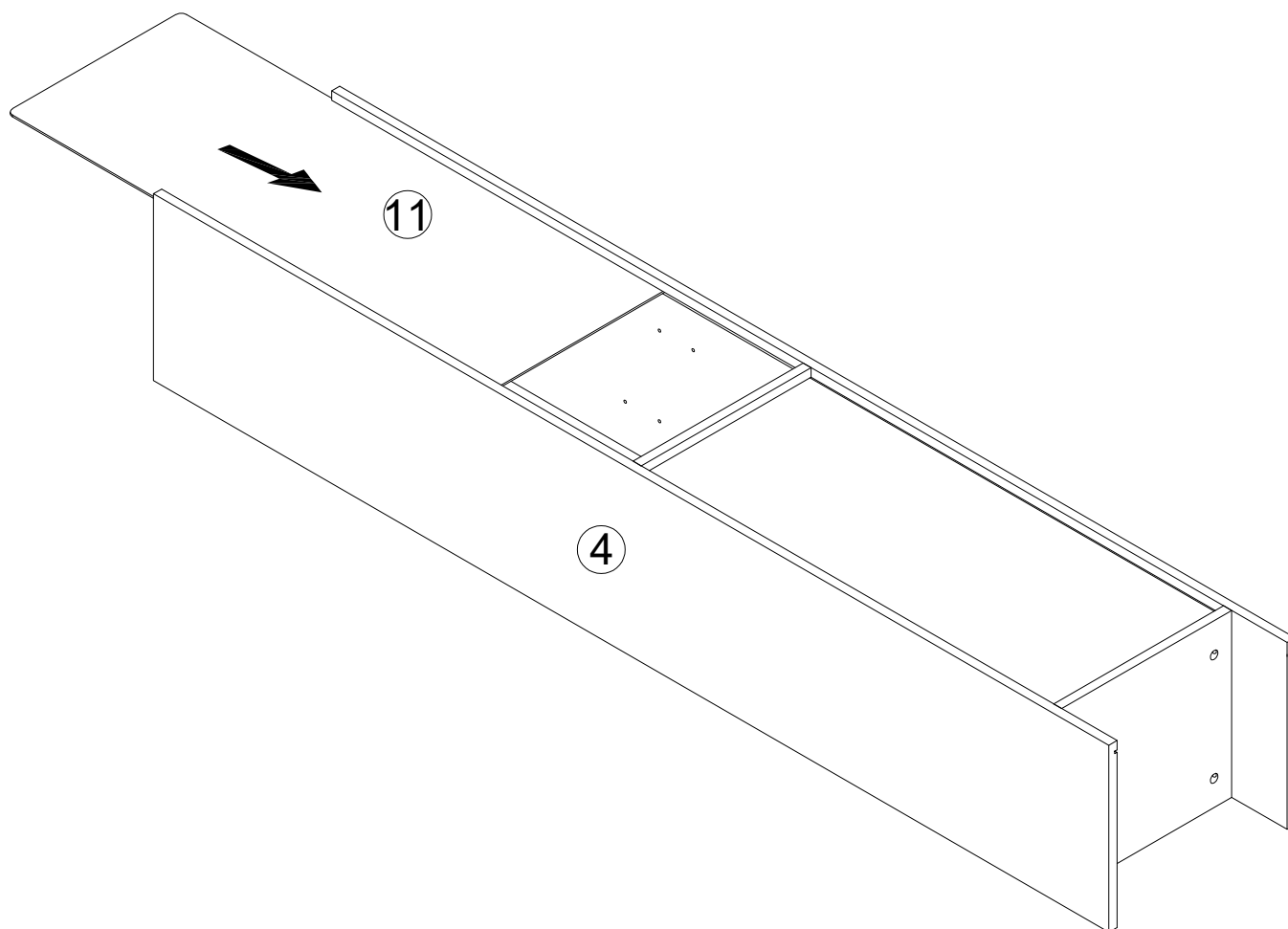



10a.

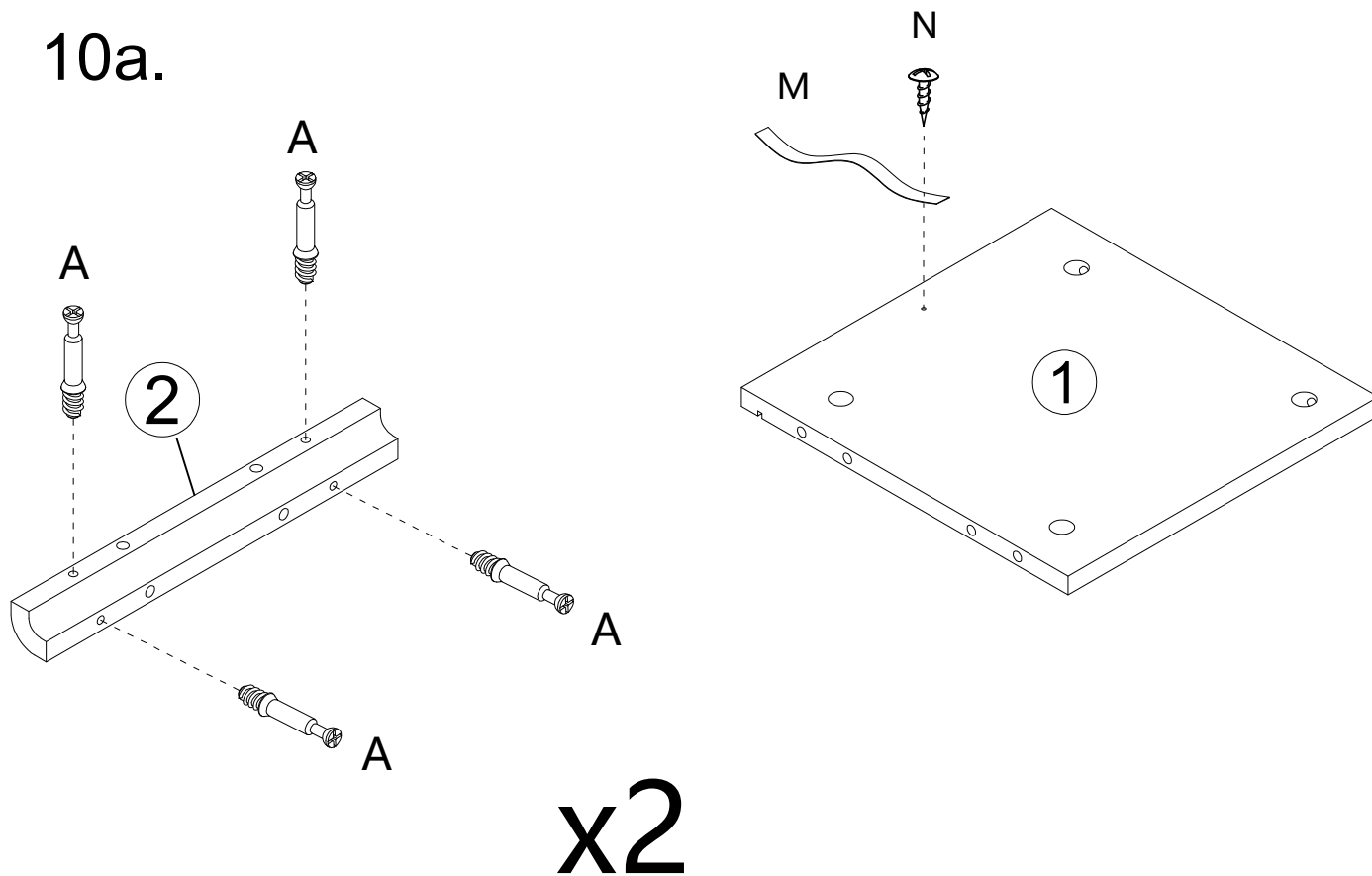

11a.

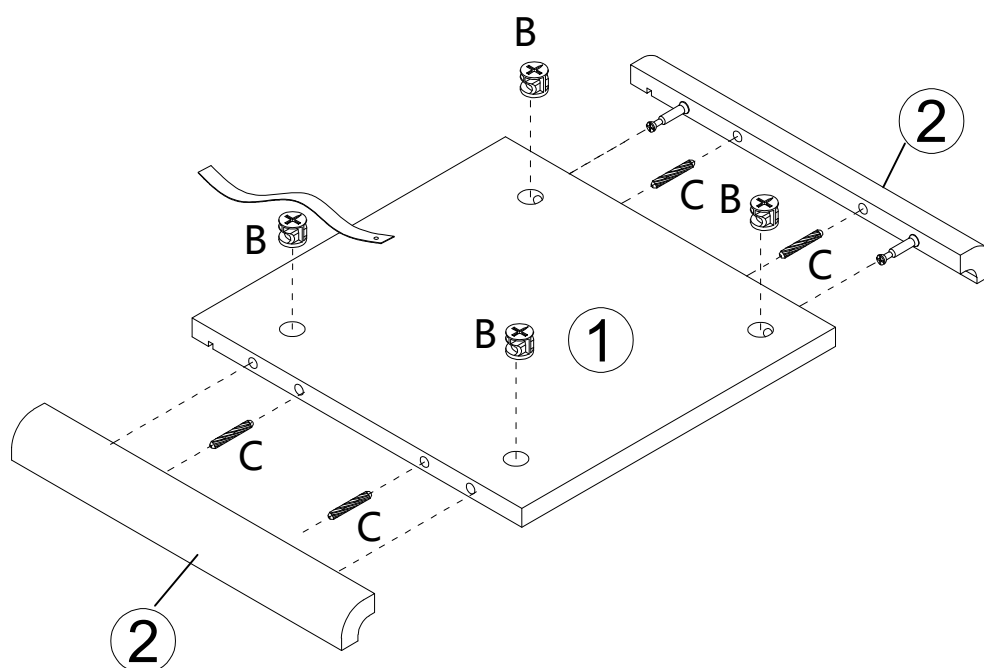

12a.

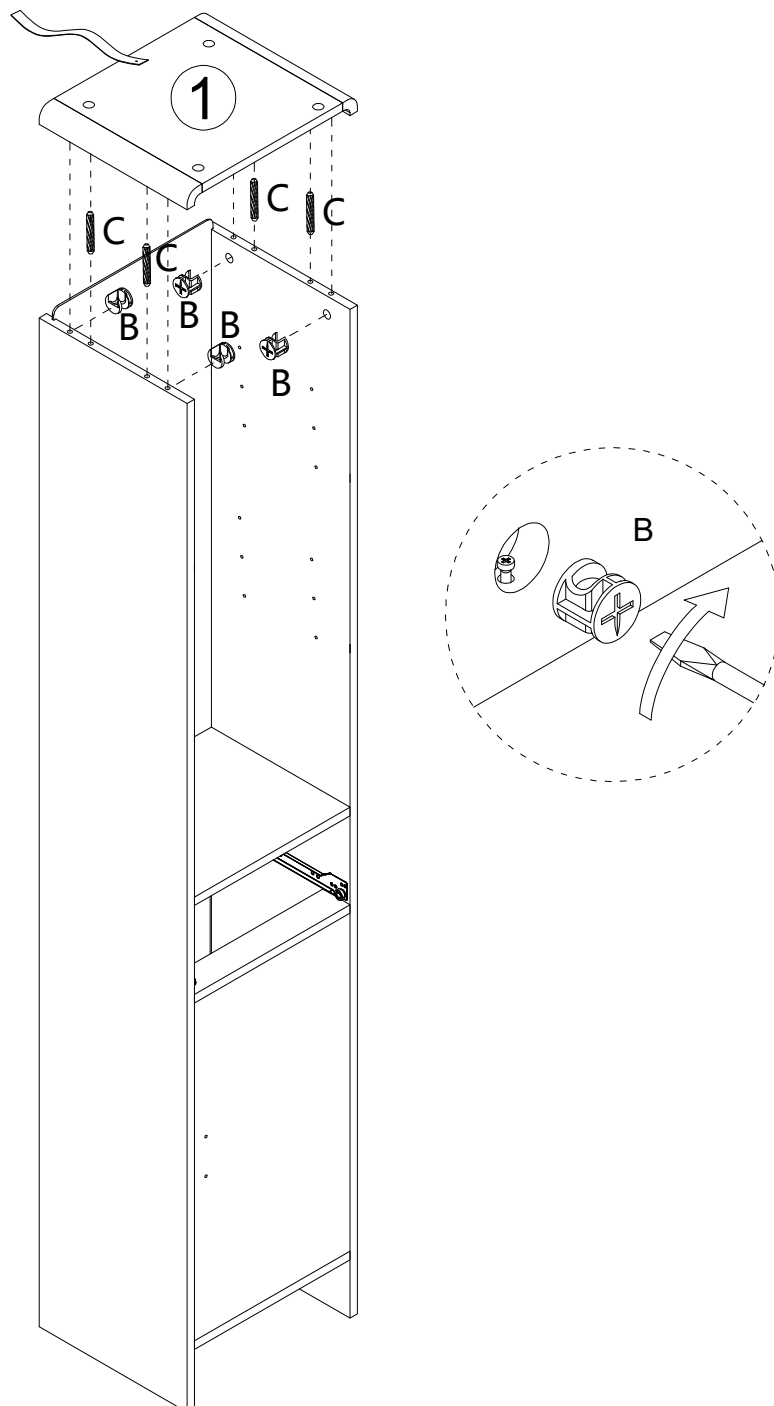

13a.

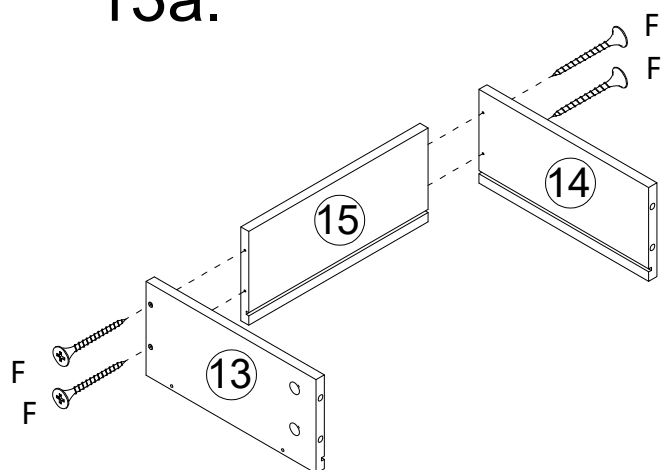

14a.

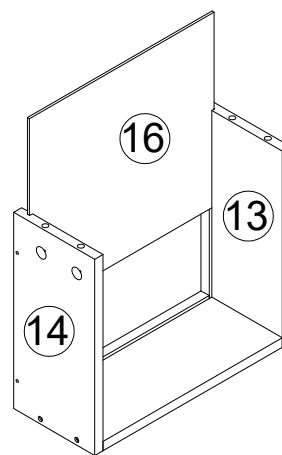

15a.

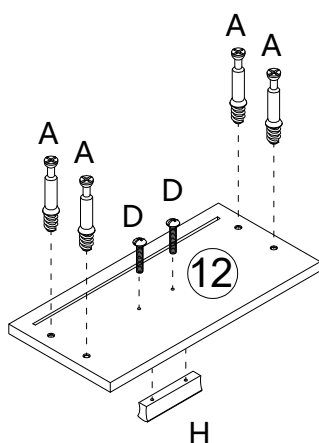

16a.

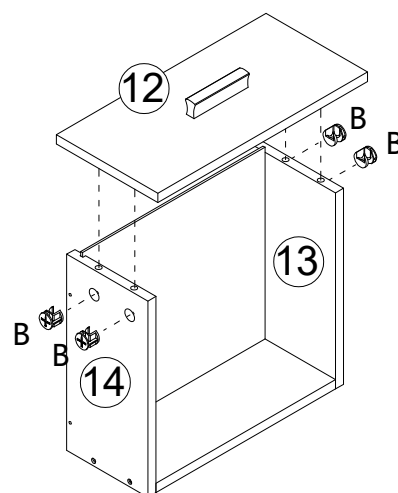

17a.

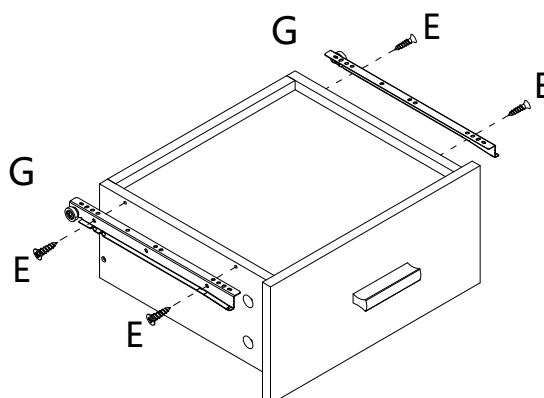
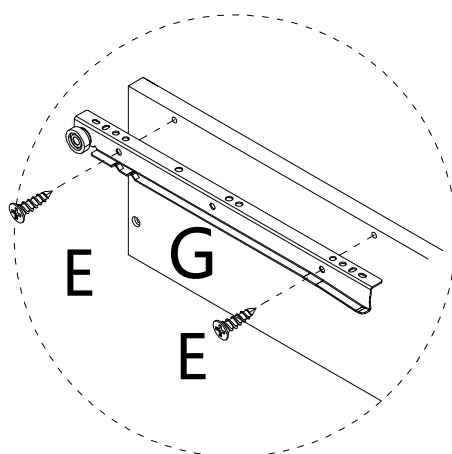

18a.

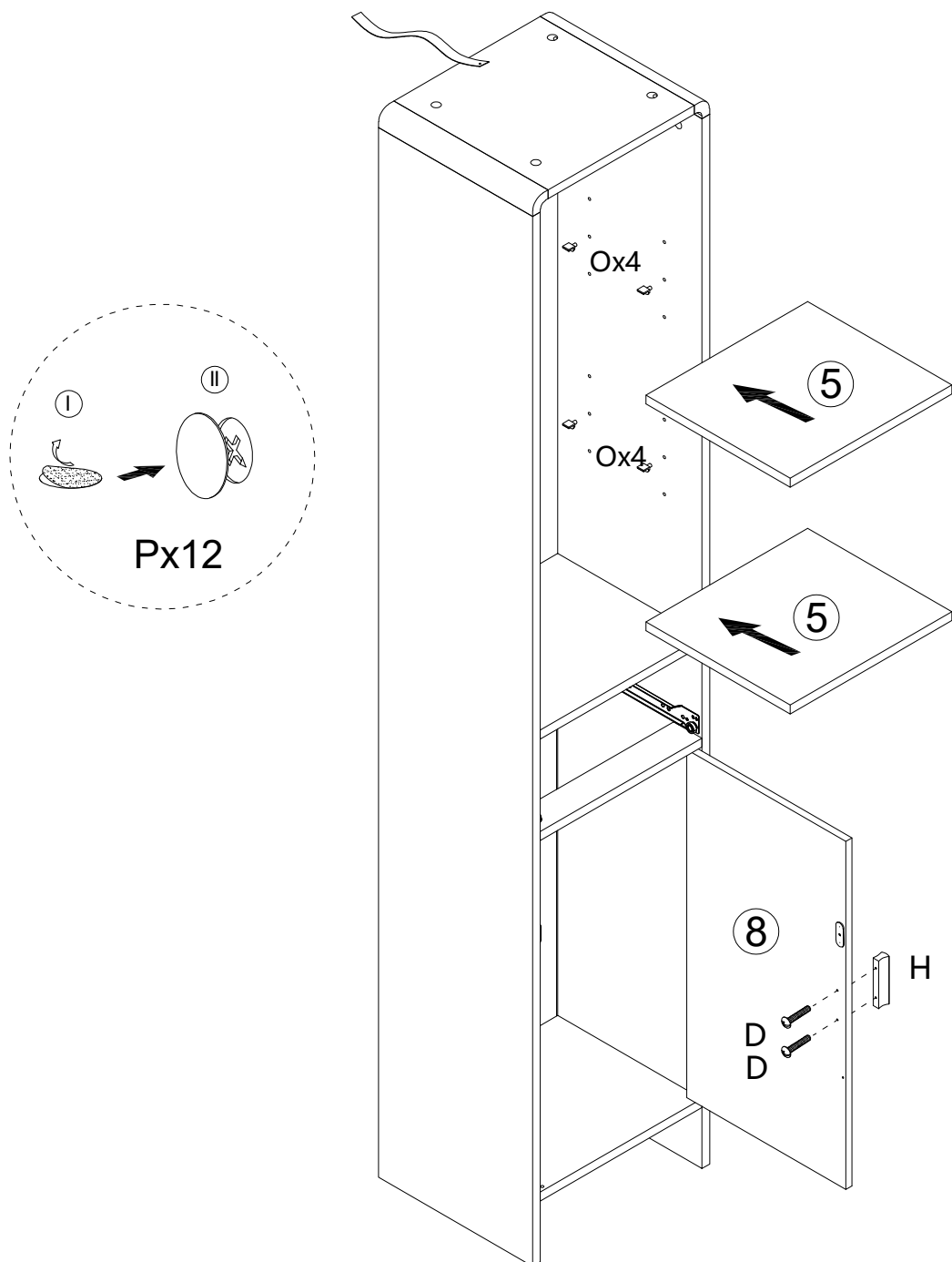

19a.

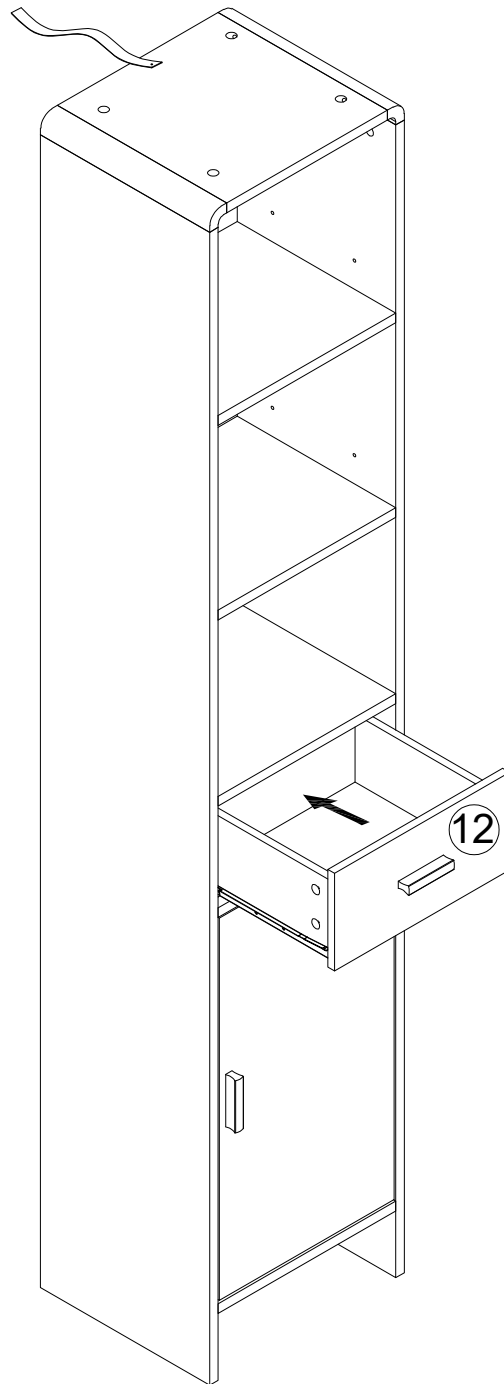

20a.

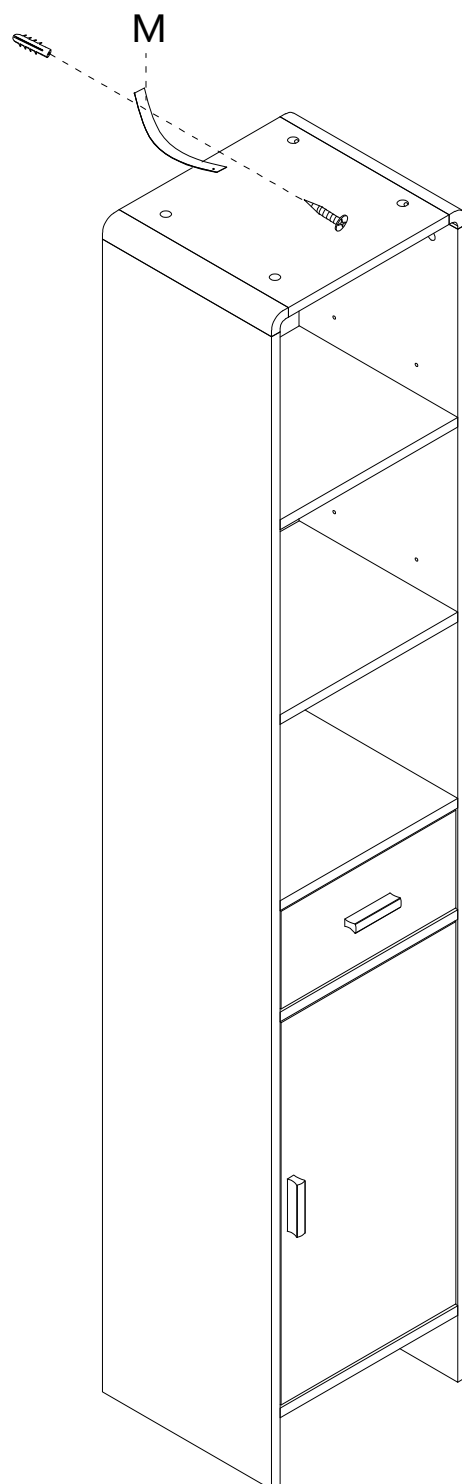

Fitting M should be used to secure your ST BTH HALE TALL CAB to the wall. Screws and fittings for wall are not supplied as different wall constructions require fittings that are suitable for your wall type. If you are unsure for the correct type of fitting for your wall, please contact your local specialised hardware store for information on suitable fitting.

## 1b. door opening left

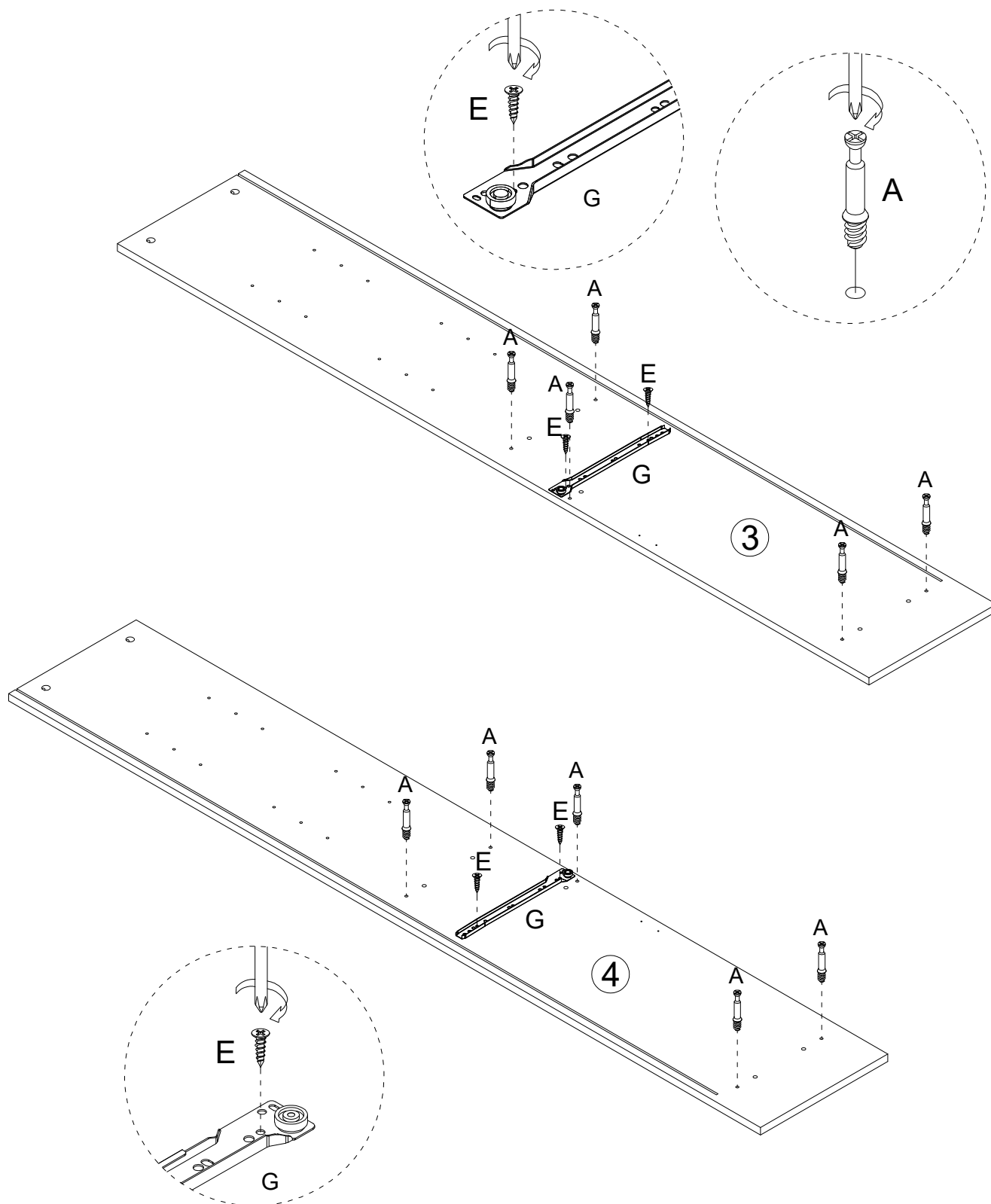

2b.

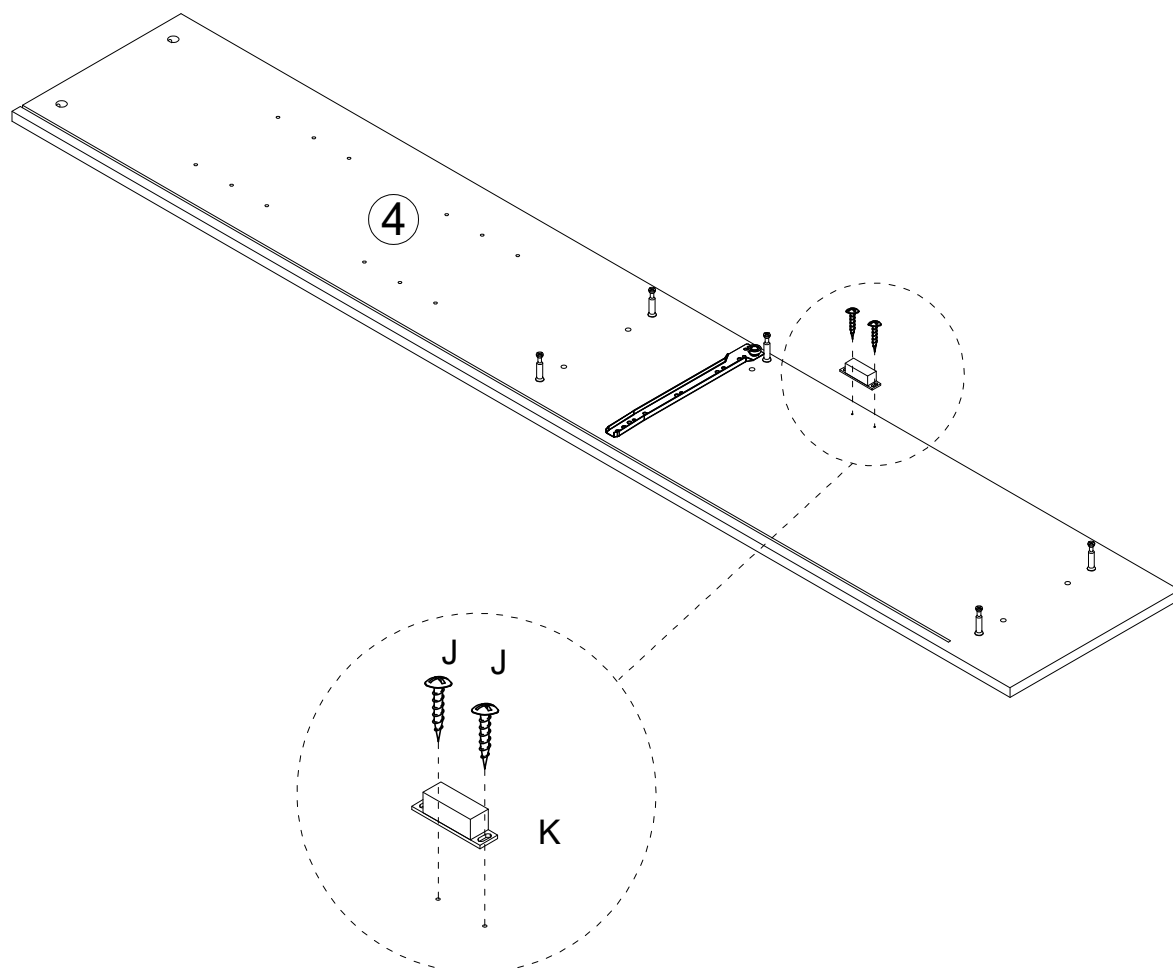

3b.

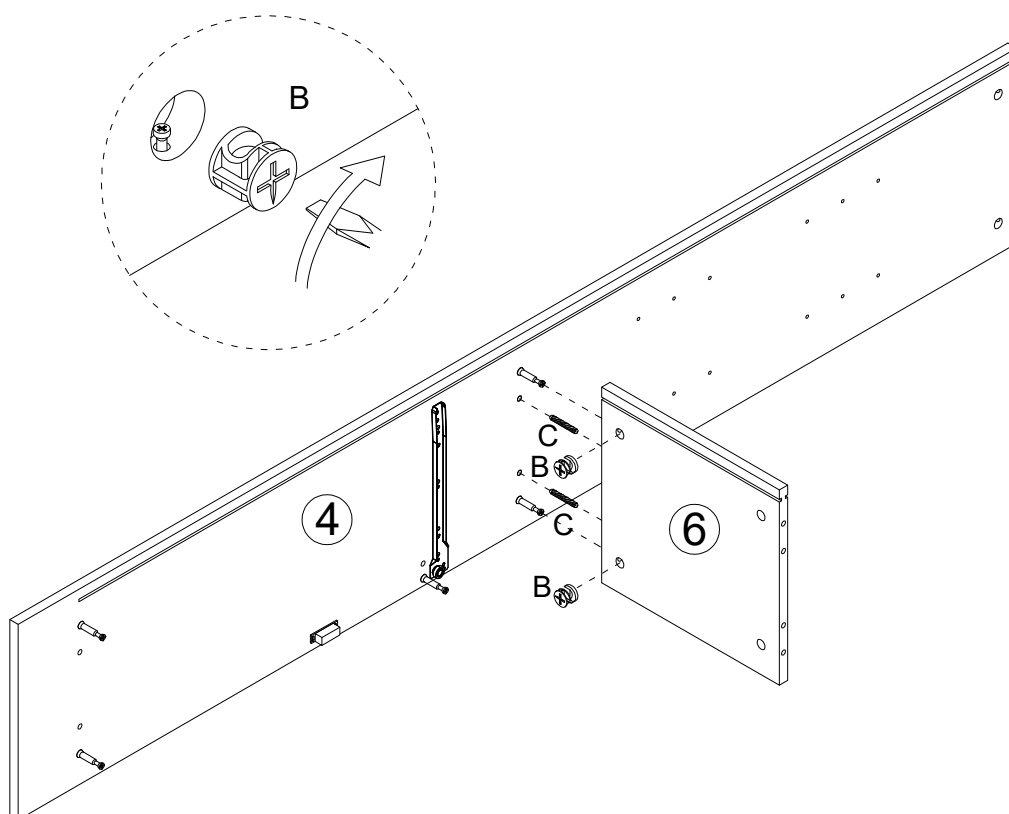



4b.

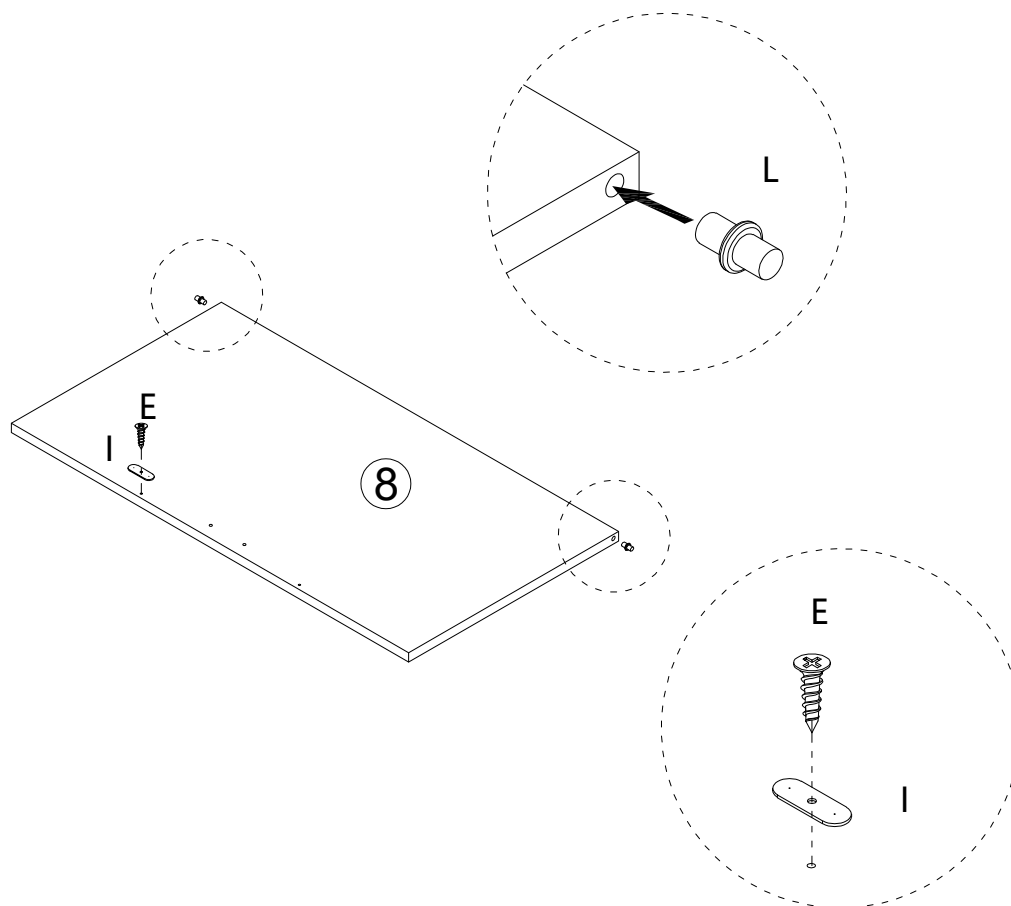

5b.

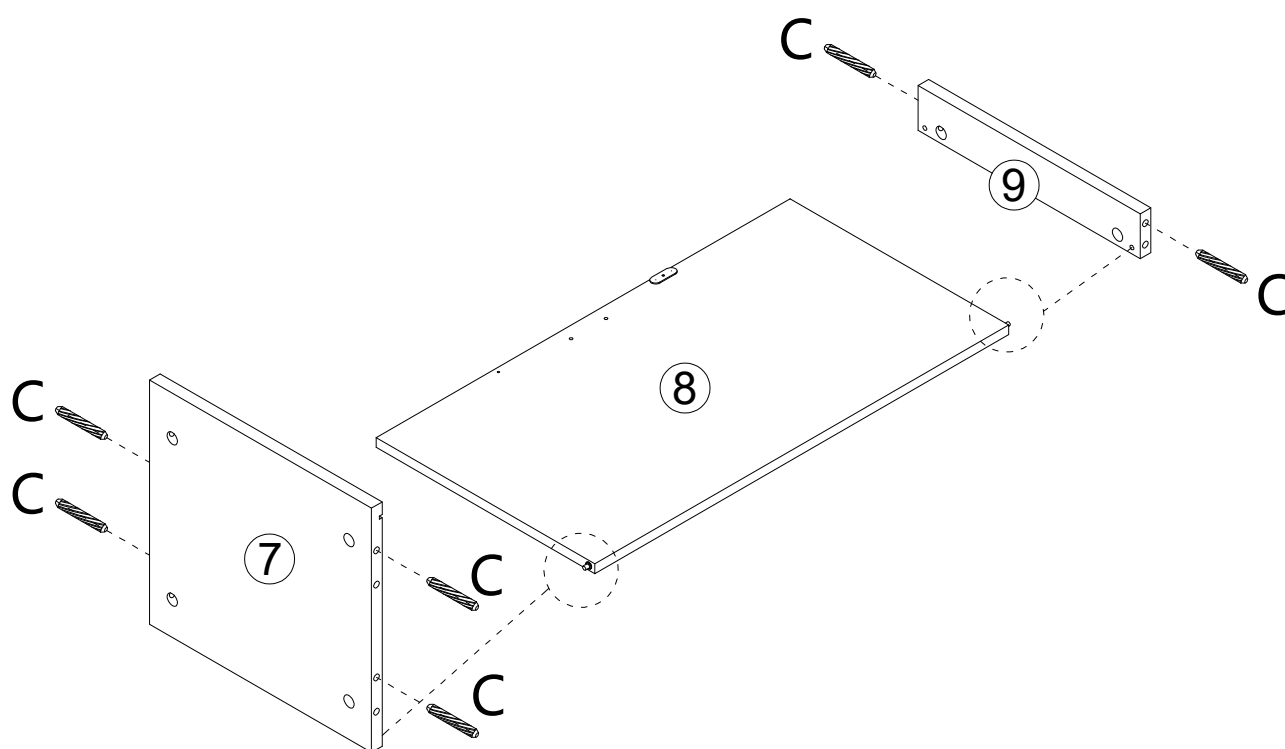

6b.

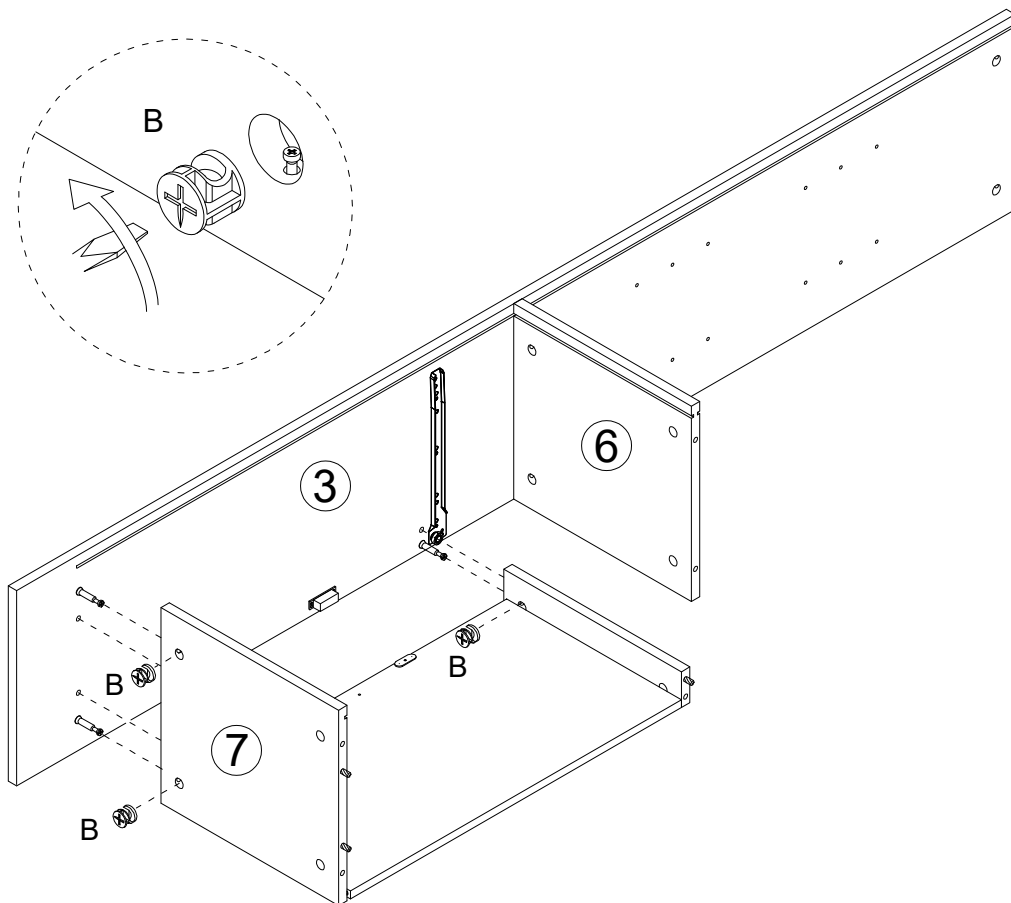

7b.

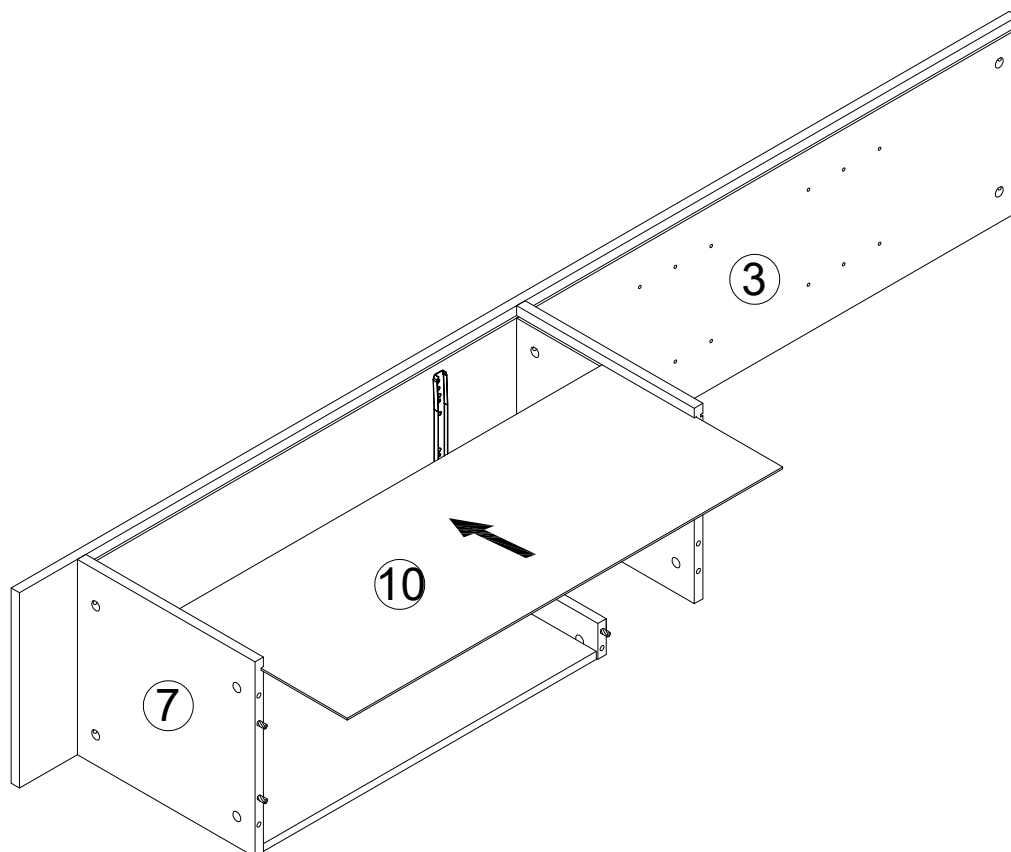

8b.

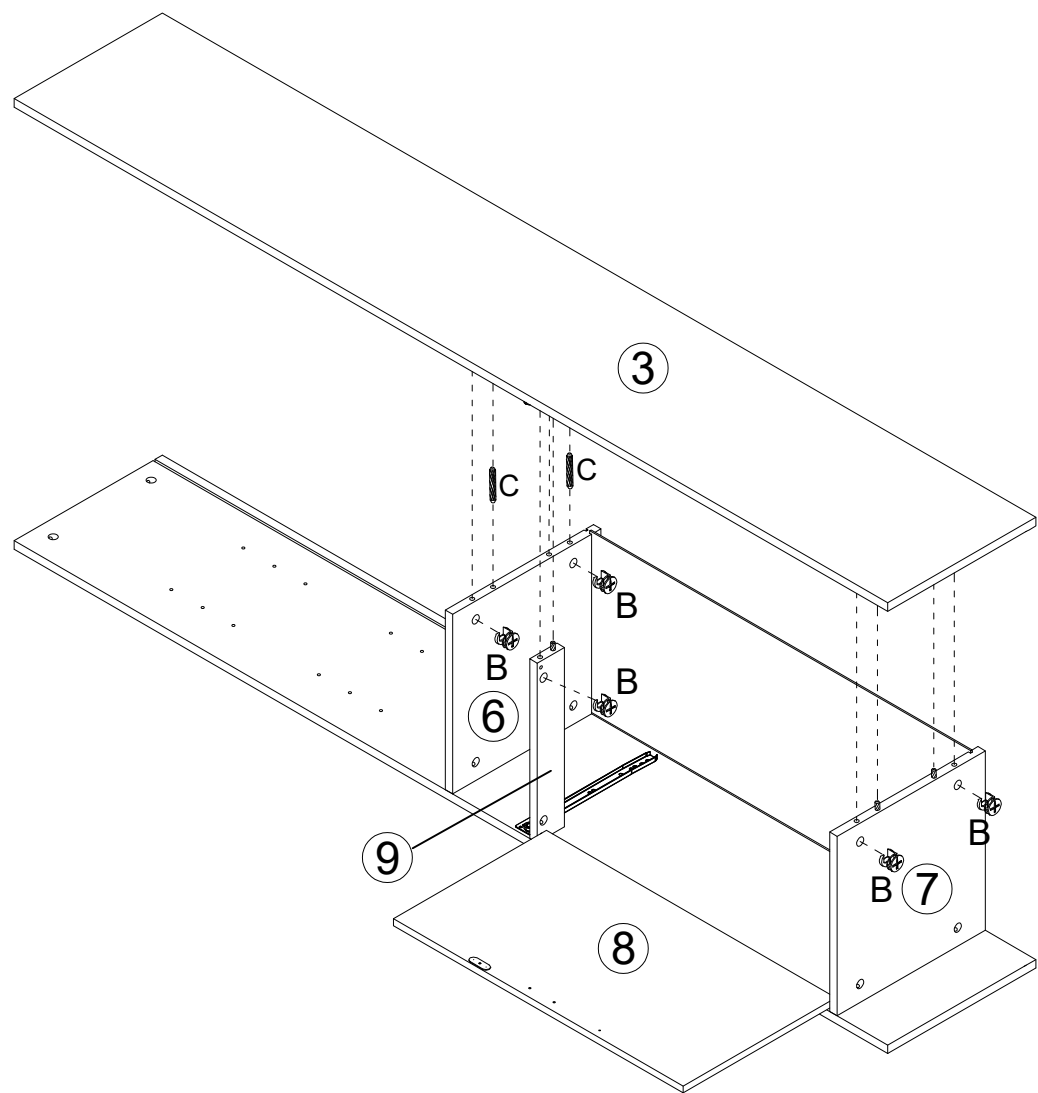

9b.

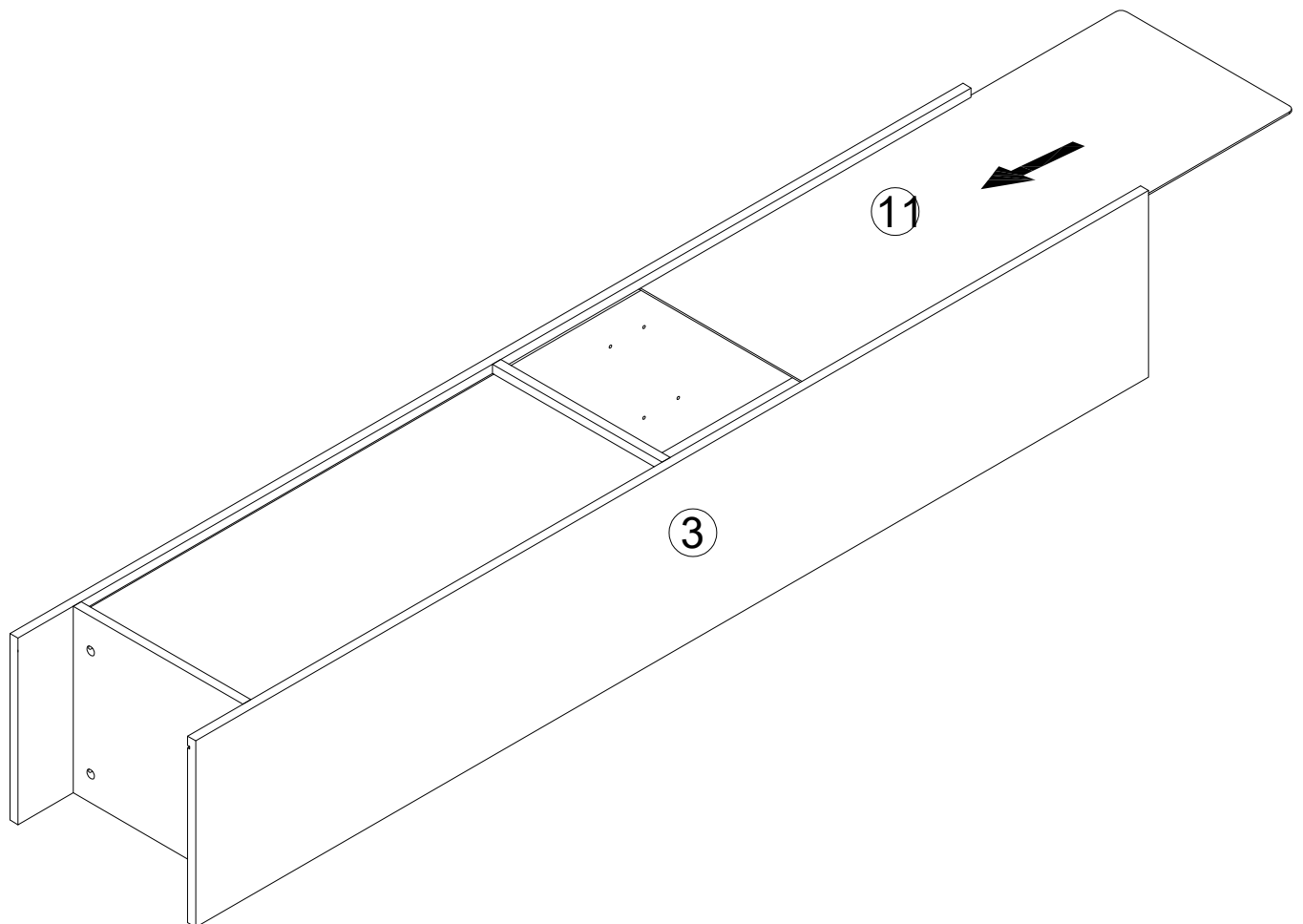

10b.

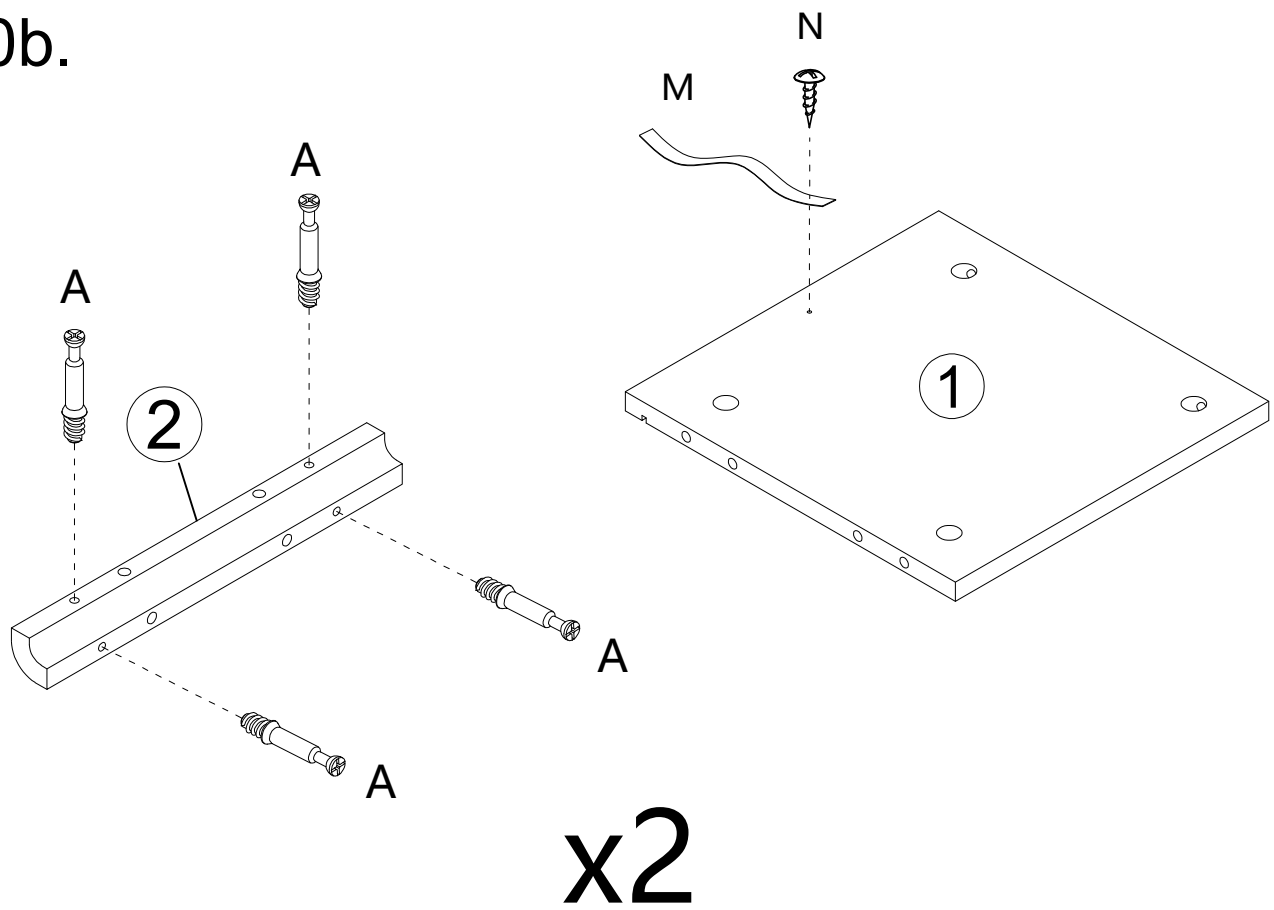

11b.

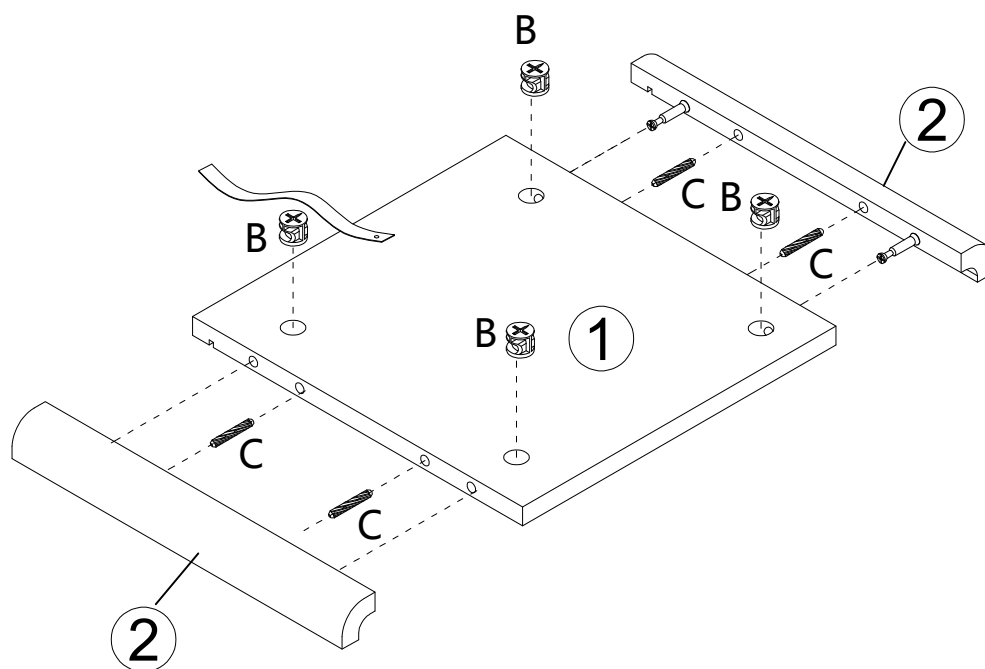

12b.

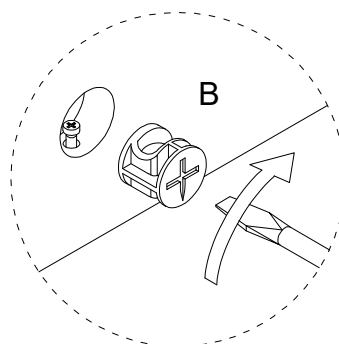
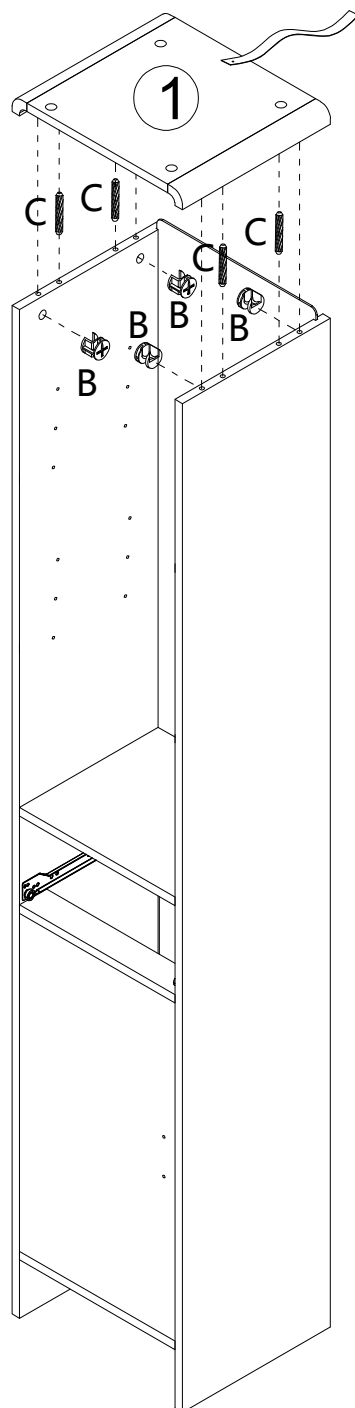

13b.

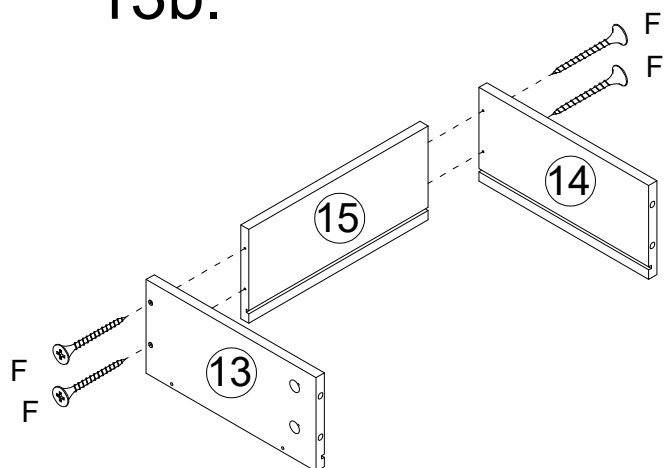

14b.

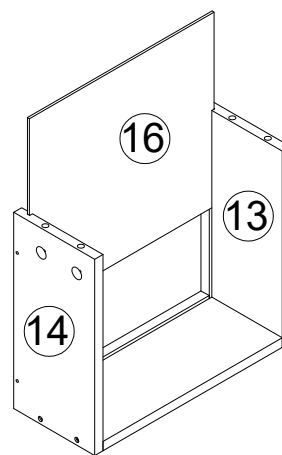

15b.

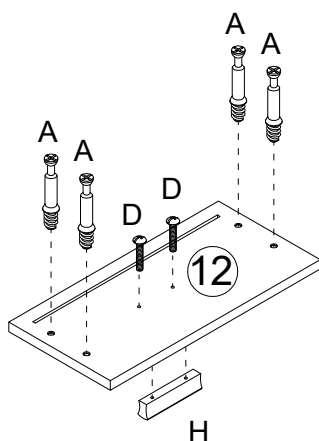

16b.

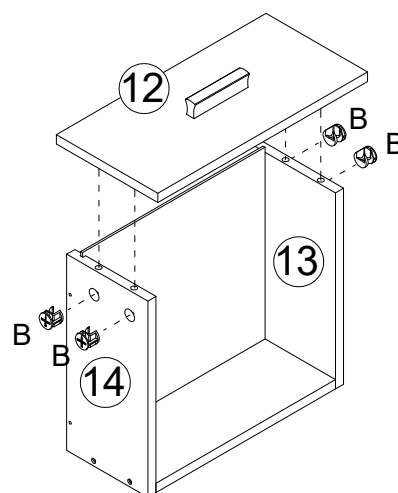

17b.

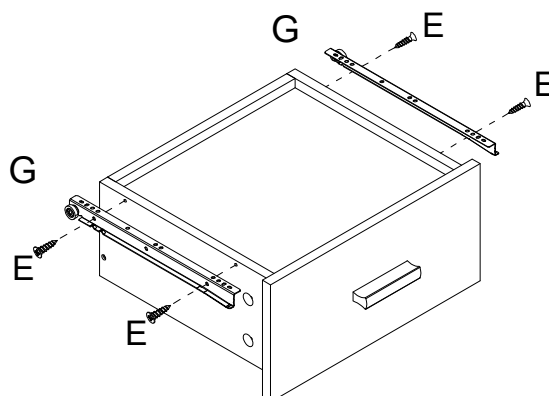
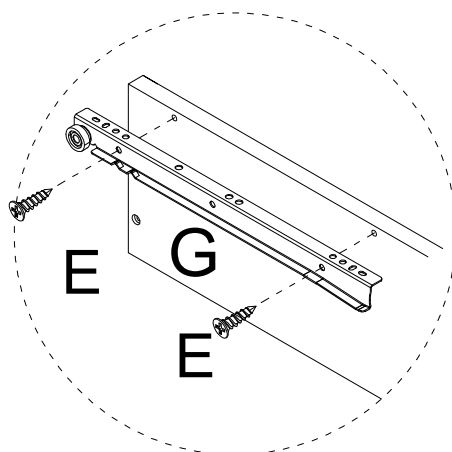

18b.

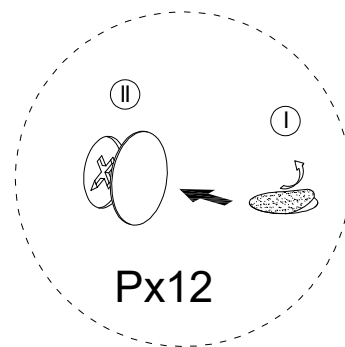
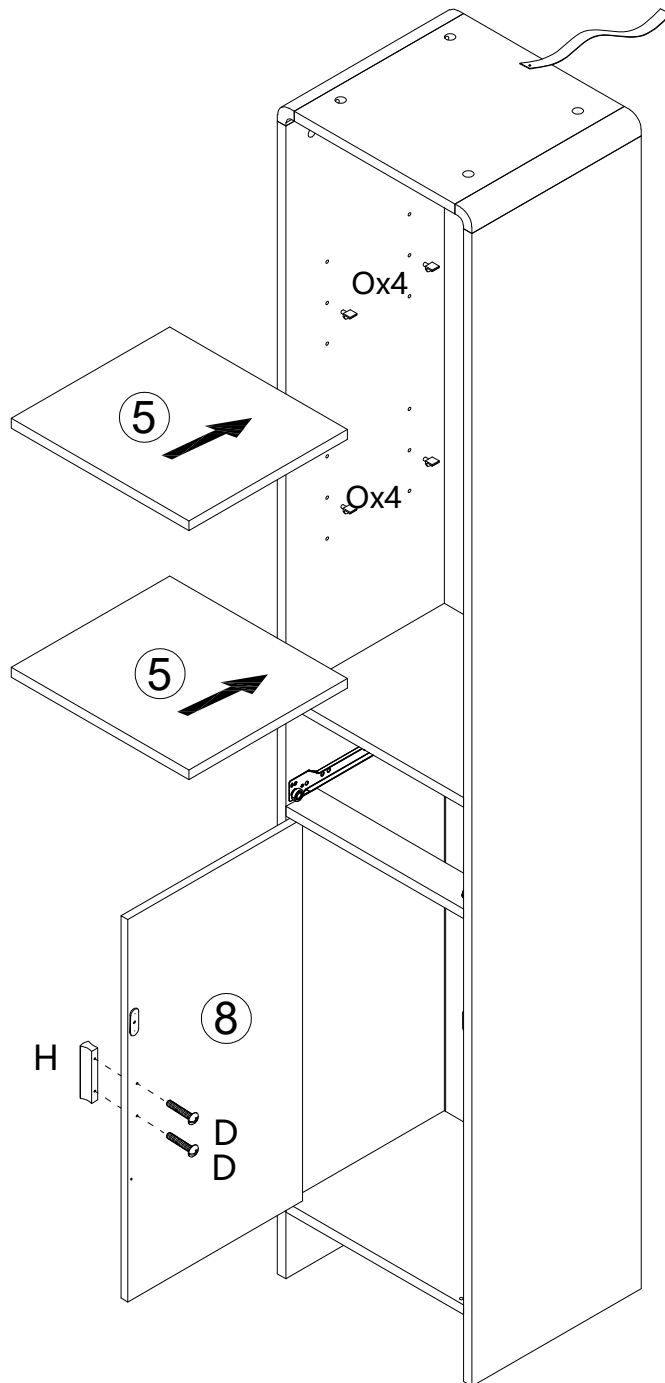

19b.

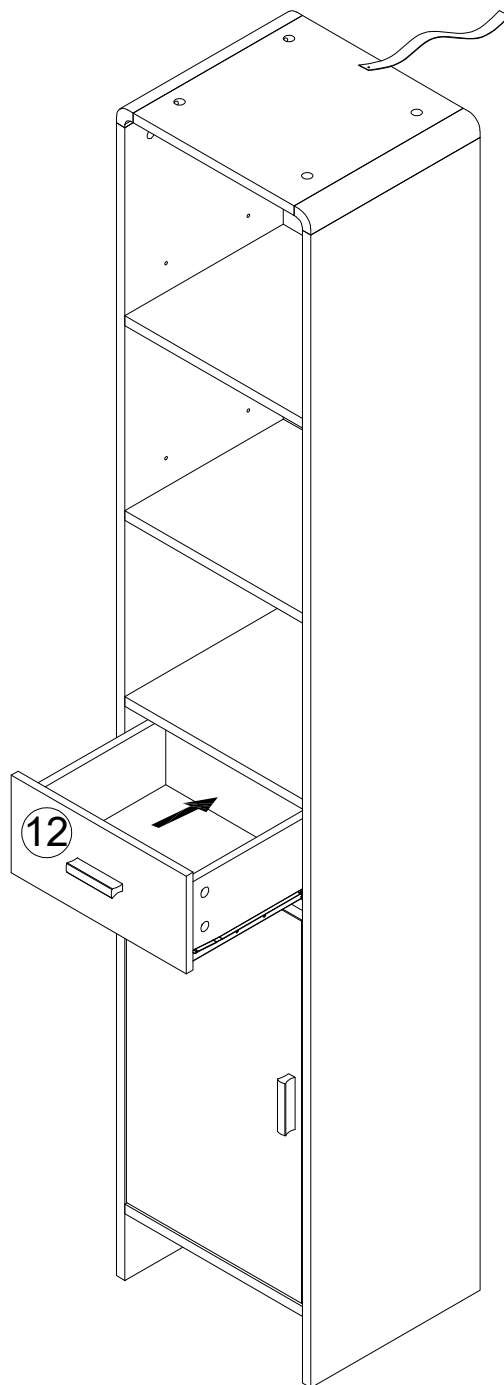



20b.

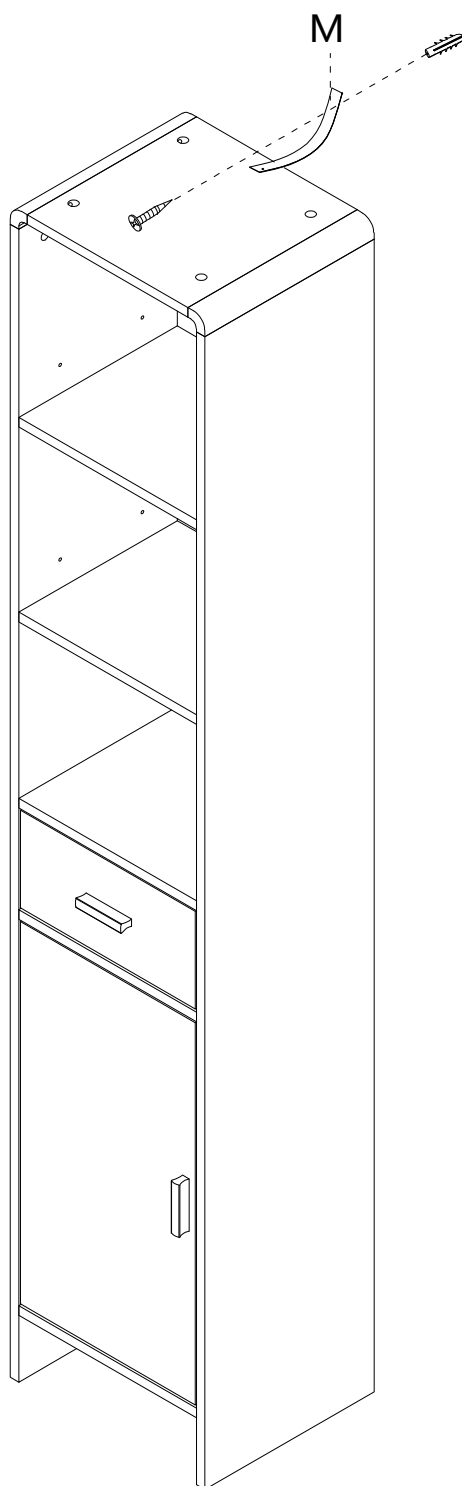

Fitting M should be used to secure your ST BTH HALE TALL CAB to the wall. Screws and fittings for wall are not supplied as different wall constructions require fittings that are suitable for your wall type. If you are unsure for the correct type of fitting for your wall, please contact your local specialised hardware store for information on suitable fitting.