

ASSEMBLY INSTRUCTION

FUTON
C O M P A N Y

PRODUCT CODE :T4 EDO CON DESK
PO NUMBER:10166

HARDWARE LIST



Ax8



Bx4



Cx1

PARTS LIST

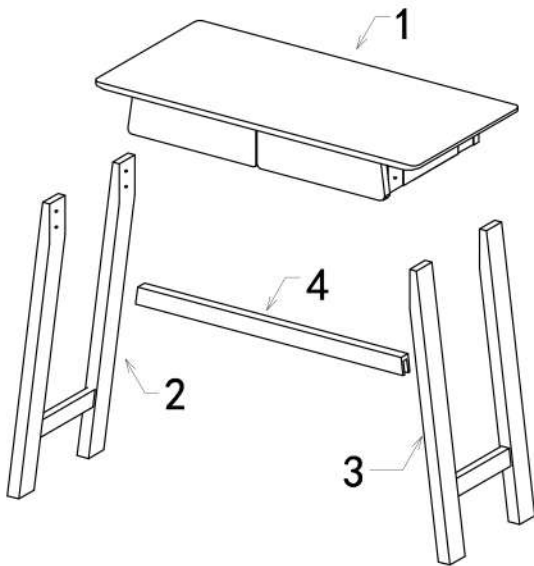

01

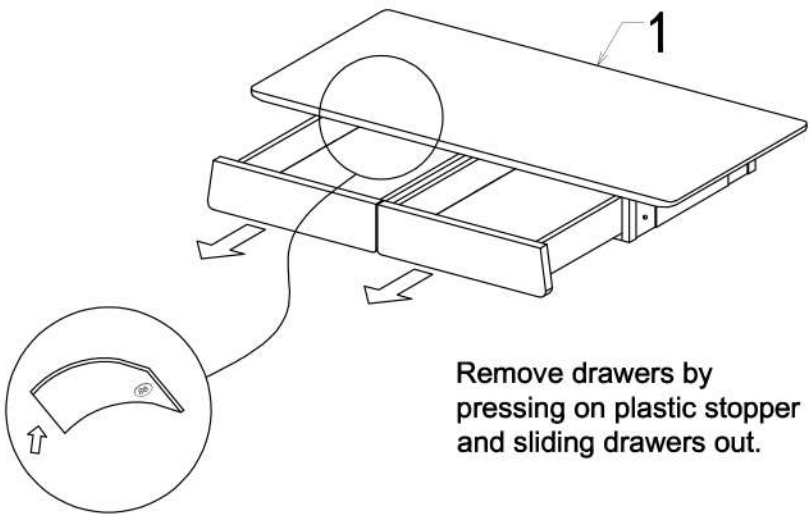

Remove drawers by pressing on plastic stopper and sliding drawers out.

02



Bx4

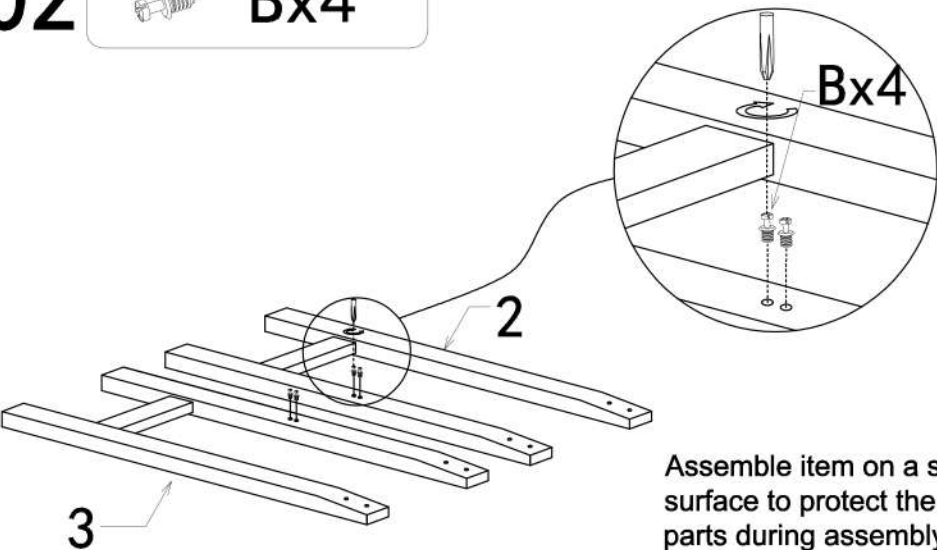

Assemble item on a soft surface to protect the parts during assembly.

ASSEMBLY INSTRUCTION

FUTON
C O M P A N Y

03



Ax8



Cx1

Important, all 8 of fitting A should be inserted loosely and not fully tightened.

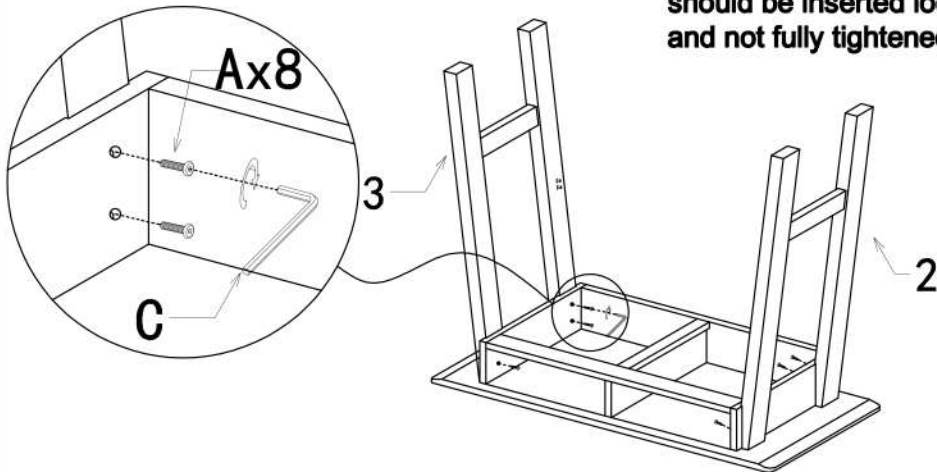

04

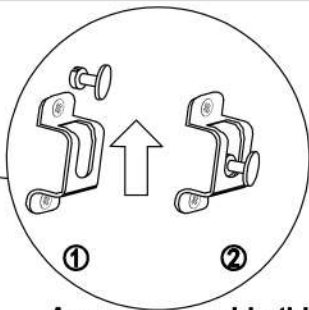

As you assemble this step. Line up the screw heads of fitting B to the pre-fitted cleat of Part 4 and very gently tap into place using a soft rubber mallet. DO NOT use a hammer as this may cause damage to Part 4. Use a piece of the cardboard packing in-between Part 4 and mallet to prevent any marks during assembly. When all components are in place, tighten all of fitting A.

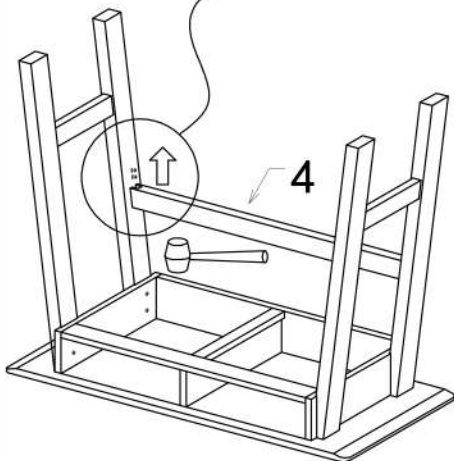

05

Replace drawers to complete assembly.

