

Assembly Instructions

FUTON
C O M P A N Y

Oak Edwin Square Side Table

ROPO no:

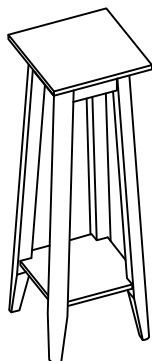

PLEASE READ THESE INSTRUCTIONS VERY CAREFULLY BEFORE YOU BEGIN, TO ENSURE THAT YOUR FUTON COMPANY PRODUCT WILL GIVE YOU MANY YEARS OF SATISFACTION

Thank you for buying a Futon Company product.

We are constantly striving to improve everything we do, but occasionally mistakes do occur. In the unlikely event that you find any part missing, please call your nearest Futon Company store and we will arrange for the despatch of an immediate replacement. Please keep all packaging until you have checked every part and assembly of your Futon Company product is complete.

Version number: 2 Product code: T1 EDWIN SQR OAK Date: 05/01/25

experts in small space living



Parts Checklist

Please count and check every component very carefully before you begin

① Top x 1

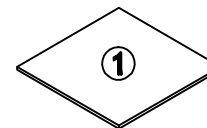

② Legs x 4

③ Bottom Shelf x 1

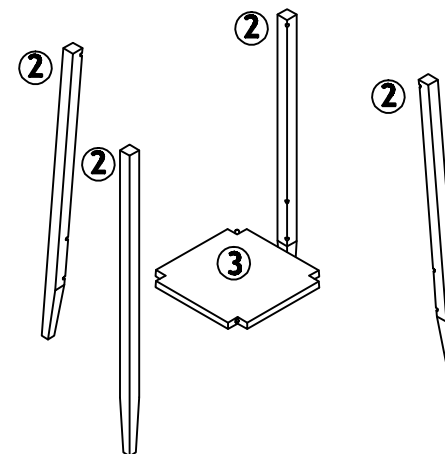

Fittings Checklist

Please count and check every component very carefully before you begin



Ⓐ Bolt x 8



Ⓑ Pressure Plate x 4



Ⓒ Nut x 8



Ⓓ Small Spanner x 1



Ⓔ Large Washer x 4



Ⓕ Felt Protector pad x 4



How To Assemble Your Table

Please follow these instructions carefully

To prevent scratching:
Lay the parts face
down on a clean, flat,
soft surface.

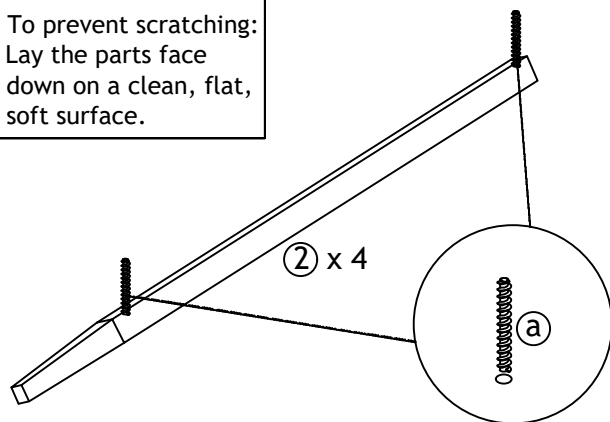

1.

FUTON
C O M P A N Y

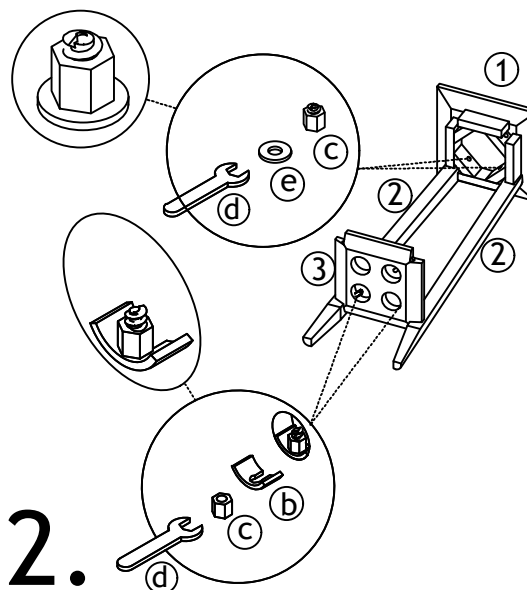

2.

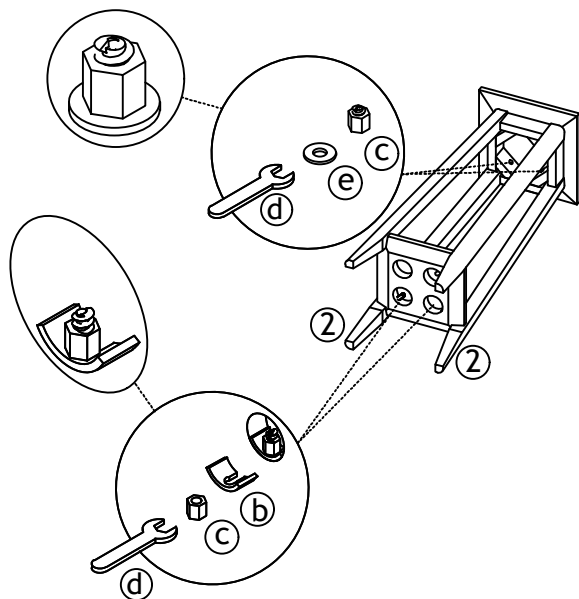

3.

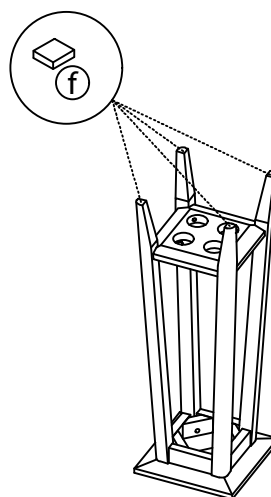

4.



How To Use

Please read carefully

FINISH

Your Table is made from solid Oak

CARE

To clean your Table, wipe with a damp
cloth followed by a dry cloth.

IMPORTANT

To ensure maximum performance from this
product, we advise that you check and tighten all
bolts and screws on a regular basis to avoid damage
and strain to parts.

GUARANTEE

This instruction leaflet forms part of your
guarantee. Please retain it. The ROPO number along
with your invoice number will need to be quoted in
all correspondence with Futon Company.
Thank you for choosing Futon Company.

