

# ASSEMBLY INSTRUCTIONS

**FUTON**  
C O M P A N Y

ST CAB HALE NRW

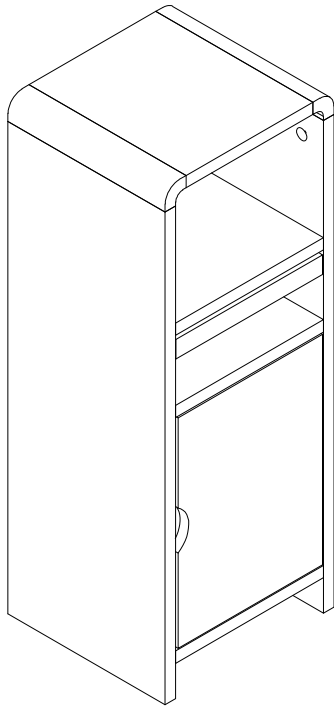

a. To assemble your cabinet with door opening RIGHT follow A instructions.

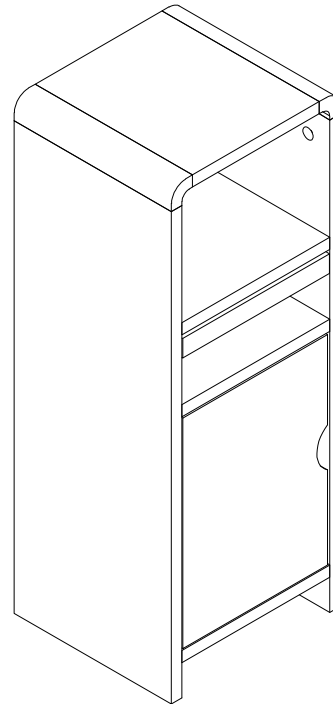

b. To assemble your cabinet with door opening LEFT follow B instructions.

## Fittings Checklist

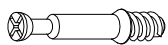

Ⓐ x16



Ⓑ x16



Ⓒ x22



Ⓓ x2



Ⓔ x2



Ⓕ x1



Ⓖ x2



Ⓗ x1



Ⓘ x1



Ⓙ x1



Ⓚ x4

# Parts Checklist

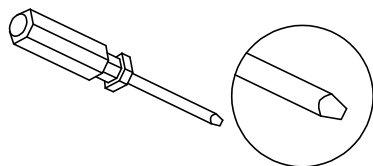
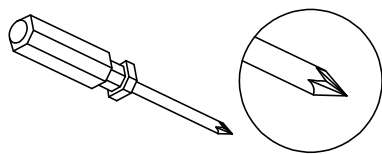
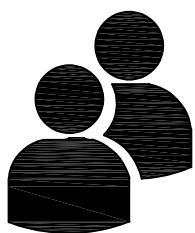
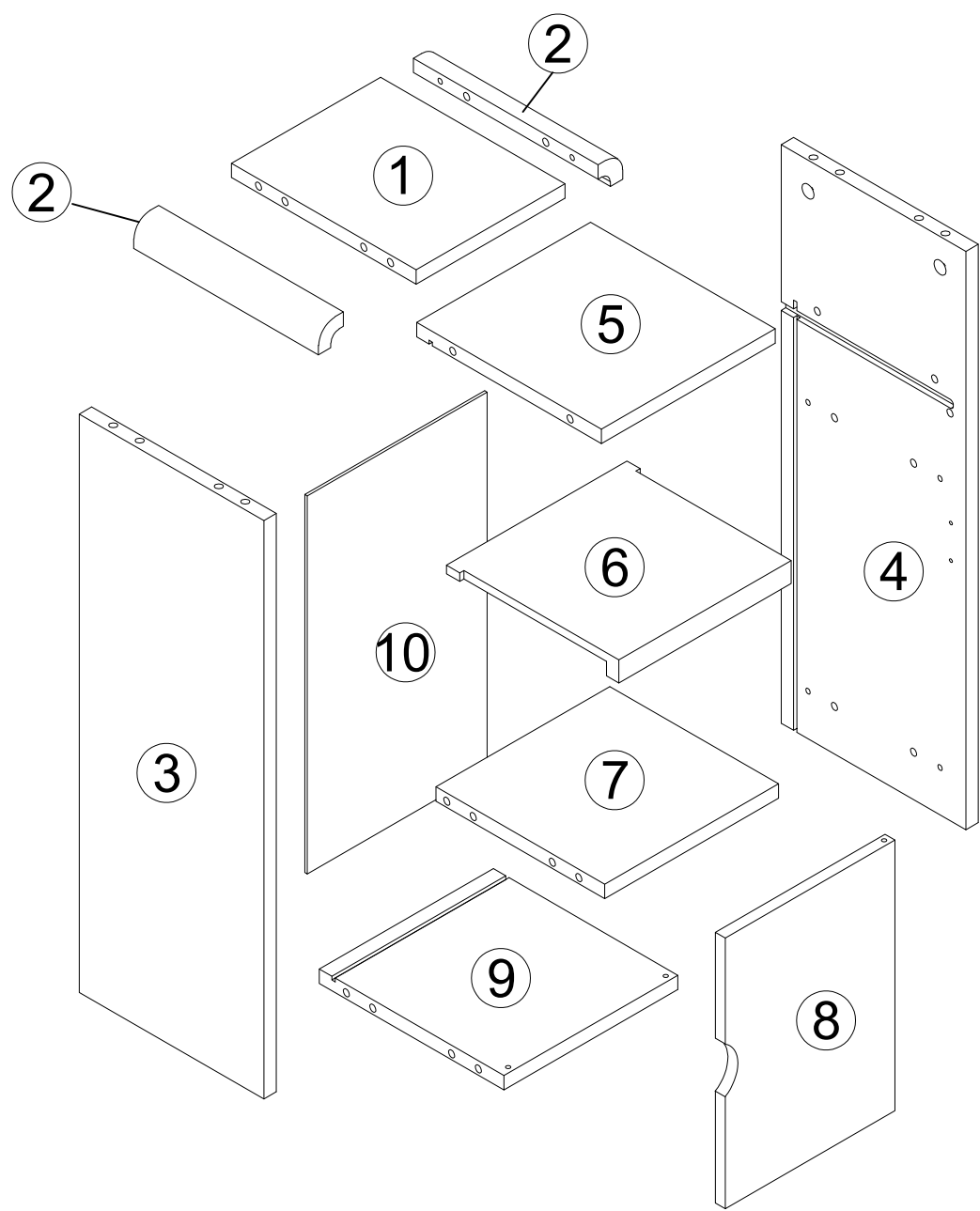

Allow 60 minutes to assemble this item

## 1a. door opening right

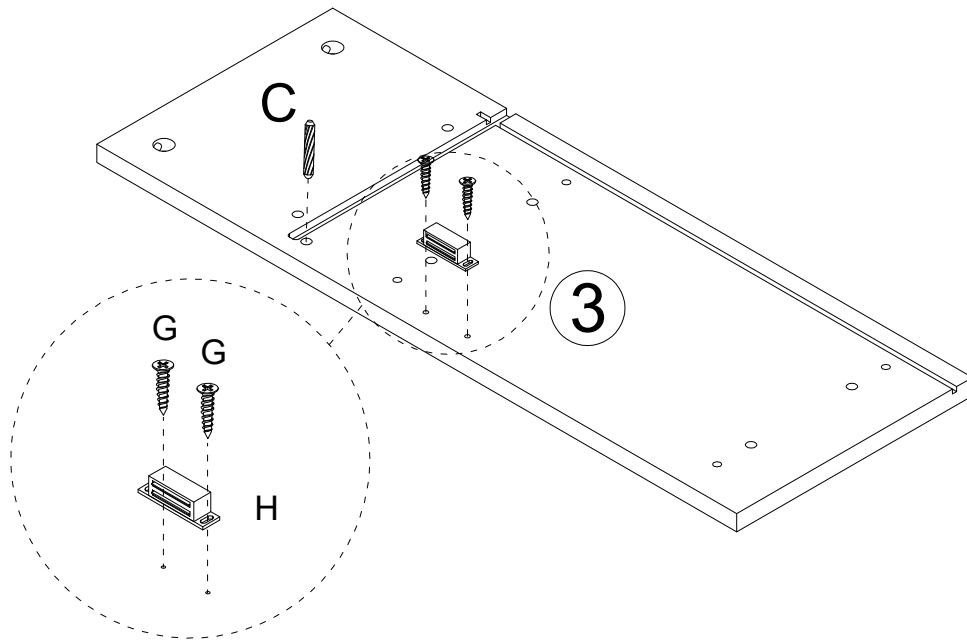

## 2a.

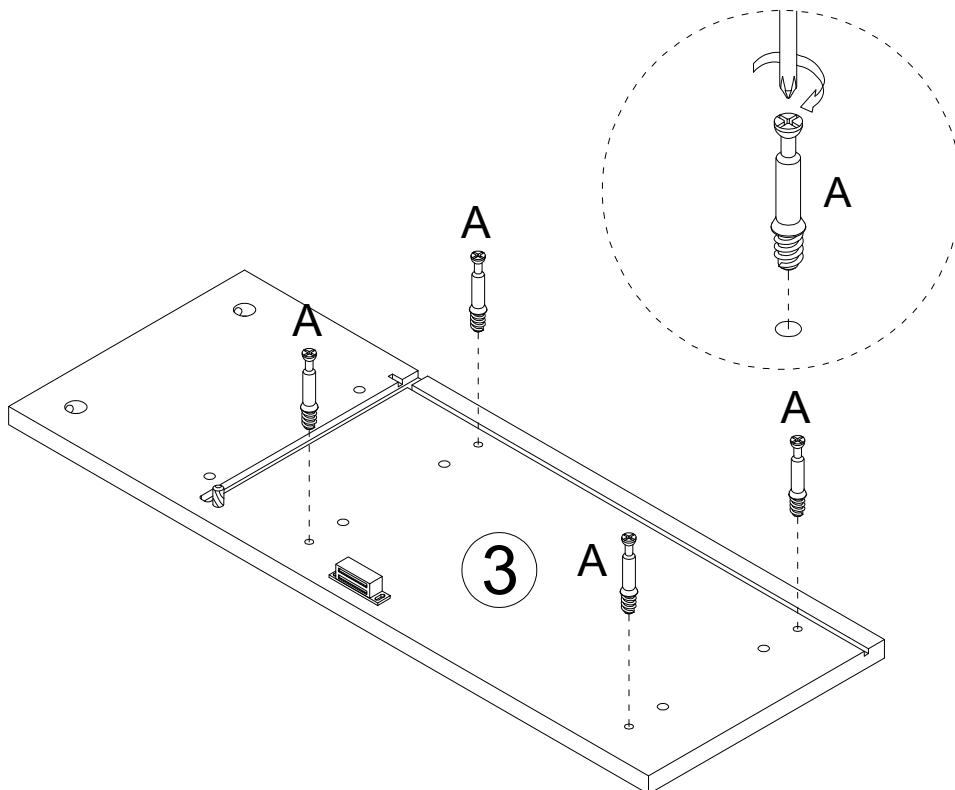

3a.

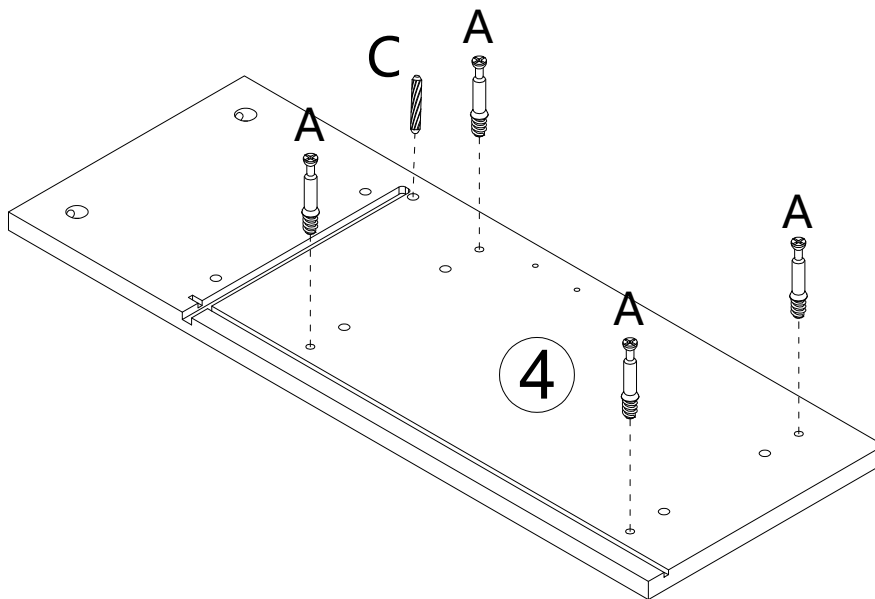

4a.

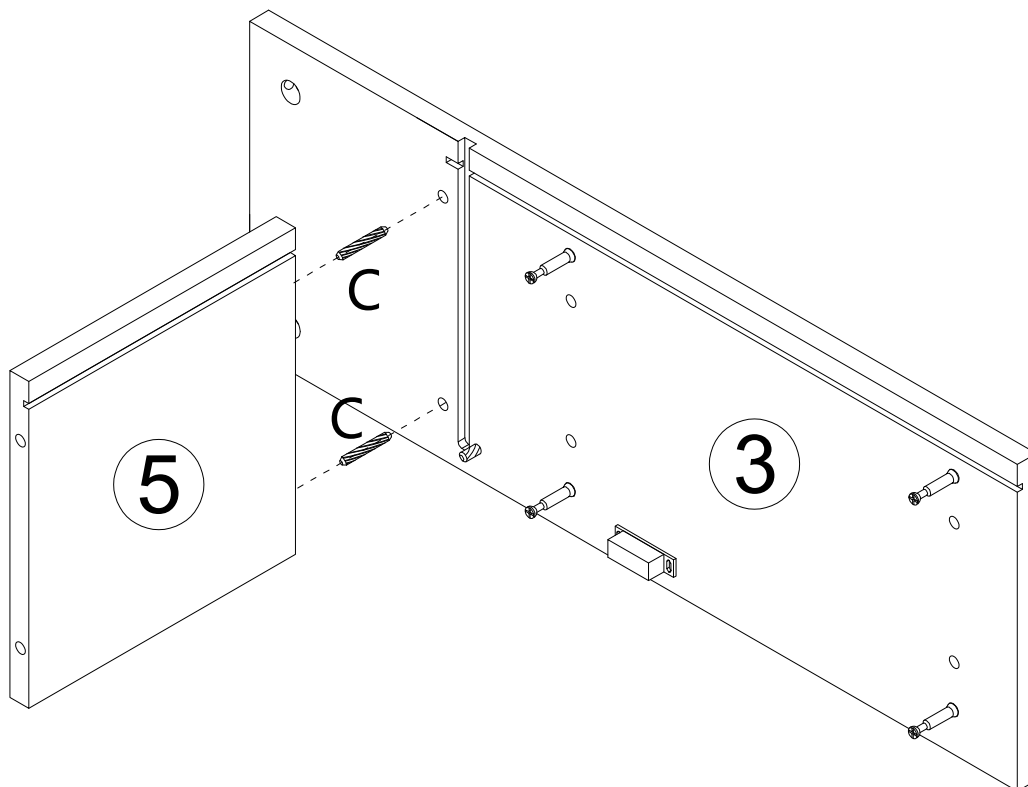

5a.

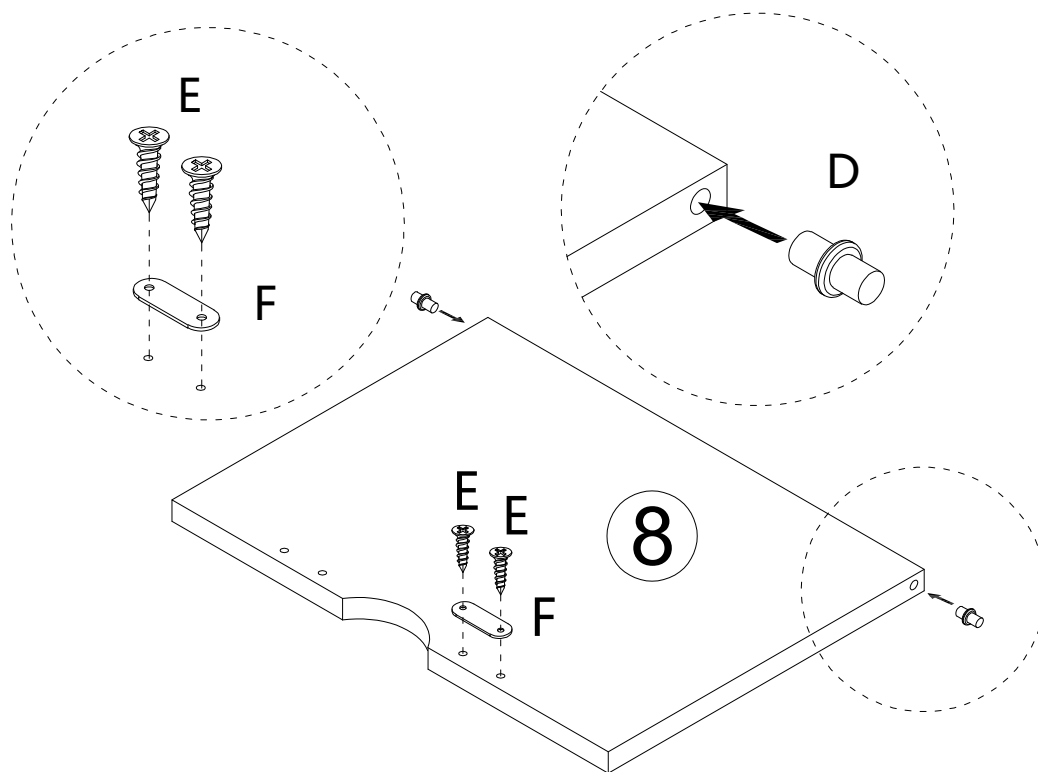

6a.

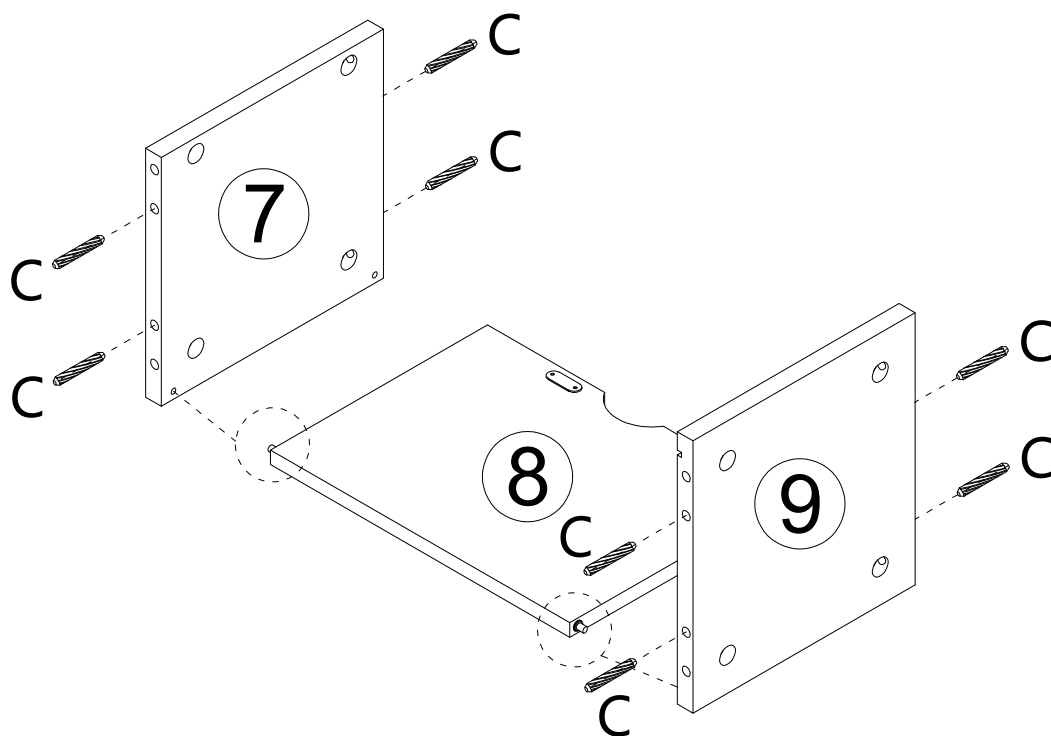

7a.

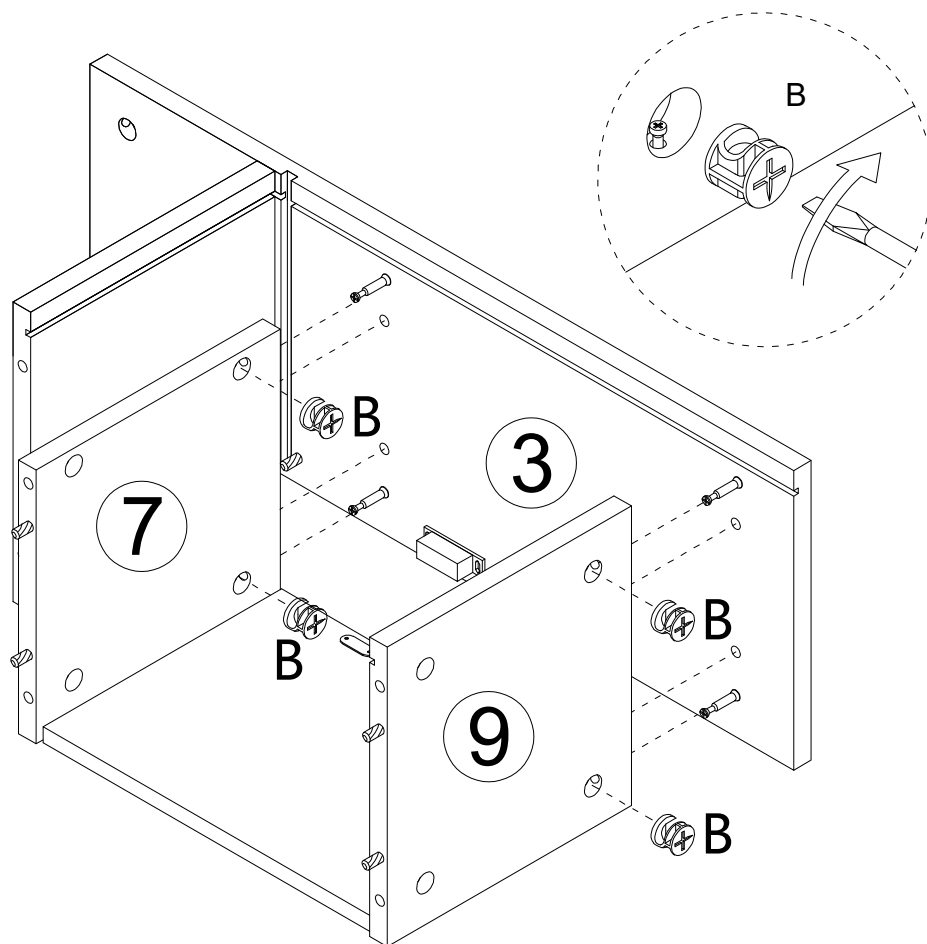

8a.

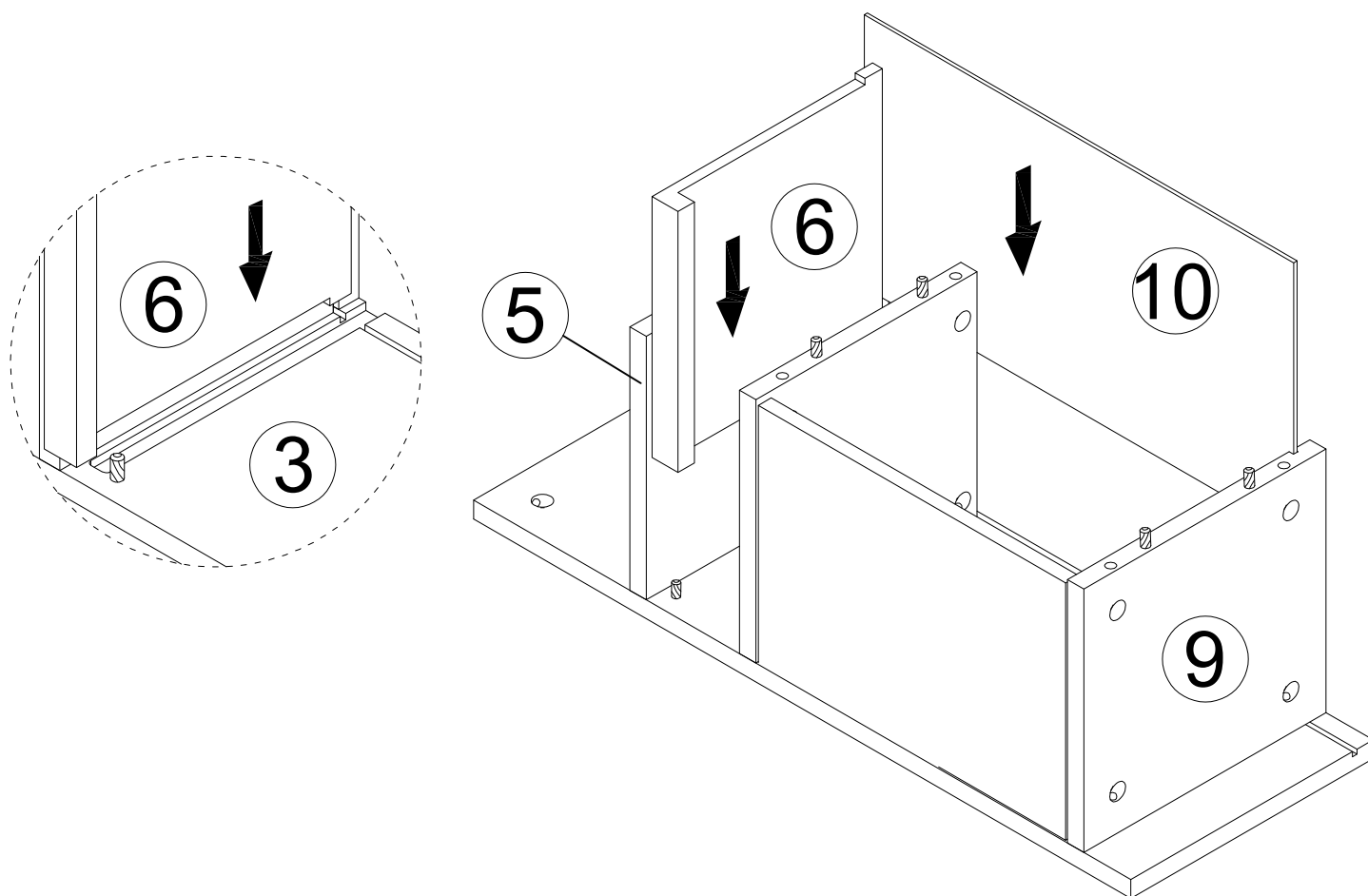

9a.

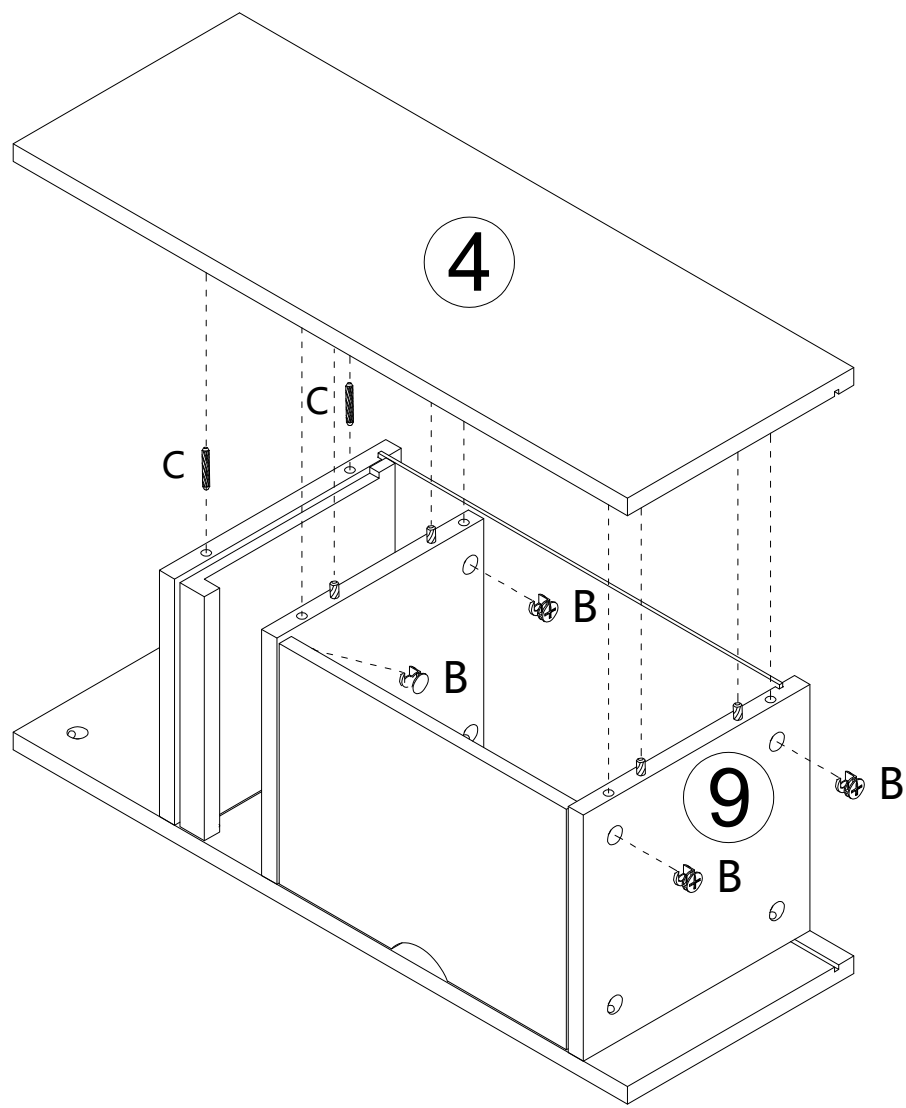

10a.

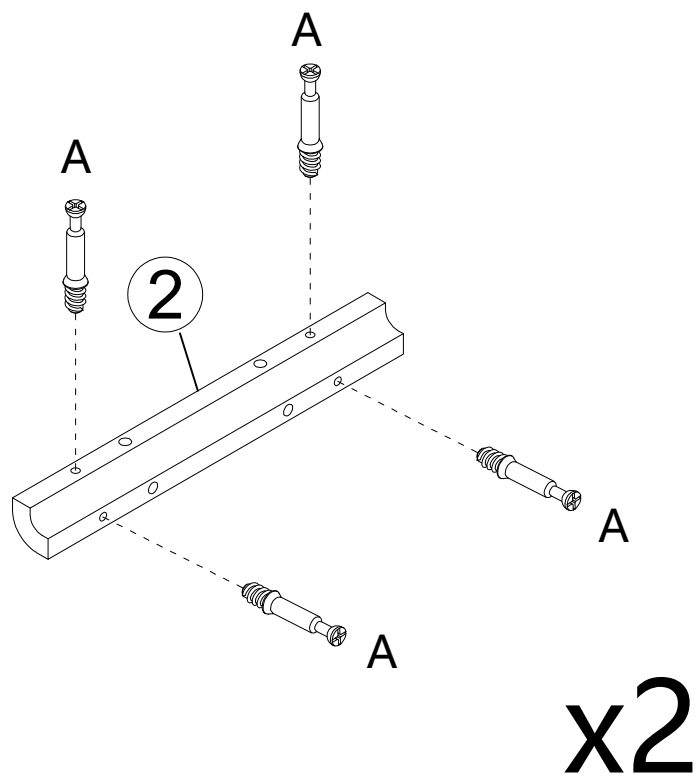

11a.

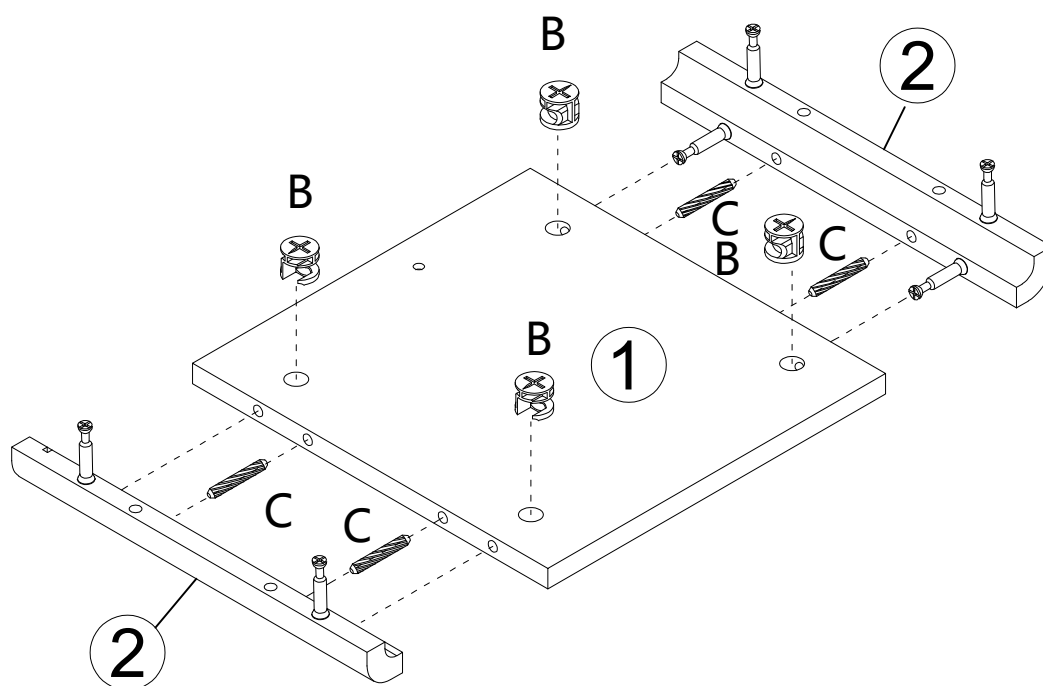

12a.

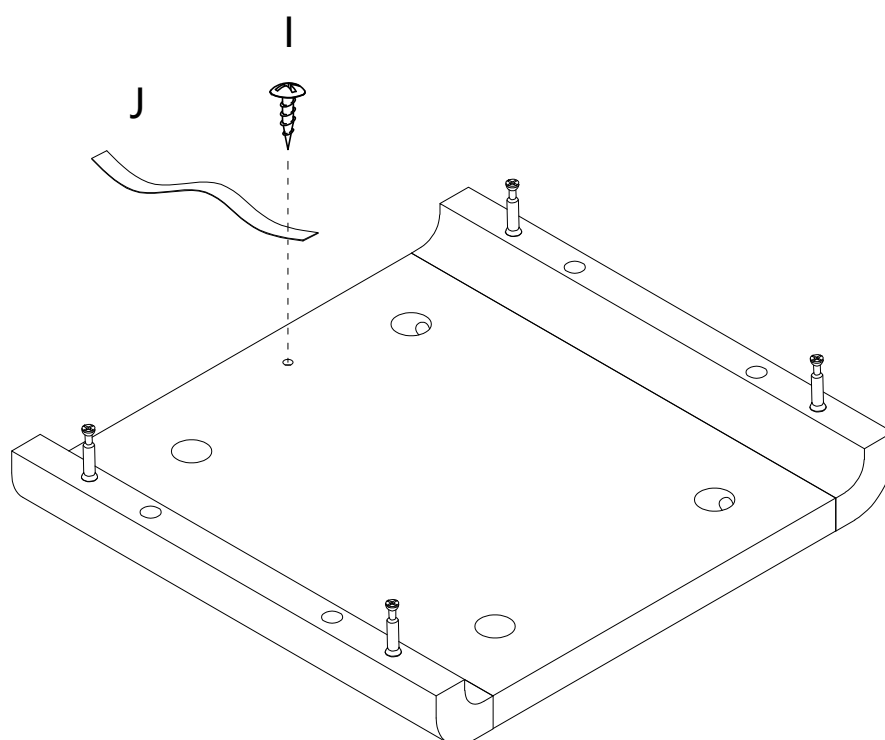



13a.

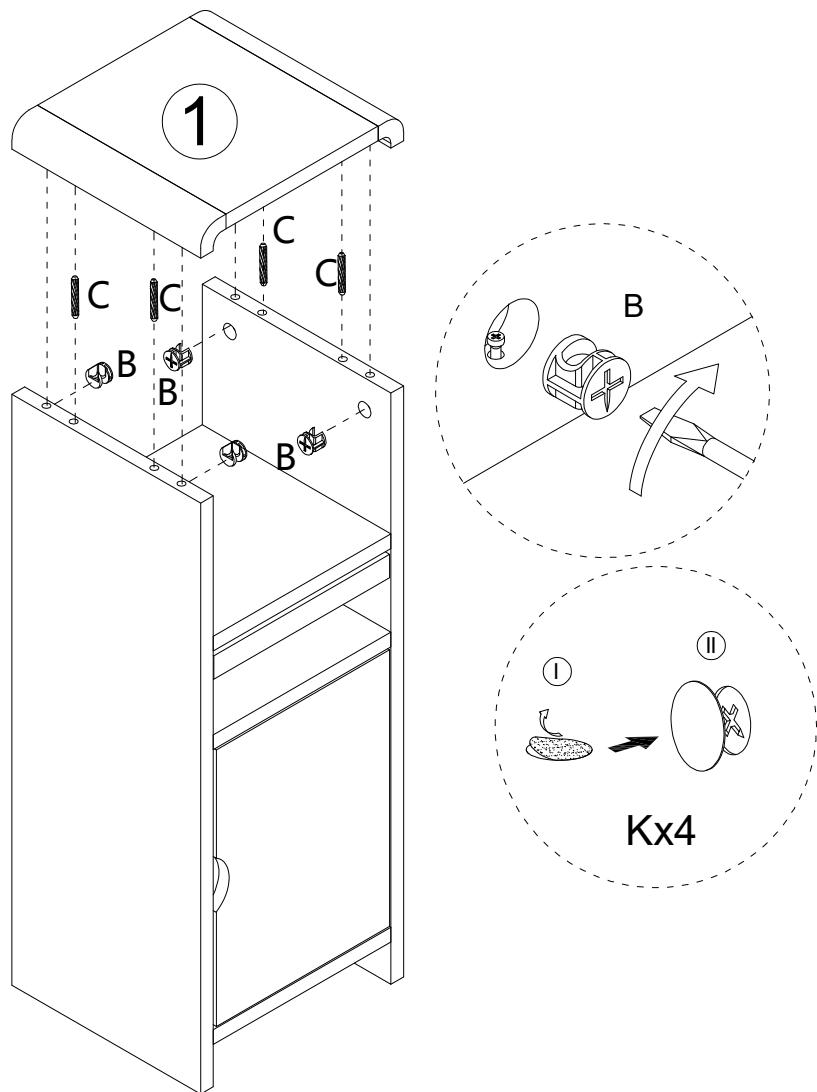

14a.

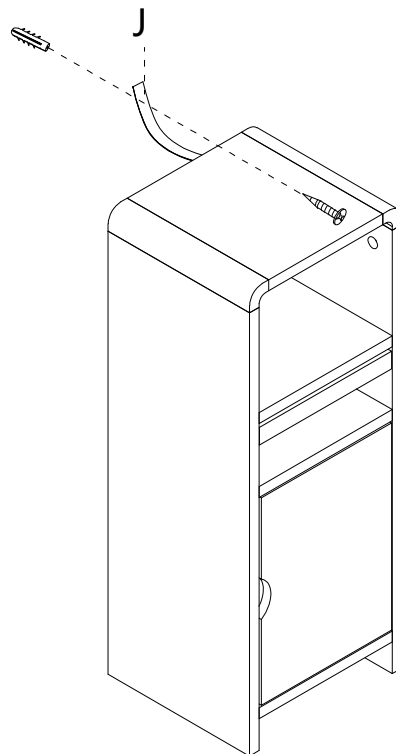

Fitting J should be used to secure your ST CAB HALE to the wall. Screws and fittings for wall are not supplied as different wall constructions require fittings that are suitable for your wall type. If you are unsure for the correct type of fitting for your wall, please contact your local specialised hardware store for information on suitable fitting.

## 1b. door opening left

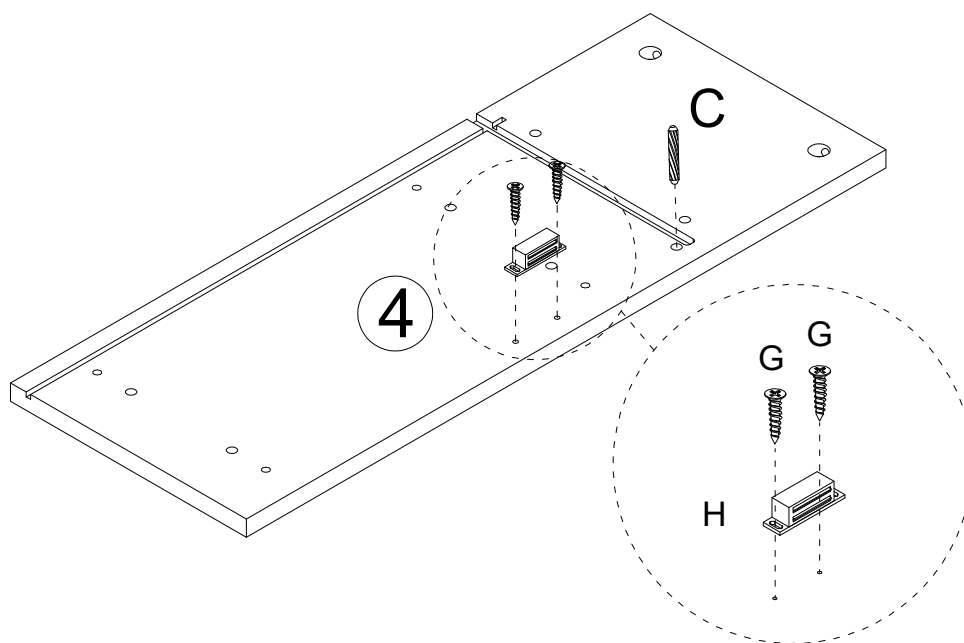

## 2b.

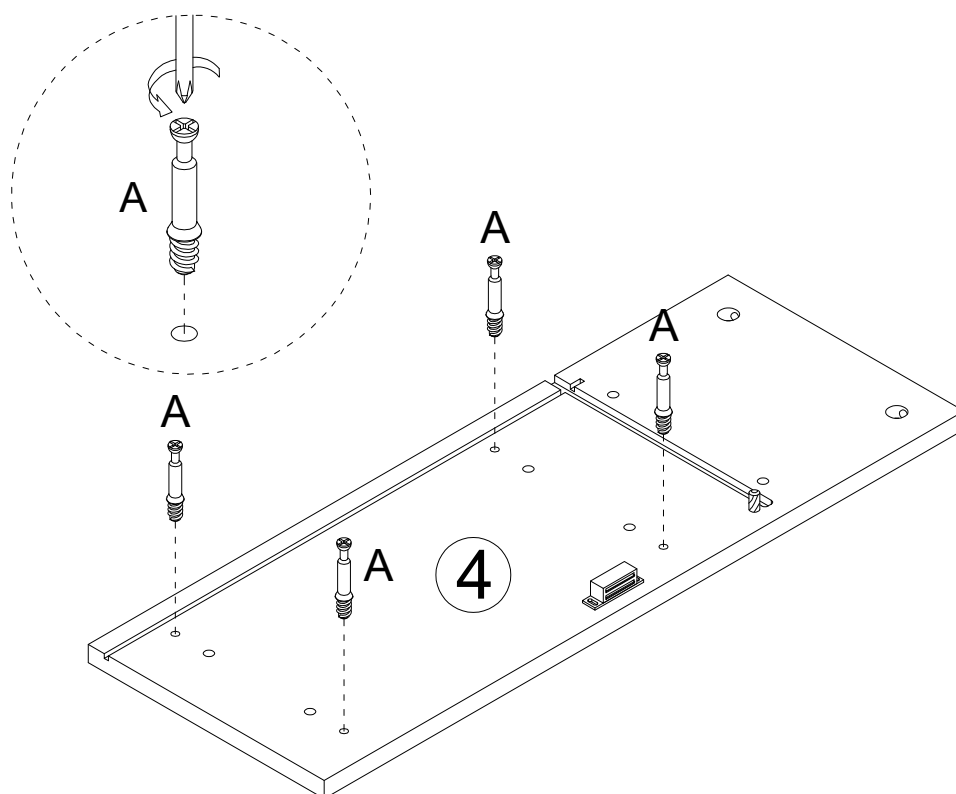

3b.

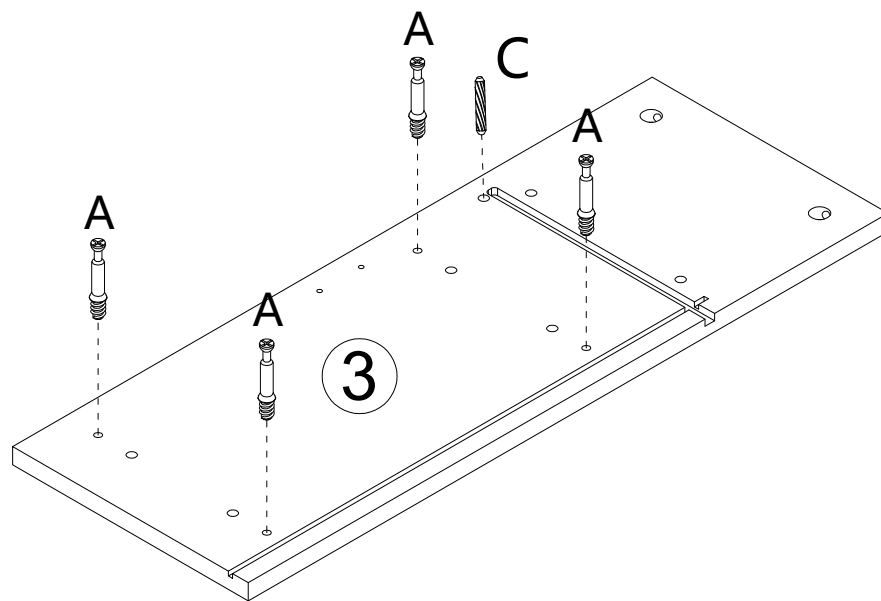

4b.

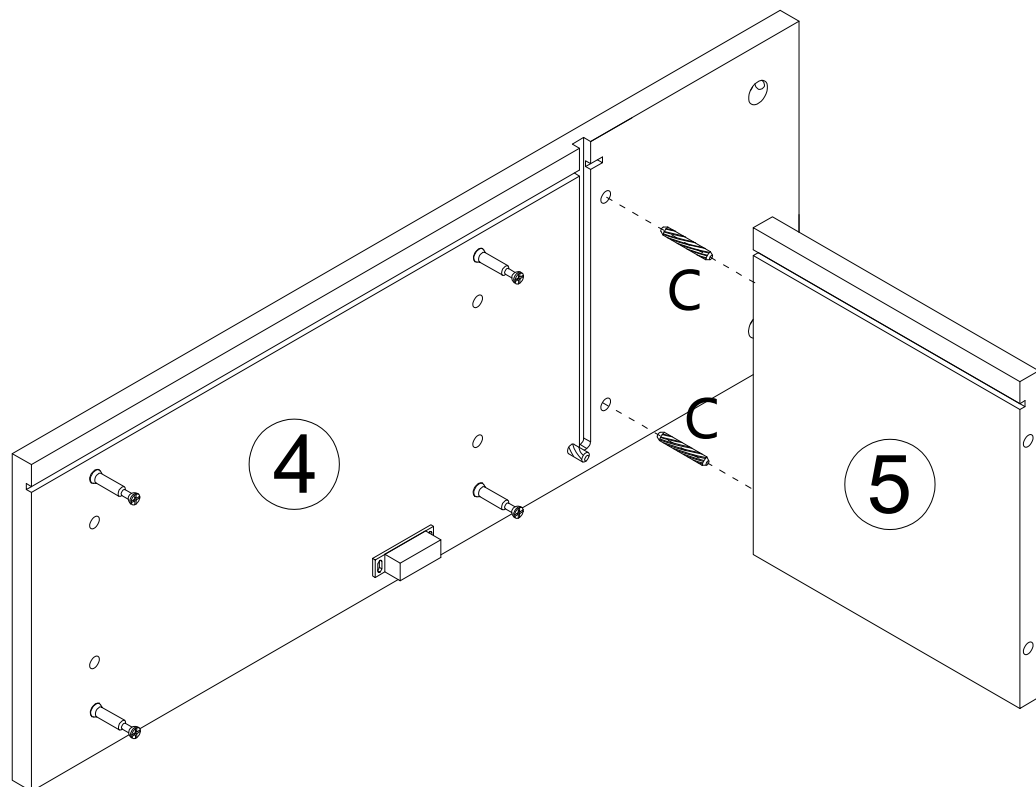

5b.

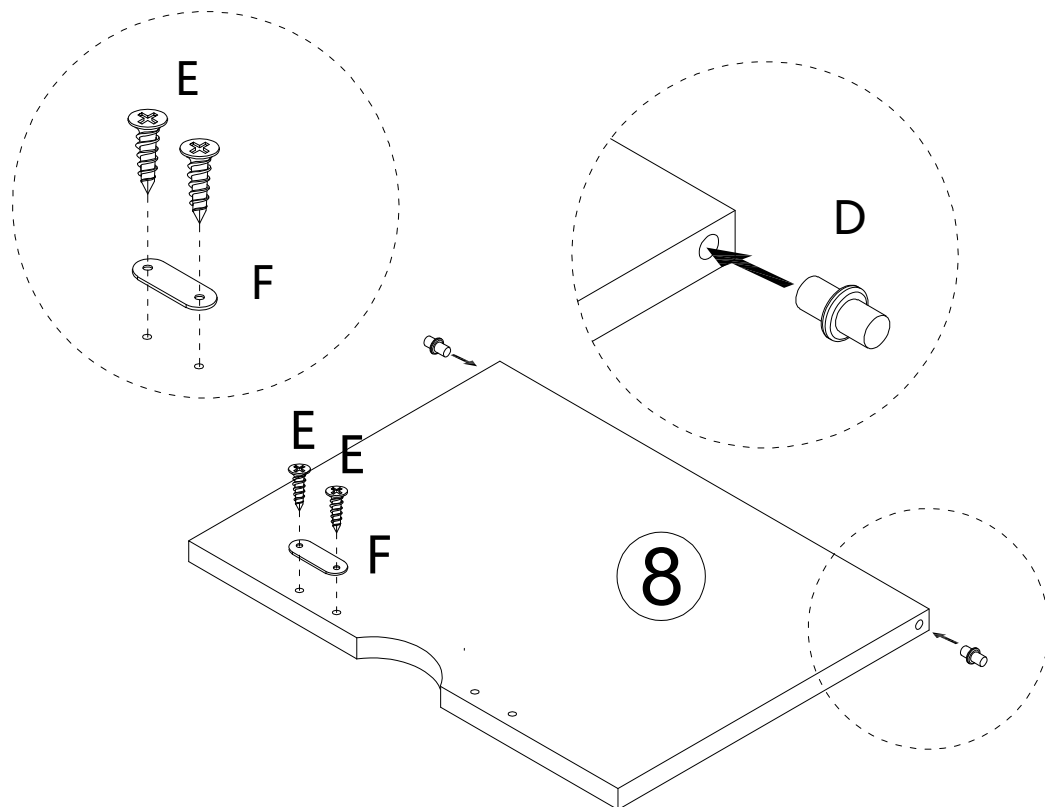

6b.

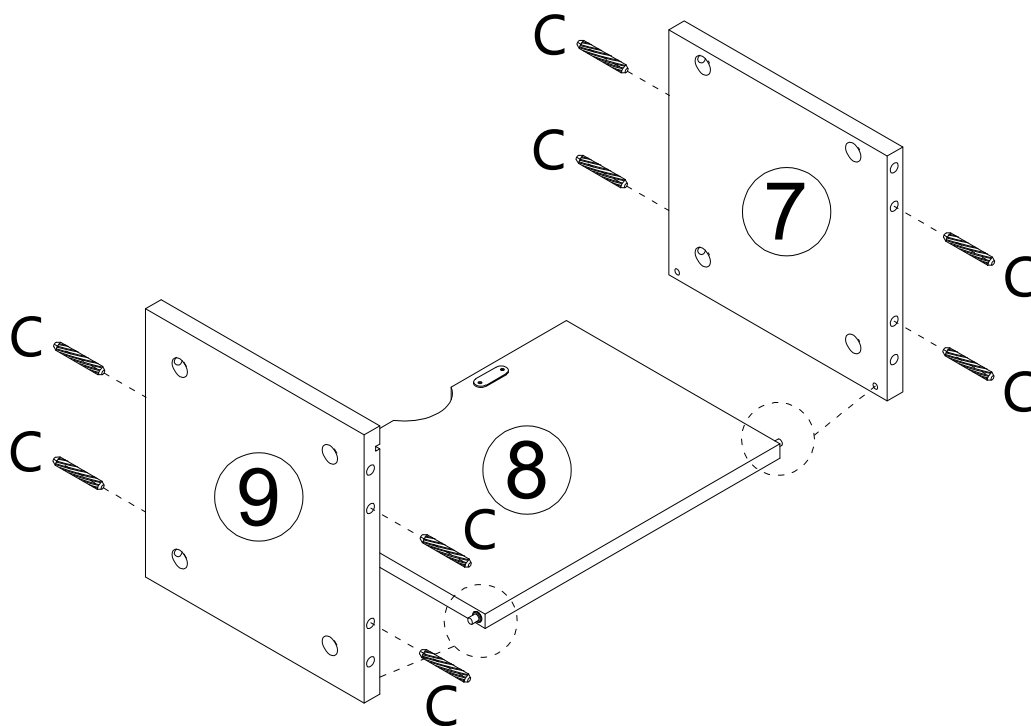

7b.

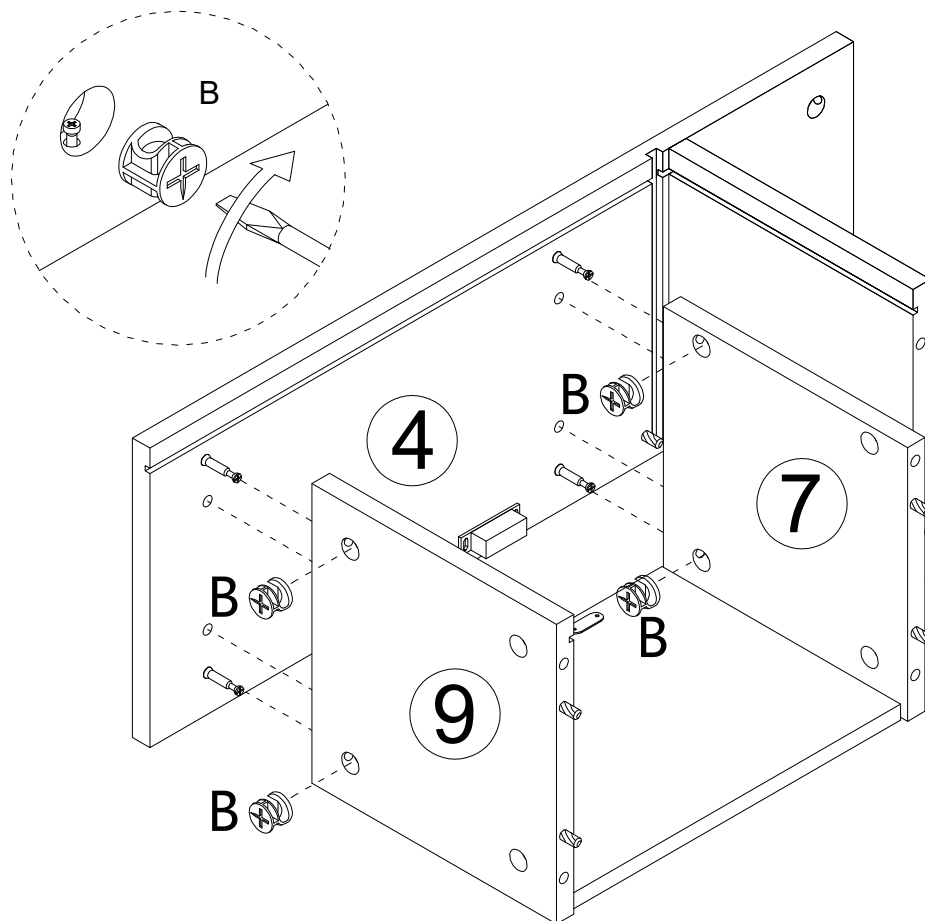

8b.

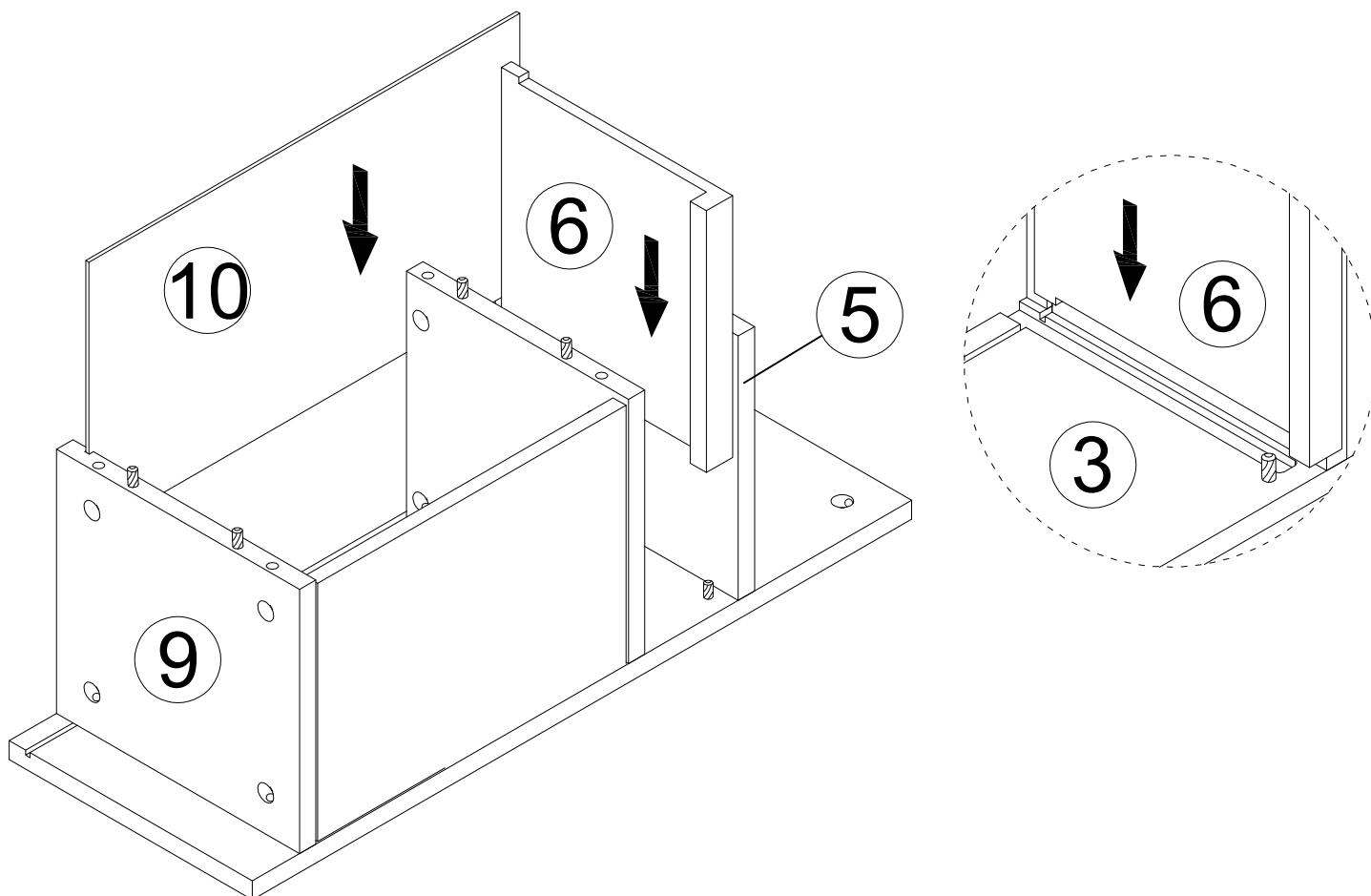

9b.

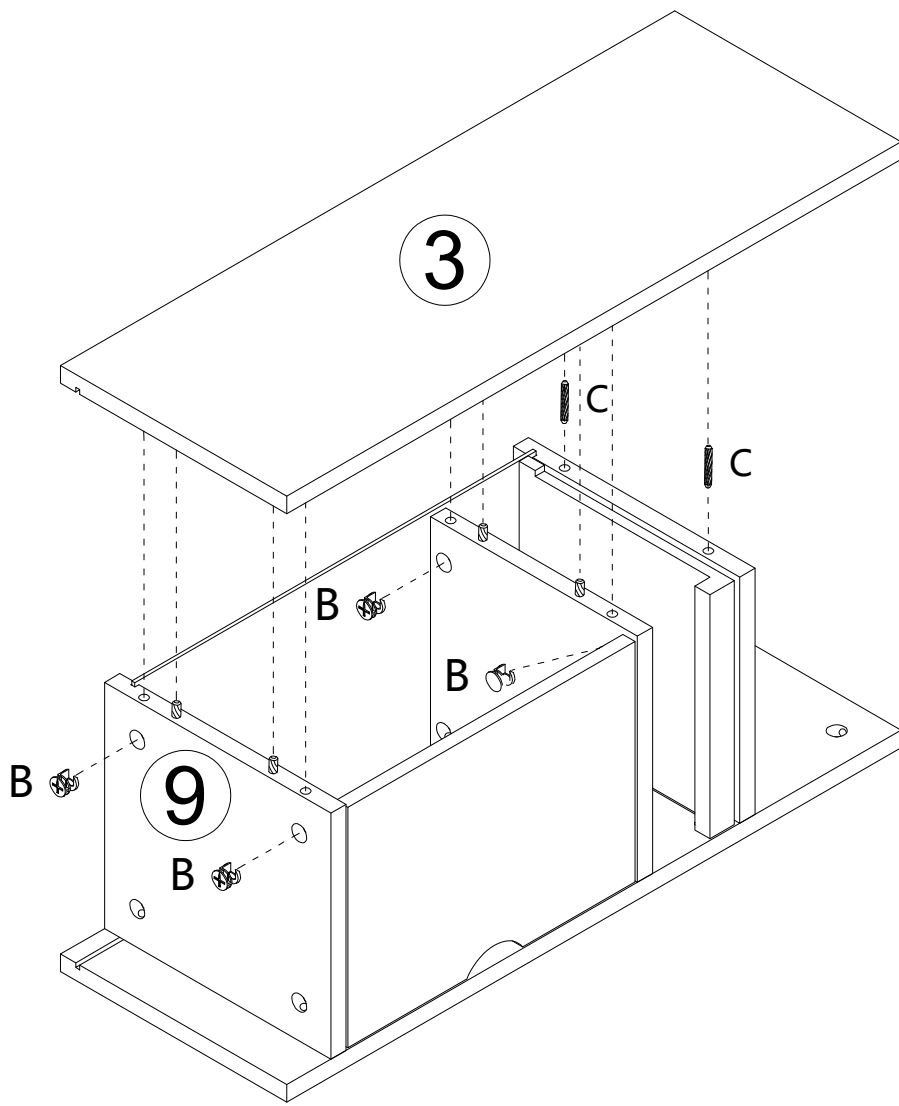

10b.

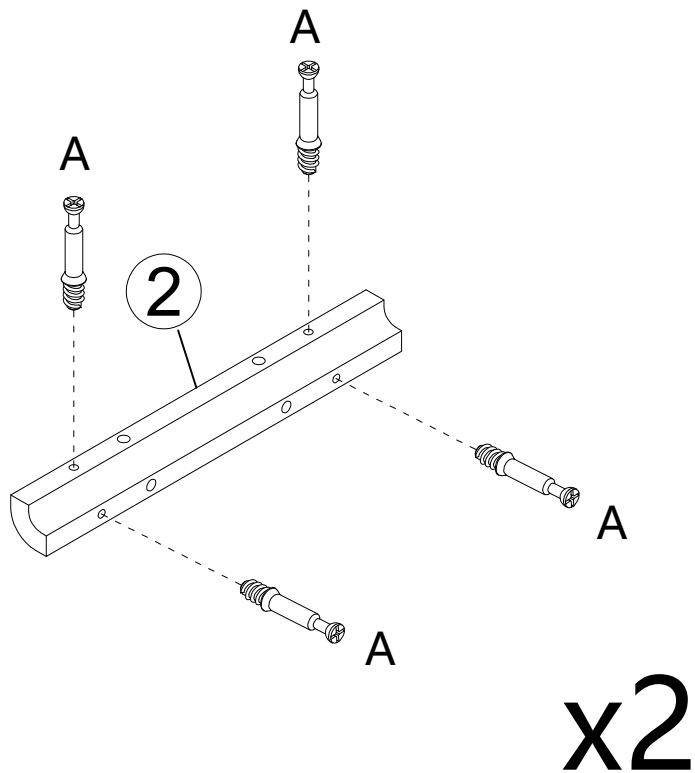

11b.

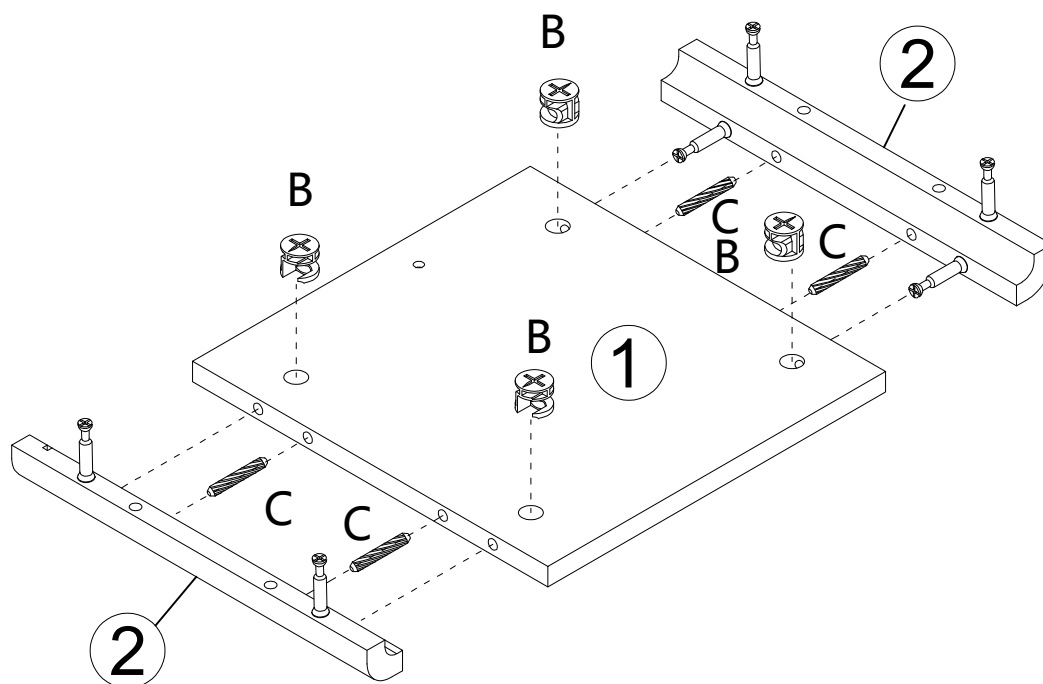

12b.

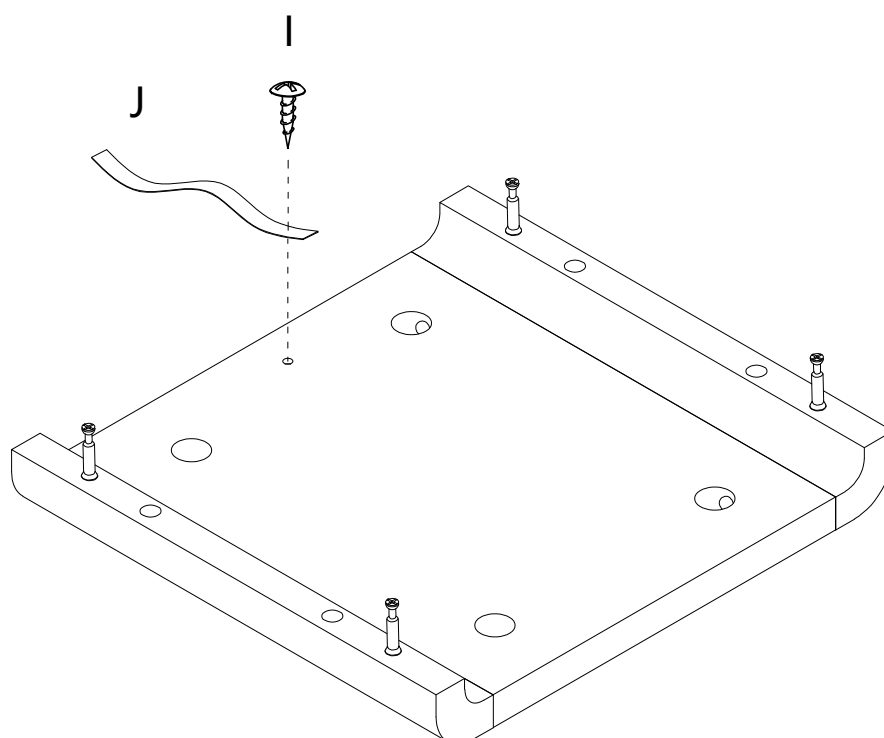

13b.

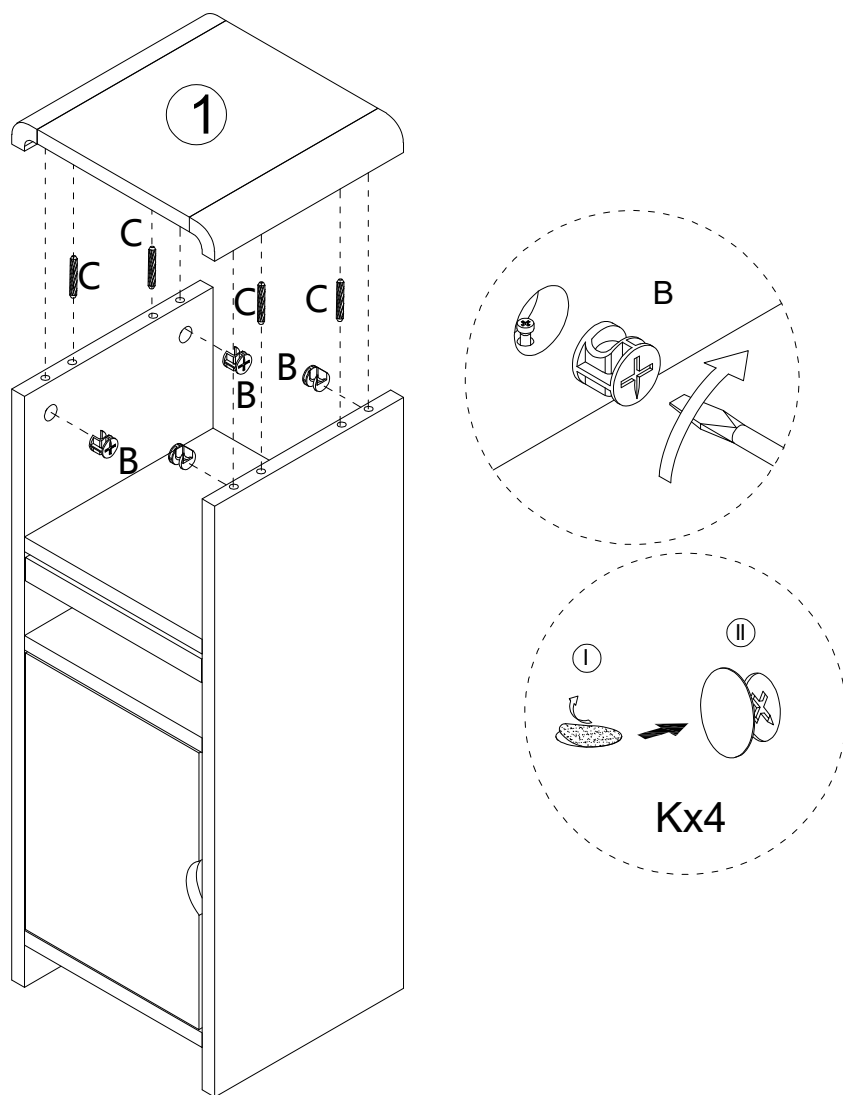

14b.

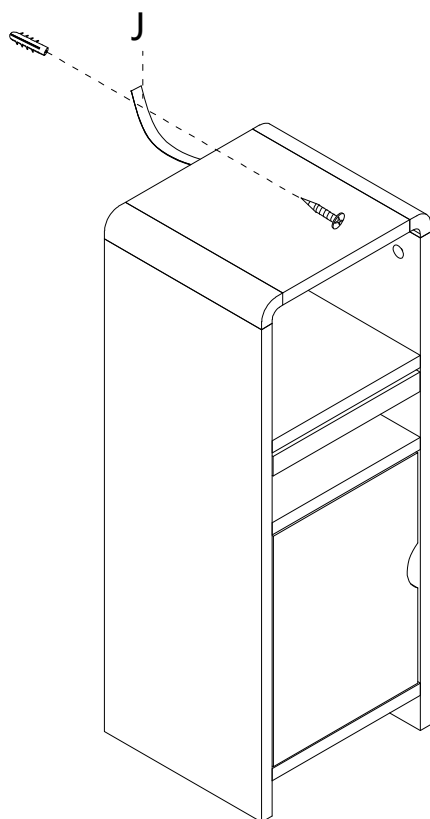

Fitting J should be used to secure your ST CAB HALE to the wall. Screws and fittings for wall are not supplied as different wall constructions require fittings that are suitable for your wall type. If you are unsure for the correct type of fitting for your wall, please contact your local specialised hardware store for information on suitable fitting.